

ALL WARNING, SCENE, AND TAIL LIGHTS TO HAVE CHROME BEZELS.
ALL COMPARTMENT/ENTRY DOORS TO HAVE POWER LOCKS
WIRE TO OEM

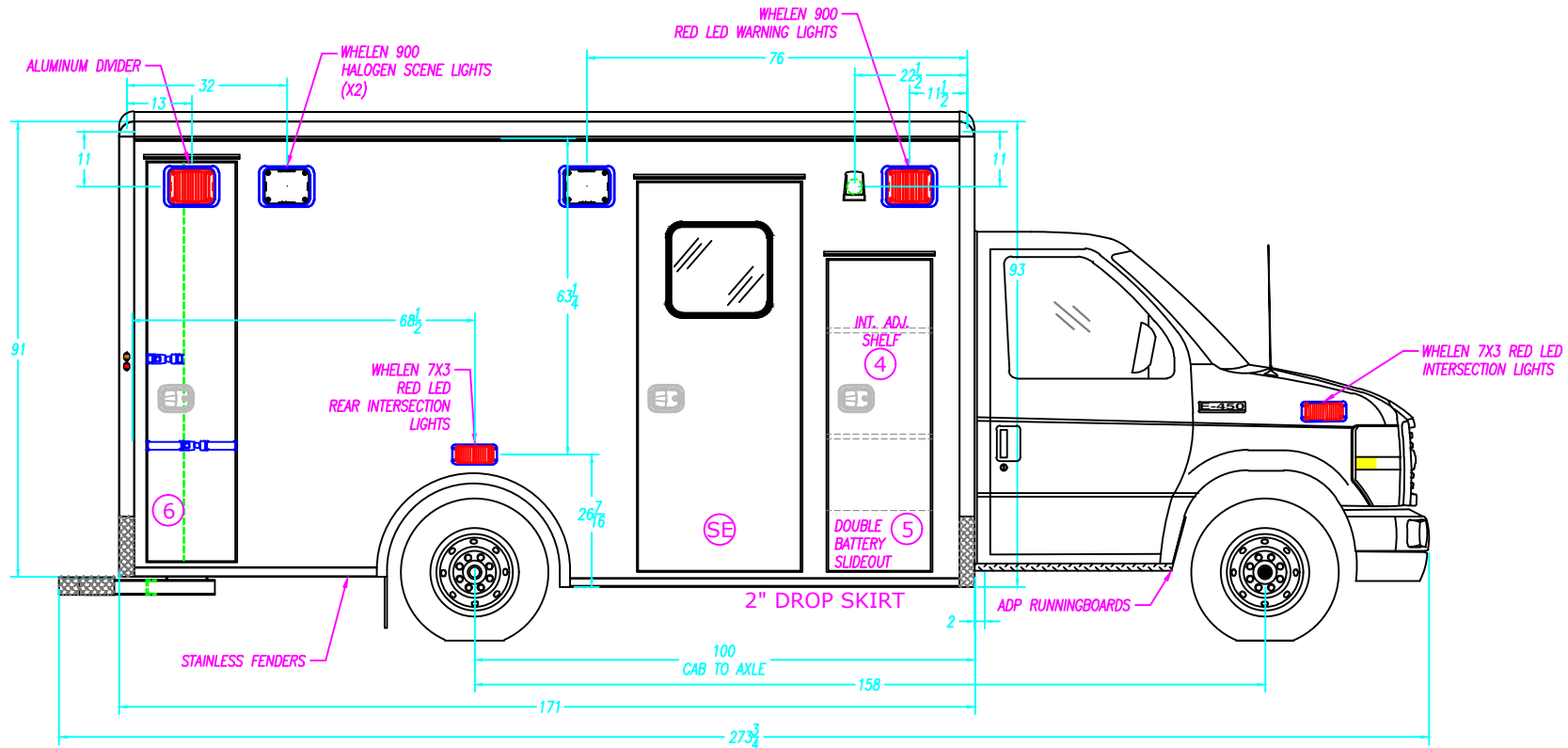

COMPARTMENT SIZES		NOTE: THE DIMENSIONS BELOW ARE INSIDE TUB DIMENSIONS		
NO.	COMPARTMENT TYPE	WIDTH	HEIGHT	DEPTH
4	ALS COMPARTMENT	---	---	---
5	BATTERY COMPARTMENT	20 1/2"	18 1/2"	22 3/8"
6	BACK BOARD COMPARTMENT	20"	79 1/2"	21 1/2"
-	-	-	-	-

COMPARTMENT & ENTRY DOORS			
NO.	DOOR NUMBER	NO.	LINER NUMBER
4-5	-	4-5	-
6	-	6	-
SE	-	SE	-

COMPARTMENT TUBS			
NO.	PART NUMBER	NO.	PART NUMBER
5	-	-	---
6	-	-	---
ENT.	-	-	---

COMPARTMENT / ENTRY DOOR SIZES			
NO.	COMPARTMENT / ENTRY DOOR TYPE	WIDTH	HEIGHT
4	ALS DOOR	20 1/2"	64 1/8"
5	BATTERY STORAGE DOOR	---	---
SE	SIDE ENTRY DOOR	32 1/2"	77 3/8"
6	BACK BOARD STORAGE DOOR	17 1/2"	79 3/8"
-	-	-	-

M2 171" TYPE III
FORD E-450 158" WHEELBASE

DESCRIPTION: CURB SIDE EXTERIOR

DRAWN BY: SDG DATE CREATED: 10/4/19 SCALE: 5/16"=1'

REVISED BY: DATE REVISED: REVISION:

Note: Drawings are for reference only, measurements may vary from actual product.



"THE NEXT GENERATION OF INNOVATION AND DESIGN"
WWW.GEN-TAMBULANCE.COM

110 EAST WINDSOR Dr. ELKHART, IN 46514
PH: 574-226-0404

ALL WARNING, SCENE, AND TAIL LIGHTS TO HAVE CHROME BEZELS.
ALL COMPARTMENT/ENTRY DOORS TO HAVE POWER LOCKS
WIRE TO OEM

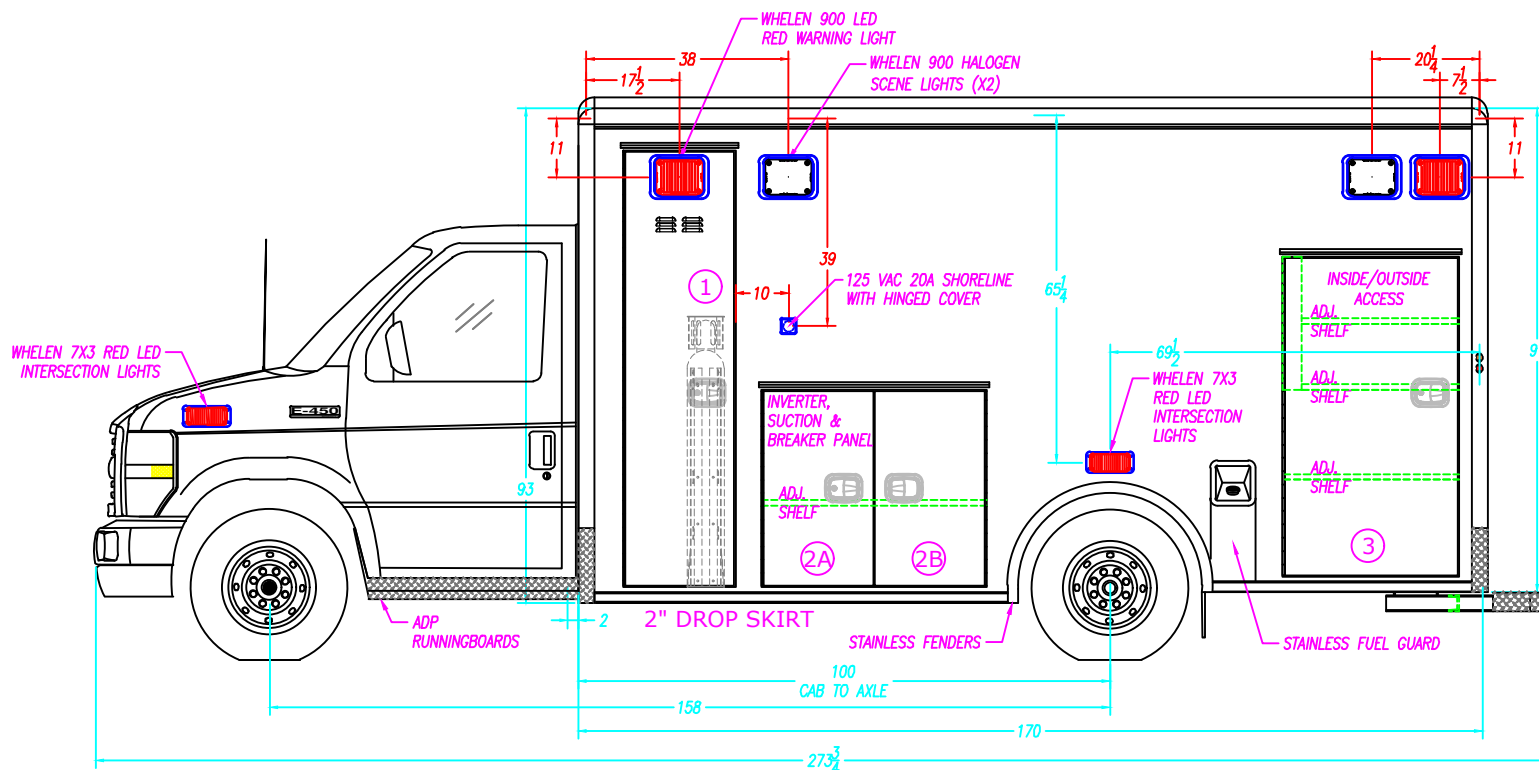

COMPARTMENT SIZES		NOTE: THE DIMENSIONS BELOW ARE INSIDE TUB DIMENSIONS		
NO.	COMPARTMENT TYPE	WIDTH	HEIGHT	DEPTH
1A	ELEC COMPARTMENT	20 1/2"	23 1/2"	18"
1B	O2 COMPARTMENT	20 1/2"	59 1/4"	18"
2	MID STORAGE COMPARTMENT	41 3/4"	38 1/2"	18"
3	REAR STORAGE COMPARTMENT	34"	59 1/2"	18 1/2"

COMPARTMENT & ENTRY DOORS			
NO.	DOOR NUMBER	NO.	LINER NUMBER
1	-	1	-
2A	-	2A	-
2B	-	2B	-
3	-	3	-

COMPARTMENT TUBS			
NO.	PART NUMBER	NO.	PARTNUMBER
1	-	-	---
2	-	-	---
3	-	-	---

COMPARTMENT / ENTRY DOOR SIZES			
NO.	COMPARTMENT / ENTRY DOOR TYPE	WIDTH	HEIGHT
1A	ELEC STORAGE DOOR	20 1/2"	23 5/8"
1B	O2 STORAGE DOOR	20 1/2"	59 5/8"
2A	MID STORAGE DOOR-A	20 1/16"	38 3/16"
2B	MID STORAGE DOOR-B	20 1/16"	38 9/16"
3	REAR STORAGE DOOR	30 1/16"	59 9/16"

M2 171" TYPE III
FORD E-450 158" WHEELBASE

DESCRIPTION: STREET SIDE EXTERIOR

DRAWN BY: SDG DATE CREATED: 10/4/19 SCALE: 5/16"=1'

REVISED BY: DATE REVISED: REVISION:

Note: Drawings are for reference only, measurements may vary from actual product.



"THE NEXT GENERATION OF INNOVATION AND DESIGN"

WWW.GEN-TAMBULANCE.COM

110 EAST WINDSOR Dr. ELKHART, IN 46514
PH: 574-226-0404

ALL WARNING, SCENE, AND TAIL LIGHTS TO HAVE CHROME BEZELS.
ALL COMPARTMENT/ENTRY DOORS TO HAVE POWER LOCKS
WIRE TO OEM

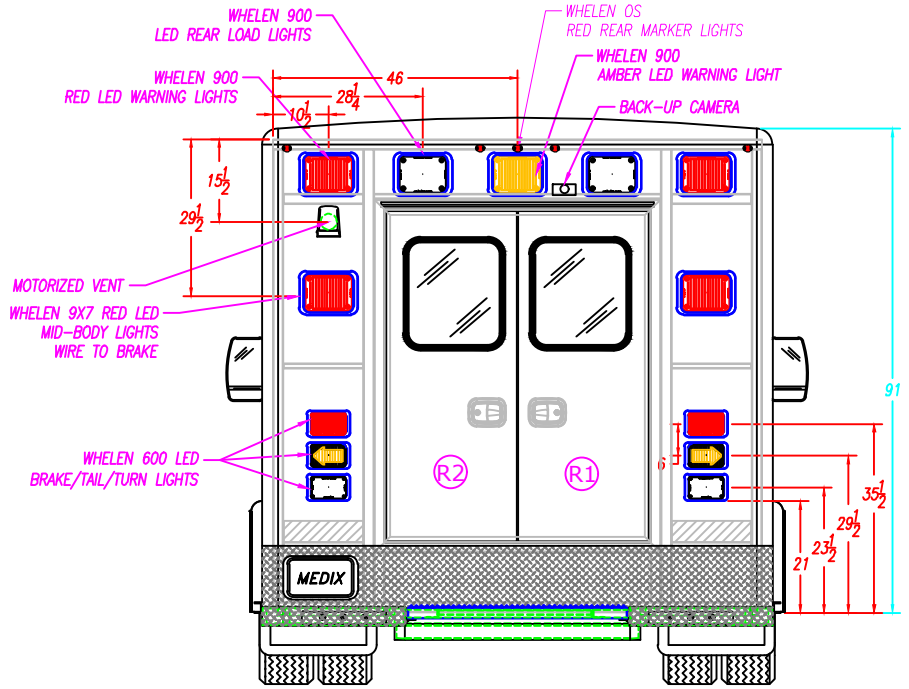
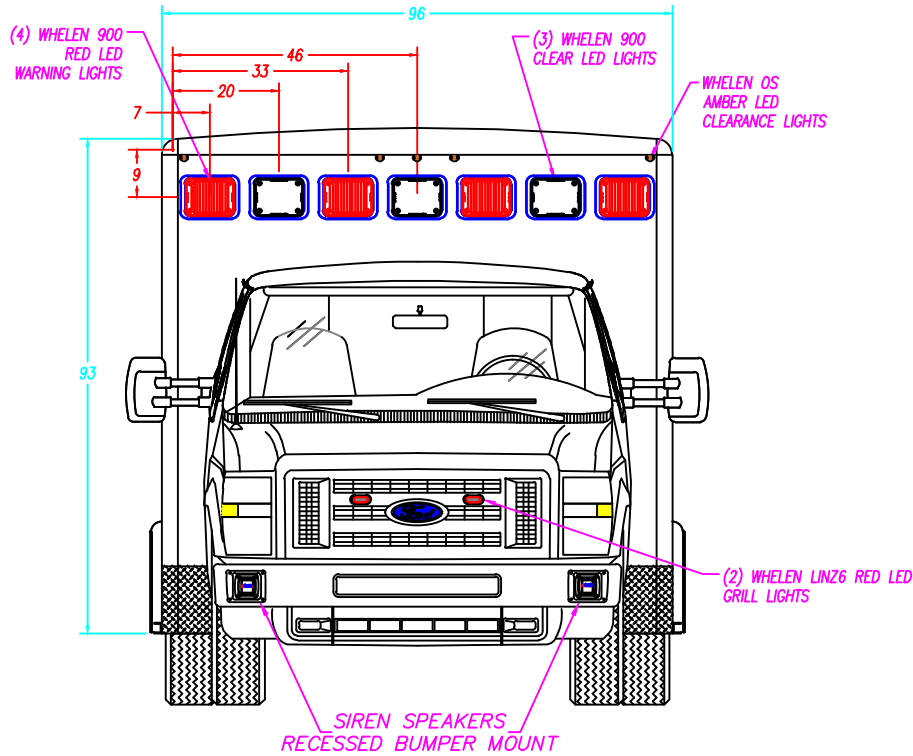

REAR ENTRY DOOR SIZES

NO.	WIDTH	HEIGHT	PART NUMBER
R1	24 5/16"	62"	33-105853
R2	24 5/16"	62"	33-105855

M2 171" TYPE III FORD E-450 158" WHEELBASE		
DESCRIPTION: FRONT & REAR EXTERIOR		
DRAWN BY: SDG	DATE CREATED: 10/4/19	SCALE: 5/16"=1'
REVISED BY:	DATE REVISED:	REVISION:
Note: Drawings are for reference only, measurements may vary from actual product.		



"THE NEXT GENERATION OF INNOVATION AND DESIGN"
WWW.GEN-TAMBULANCE.COM

110 EAST WINDSOR Dr. ELKHART, IN 46514
PH: 574-226-0404

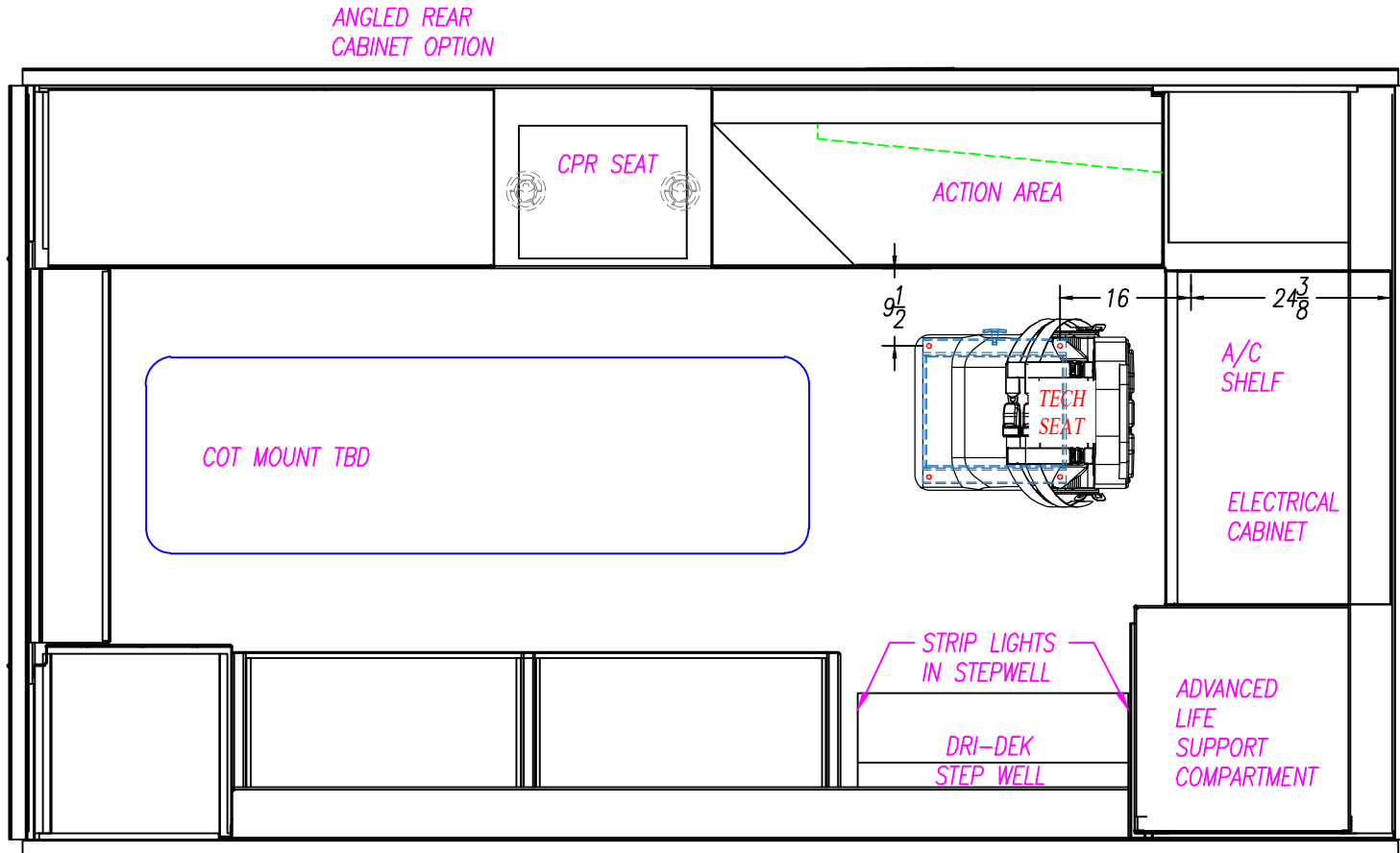

M2 171" TYPE III
FORD E-450 158" WHEELBASE

DESCRIPTION: PATIENT AREA PLAN

DRAWN BY: SDG	DATE CREATED: 10/4/19	SCALE: 1/2"=1'
REVISED BY:	DATE REVISED:	REVISION:

Note: Drawings are for reference only, measurements may vary from actual product.



"THE NEXT GENERATION OF
INNOVATION AND DESIGN"

WWW.GEN-TAMBULANCE.COM

110 EAST WINDSOR Dr. ELKHART, IN 46514
PH: 574-226-0404

TECNIQ CABINET STRIP LIGHTING
CORIAN COUNTERTOPS IN 1ST & 2ND ACTION AREA.

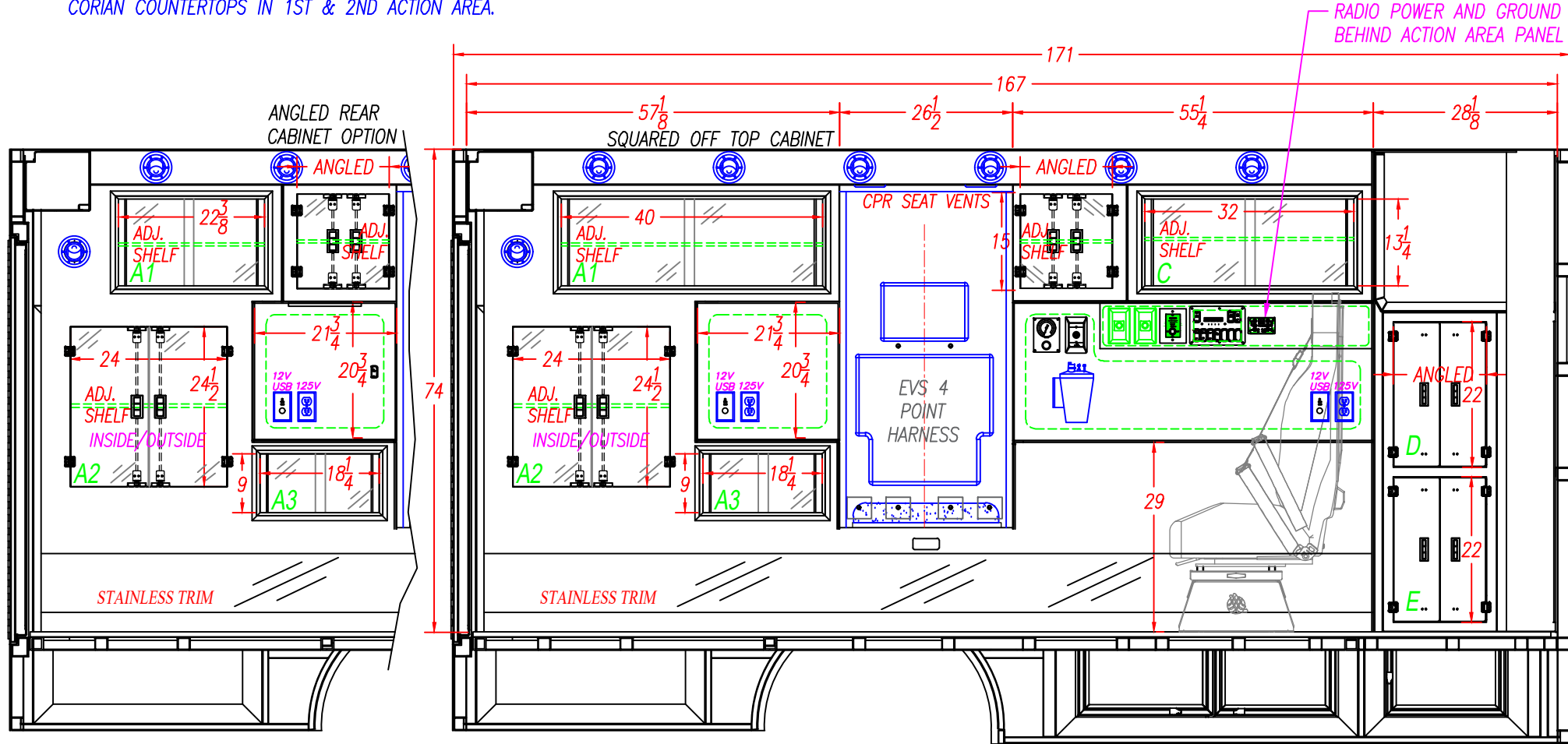

INTERIOR CABINET STORAGE				
ITEM	HEIGHT	WIDTH	DEPTH	PART #'S
A1	15 3/4"	21 5/8"	18"	-
A2	23"	25"	8"	-
C	15 1/2"	34"	17"	-
D	23 1/2"	21 3/4"	17 1/4"	-
E	23 1/2"	21 3/4"	17 1/4"	-

M2 171" TYPE III FORD E-450 158" WHEELBASE		
DESCRIPTION: STREET SIDE INTERIOR		
DRAWN BY: SDG	DATE CREATED: 10/4/19	SCALE: 1/2"=1'
REVISED BY:	DATE REVISED:	REVISION:



"THE NEXT GENERATION OF
INNOVATION AND DESIGN"
WWW.GEN-TAMBULANCE.COM

110 EAST WINDSOR Dr. ELKHART, IN 46514
PH: 574-226-0404

Note: Drawings are for reference only, measurements may vary from actual product.

TECNIQ CABINET STRIP LIGHTING

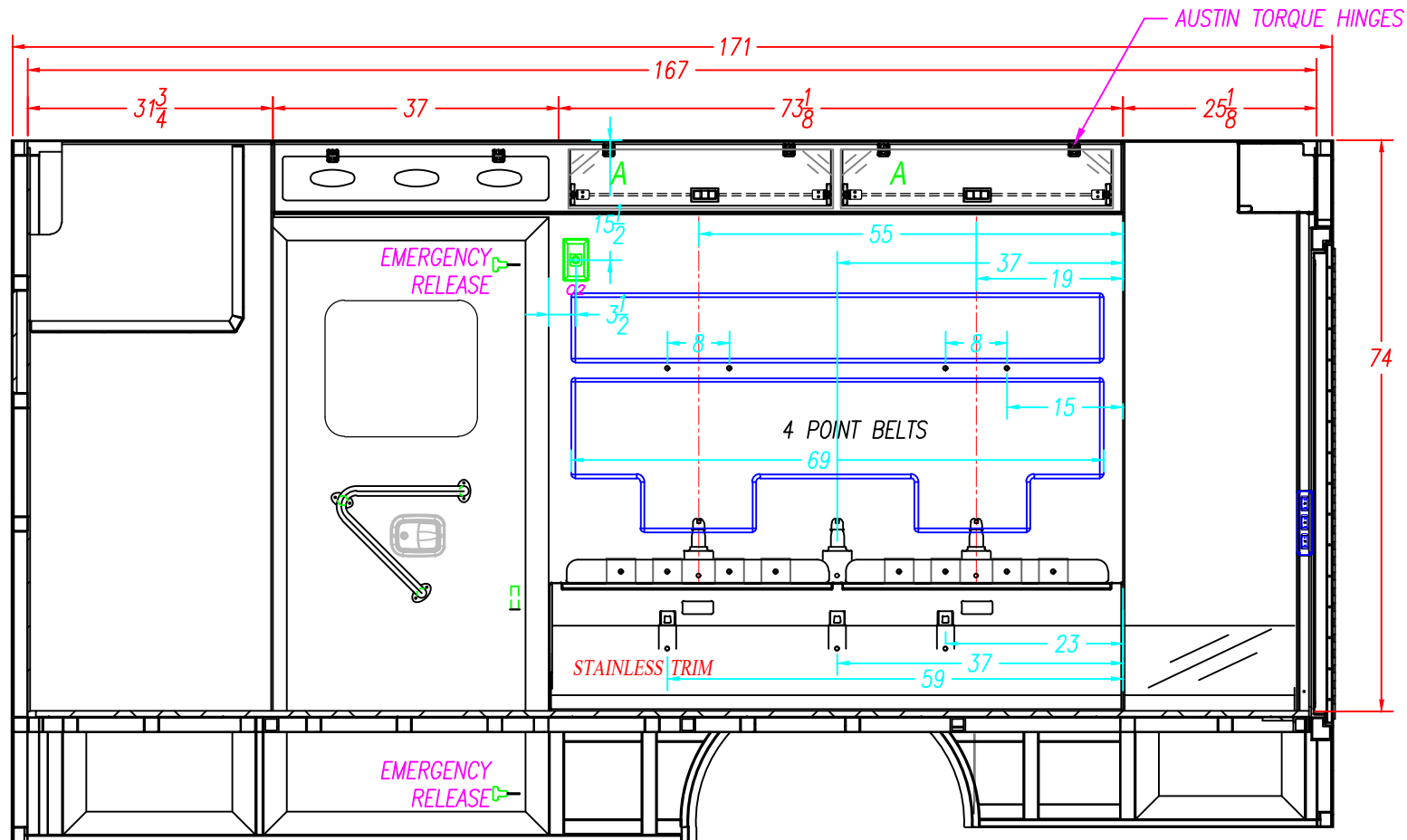

**4" SEATBELT
PLATE LOCATION**

WELD SHOP	33	INCHES	NOTE: THIS DIMENSION IS FROM THE BOTTOM OF THE WALL TO THE BOTTOM OF THE 4" PLATE.
CABINET SHOP	NOTE: THE HOLES FOR THE TOP SEATBELT BOLTS ARE 1 1/4" FROM THE TOP OF THE SQUAD BENCH TO THE CENTER OF THE SEATBELT BOLT. NOTE: THE HOLES FOR THE BOTTOM SEATBELT BOLTS ON THE SQUAD BENCH ARE 9 3/8" FROM THE TOP OF THE FLOOR TO THE CENTER OF THE BOLT.		
NOTE: READ THE DIMENSIONS FROM RIGHT TO LEFT AS VIEWED	THE LOCATION OF THE BOTTOM SEATBELT HOLES ARE FROM THE REAR OF THE SQUAD BENCH TO THE CENTER OF THE 1/2" HOLE	BOTTOM	
	THE LOCATION OF THE TOP SEATBELT HOLES ARE FROM THE REAR WALL TO THE CENTER OF THE 1/2" HOLE	TOP	

INTERIOR CABINET STORAGE				
ITEM	HEIGHT	WIDTH	DEPTH	SPECIAL NOTE
A	6"	26 1/4"	7"	
B				
C				
D				
E				
F				

M2 171" TYPE III FORD E-450 158" WHEELBASE		
DESCRIPTION: CURB SIDE INTERIOR		
DRAWN BY: SDG	DATE CREATED: 10/4/19	SCALE: 1/2"=1'
REVISED BY:	DATE REVISED:	REVISION:
Note: Drawings are for reference only, measurements may vary from actual product.		



"THE NEXT GENERATION OF
INNOVATION AND DESIGN"

WWW.GEN-TAMBULANCE.COM

110 EAST WINDSOR Dr. ELKHART, IN 46514
PH: 574-226-0404

TECNIQ CABINET STRIP LIGHTING

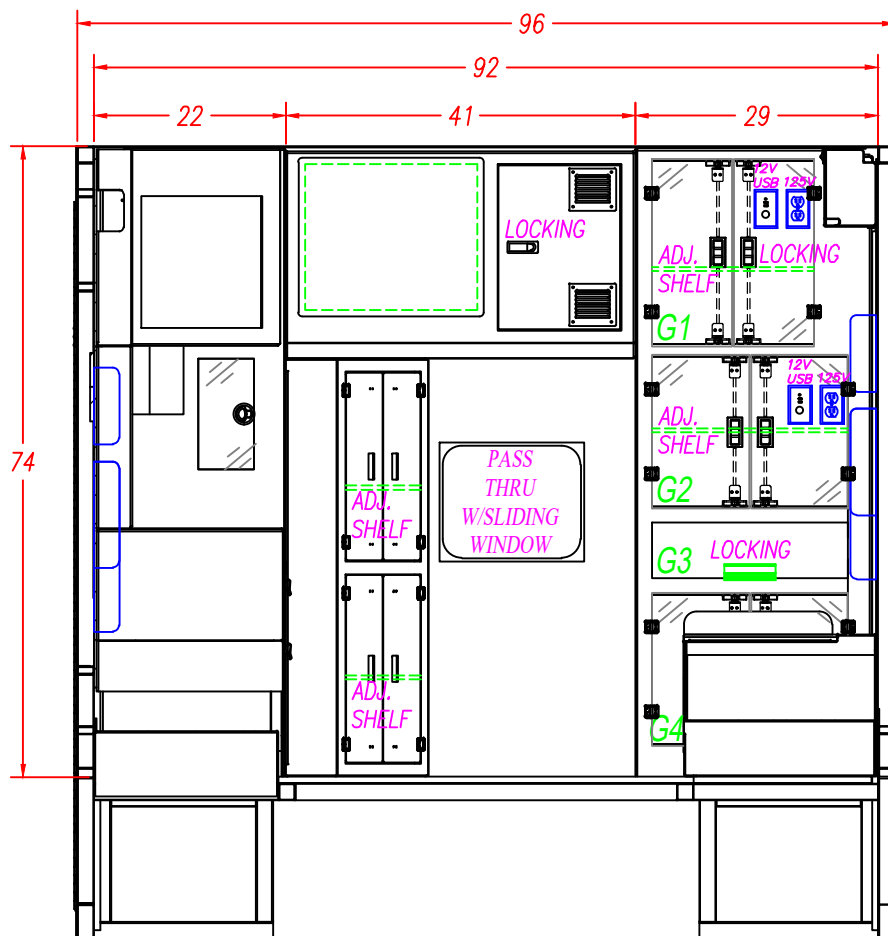

INTERIOR CABINET STORAGE					M2 171" TYPE III FORD E-450 158" WHEELBASE		
ITEM	HEIGHT	WIDTH	DEPTH	PART #'S	DESCRIPTION: FRONT ELEVATION		
G1	21 1/2"	18"	27"	-	DRAWN BY:	DATE CREATED:	SCALE:
G2	18"	23"	27"	-	SDG	10/4/19	1/2"=1'
G3	6 1/2"	23"	18"	-	REVISED BY:	DATE REVISED:	REVISION:
G4	18"	23"	27"	-			
					Note: Drawings are for reference only, measurements may vary from actual product.		



"THE NEXT GENERATION OF
INNOVATION AND DESIGN"

WWW.GEN-TAMBULANCE.COM

110 EAST WINDSOR Dr. ELKHART, IN 46514
PH: 574-226-0404

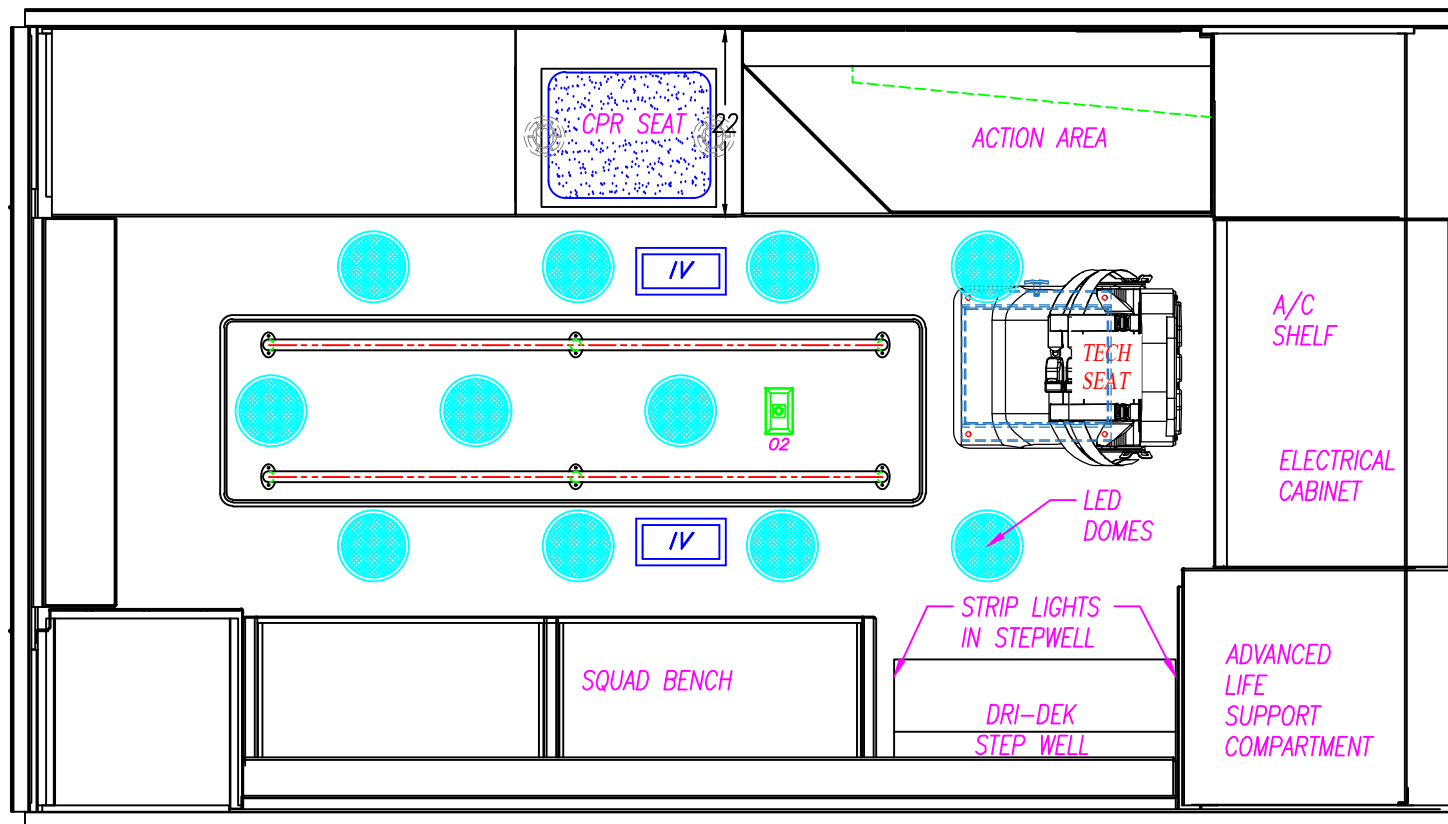

M2 171" TYPE III FORD E-450 158" WHEELBASE		
DESCRIPTION: CEILING LAYOUT		
DRAWN BY: SDG	DATE CREATED: 10/4/19	SCALE: 1/2"=1'
REVISED BY:	DATE REVISED:	REVISION:
Note: Drawings are for reference only, measurements may vary from actual product.		



"THE NEXT GENERATION OF
INNOVATION AND DESIGN"

WWW.GEN-TAMBULANCE.COM

110 EAST WINDSOR Dr. ELKHART, IN 46514
PH: 574-226-0404

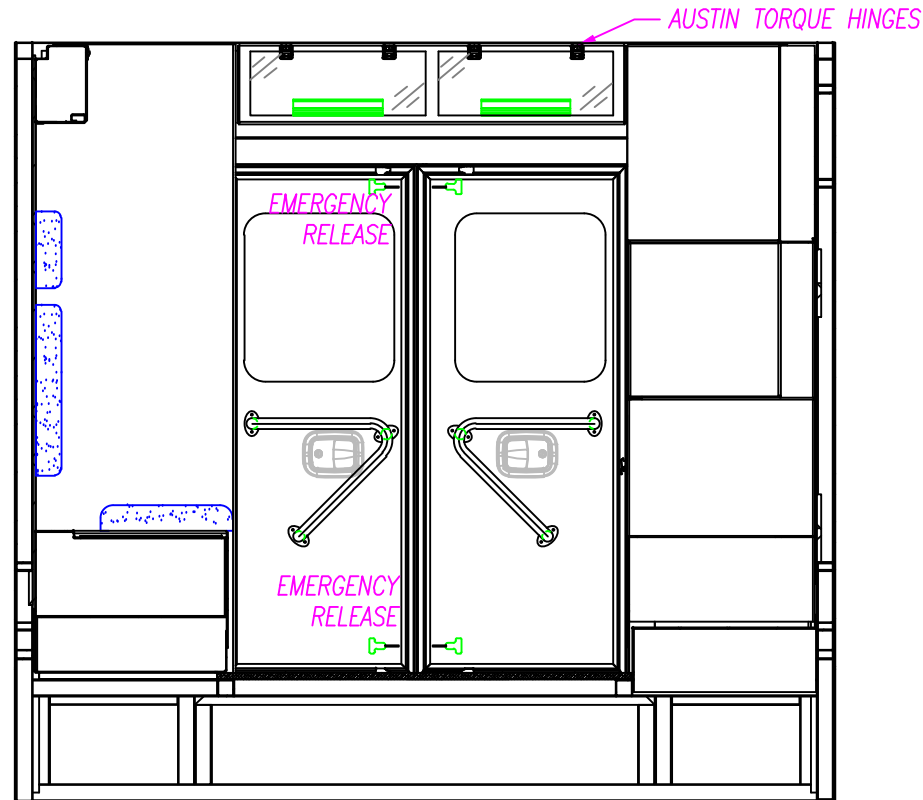

INTERIOR CABINET STORAGE

ITEM	HEIGHT	WIDTH	DEPTH	SPECIAL NOTE
A	9"	44"	9"	
B				
C				
D				
E				
F				

M2 171" TYPE III FORD E-450 158" WHEELBASE		
DESCRIPTION: REAR ELEVATION		
DRAWN BY: SDG	DATE CREATED: 10/4/19	SCALE: 1/2"=1'
REVISED BY:	DATE REVISED:	REVISION:
Note: Drawings are for reference only, measurements may vary from actual product.		



"THE NEXT GENERATION OF
INNOVATION AND DESIGN"

WWW.GEN-TAMBULANCE.COM

110 EAST WINDSOR Dr. ELKHART, IN 46514
PH: 574-226-0404