

ALL WARNING, SCENE, AND TAIL LIGHTS TO HAVE CHROME BEZELS.

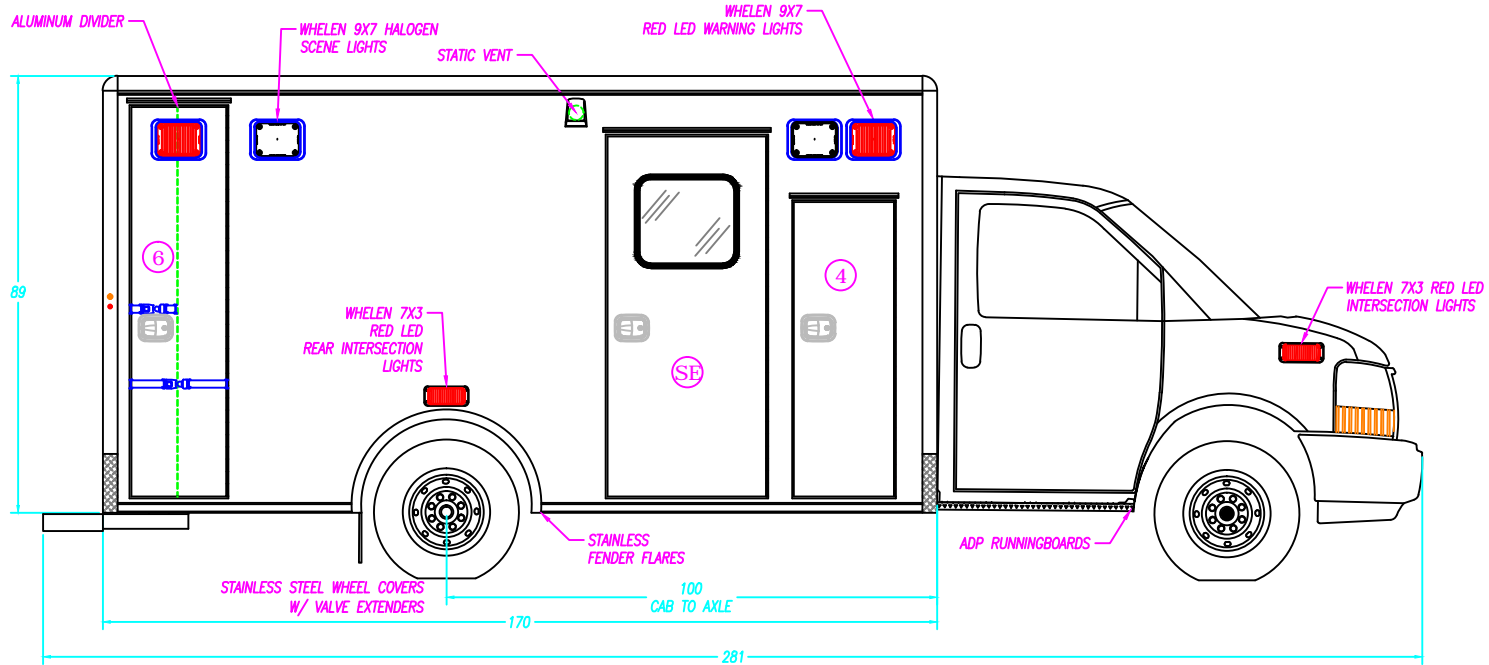

COMPARTMENT SIZES					NOTE: THE DIMENSIONS BELOW ARE INSIDE TUB DIMENSIONS				COMPARTMENT & ENTRY DOORS				COMPARTMENT TUBS			
NO.	COMPARTMENT TYPE	WIDTH	HEIGHT	DEPTH	NO.	PART NUMBER	NO.	PART NUMBER	NO.	PART NUMBER	NO.	PART NUMBER	NO.	PART NUMBER		
4	ALS COMPARTMENT	---	---	---	4	33-100667	6	33-100669	5	33-100692	-	---	6	33-103025		
5	BATTERY COMPARTMENT	20 1/2"	14 1/2"	23 1/8"	5	---	7	33-100670	6	---	-	---	7	33-100694		
6	BACK BOARD COMPARTMENT	20"	79 1/2"	22"	SE	33-100674	-	---	M2 170" TYPE III CHEVY G-4500 159" WHEELBASE CURB SIDE EXTERIOR							
7	SPARE STORAGE COMPARTMENT	15 1/2"	25 1/2"	17 3/8"												
COMPARTMENT / ENTRY DOOR SIZES					M2 170" TYPE III CHEVY G-4500 159" WHEELBASE CURB SIDE EXTERIOR											
NO.	COMPARTMENT / ENTRY DOOR TYPE	WIDTH	HEIGHT													
4	ALS DOOR	20 3/8"	60"													
5	BATTERY STORAGE DOOR	---	---													
SE	SIDE ENTRY DOOR	32 3/8"	73 3/8"													
6	BACK BOARD STORAGE DOOR	19 3/8"	79 3/8"													
7	SPARE STORAGE COMPARTMENT DOOR	15 3/8"	25 3/8"													
					DRAWN BY: D. EDWARDS REVISED BY: -			DATE CREATED: 8/28/15 DATE REVISED: -			SCALE: 5/16"=1' REVISION: -					
Note: Drawings are for reference only, measurements may vary from actual product.																

3008 MOBILE DRIVE
 ELKHART, IN 46514
 PH: 574-266-0911
 FAX: 574-266-6669

"LET US SHOW YOU THE MEDIX DIFFERENCE"
 WWW.MEDIXAMBULANCE.COM

Dealer: MEDIX

Approved By:

Date:

Customer:

STANDARD

17-

Sheet
B

ALL WARNING, SCENE, AND TAIL LIGHTS TO HAVE CHROME BEZELS.

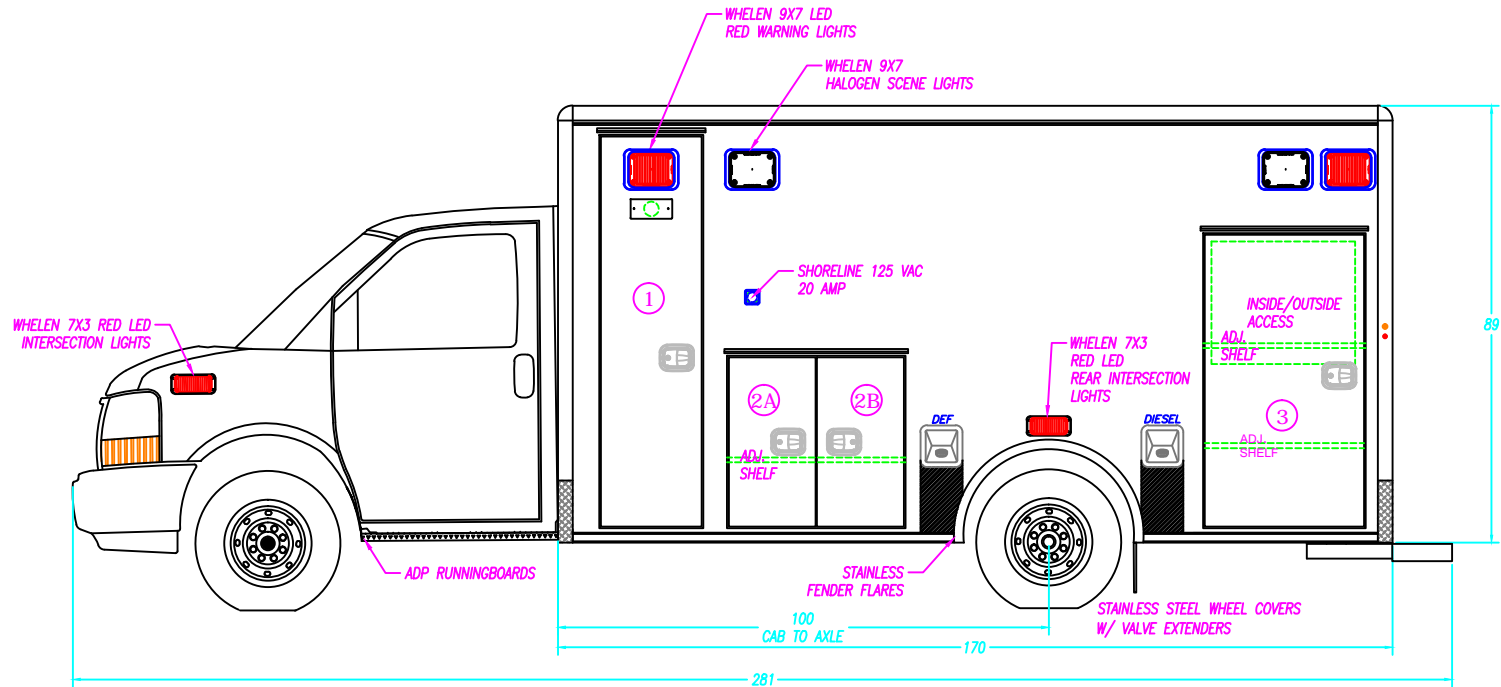

COMPARTMENT SIZES				NOTE: THE DIMENSIONS BELOW ARE INSIDE TUB DIMENSIONS				COMPARTMENT & ENTRY DOORS				COMPARTMENT TUBS			
NO.	COMPARTMENT TYPE	WIDTH	HEIGHT	DEPTH	NO.	PART NUMBER	NO.	PARTNUMBER	NO.	PART NUMBER	NO.	PARTNUMBER	NO.	PARTNUMBER	
1	O2 COMPARTMENT	20 1/2"	79 1/2"	18 1/2"	1	33-100663	3	33-100666	1	33-100689	-	---	2	33-101124	
2	MID STORAGE COMPARTMENT	35 3/4"	34 1/2"	18 1/2"	2A	33-100938	-	---	2	33-101124	-	---	3	33-100691	
3	REAR STORAGE COMPARTMENT	34"	59 1/2"	19 1/2"	2B	33-100939	-	---							
---	---	---	---	---	M2 170" TYPE III CHEVY G-4500 159" WHEELBASE										
COMPARTMENT / ENTRY DOOR SIZES				DESCRIPTION: STREET SIDE EXTERIOR				MEDIX 3008 MOBILE DRIVE ELKHART, IN 46514 PH: 574-266-0911 SPECIALTY VEHICLES, INC. FAX: 574-266-6669 "LET US SHOW YOU THE MEDIX DIFFERENCE" WWW.MEDIXAMBULANCE.COM							
NO.	COMPARTMENT / ENTRY DOOR TYPE	WIDTH	HEIGHT	DRAWN BY:	DATE CREATED:	SCALE:									
1	O2 STORAGE DOOR	20 3/8"	79 3/8"	D.EDWARDS	8/28/15	5/16"=1'									
2A	MID STORAGE DOOR-A	17 5/8"	34 3/8"	REVISED BY:	DATE REVISED:	REVISION:									
2B	MID STORAGE DOOR-B	17 3/8"	34 3/8"	-	-	-	Note: Drawings are for reference only, measurements may vary from actual product.								
3	REAR STORAGE DOOR	32 3/8"	59 3/8"												

Dealer: MEDIX

Approved By:

Date:

Customer: STANDARD

17-

Sheet
C

ALL WARNING, SCENE, AND TAIL LIGHTS TO HAVE CHROME BEZELS.

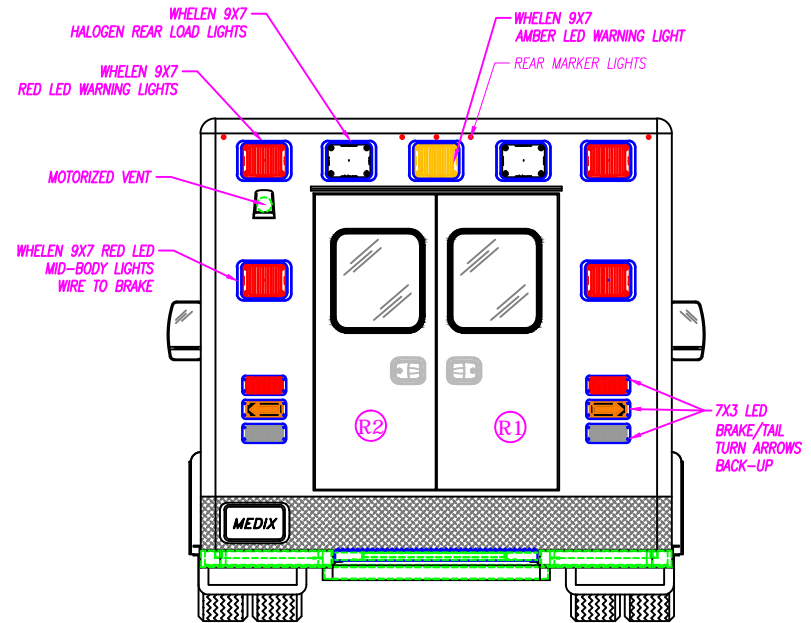
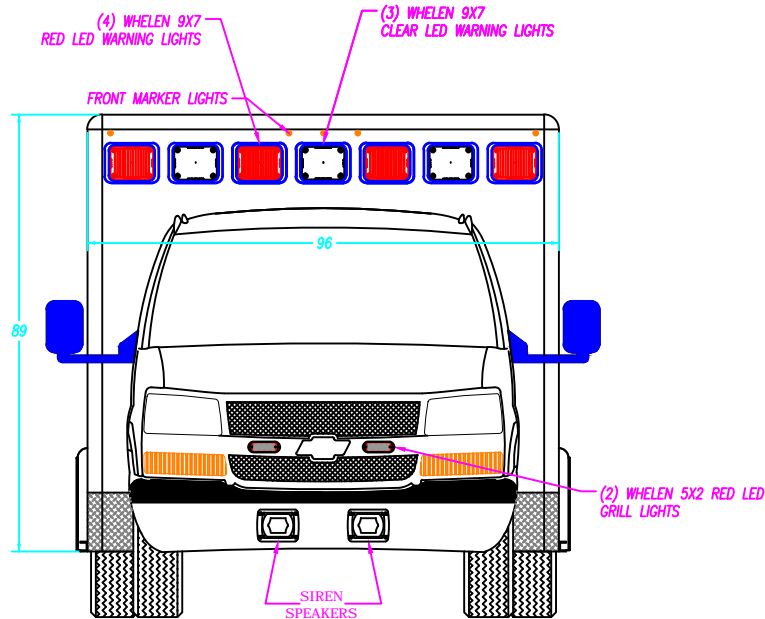

REAR ENTRY DOOR SIZES

NO.	WIDTH	HEIGHT	PART NUMBER
R1	25 5/16"	59"	33-100675
R2	25 5/16"	59"	33-100676

M2 170" TYPE III CHEVY G-4500 159" WHEELBASE		
DESCRIPTION: FRONT & REAR EXTERIOR		
DRAWN BY: D.EDWARDS	DATE CREATED: 8/28/15	SCALE: 5/16"=1'
REVISED BY: -	DATE REVISED: -	REVISION: -
Note: Drawings are for reference only, measurements may vary from actual product.		



MEDIX
SPECIALTY VEHICLES, INC.

3008 MOBILE DRIVE
ELKHART, IN 46514
PH: 574-266-0911
FAX: 574-266-6669

"LET US SHOW YOU THE MEDIX DIFFERENCE"
WWW.MEDIXAMBULANCE.COM

Dealer: MEDIX

Approved By:

Date:

Customer:

STANDARD

17-

Sheet
D

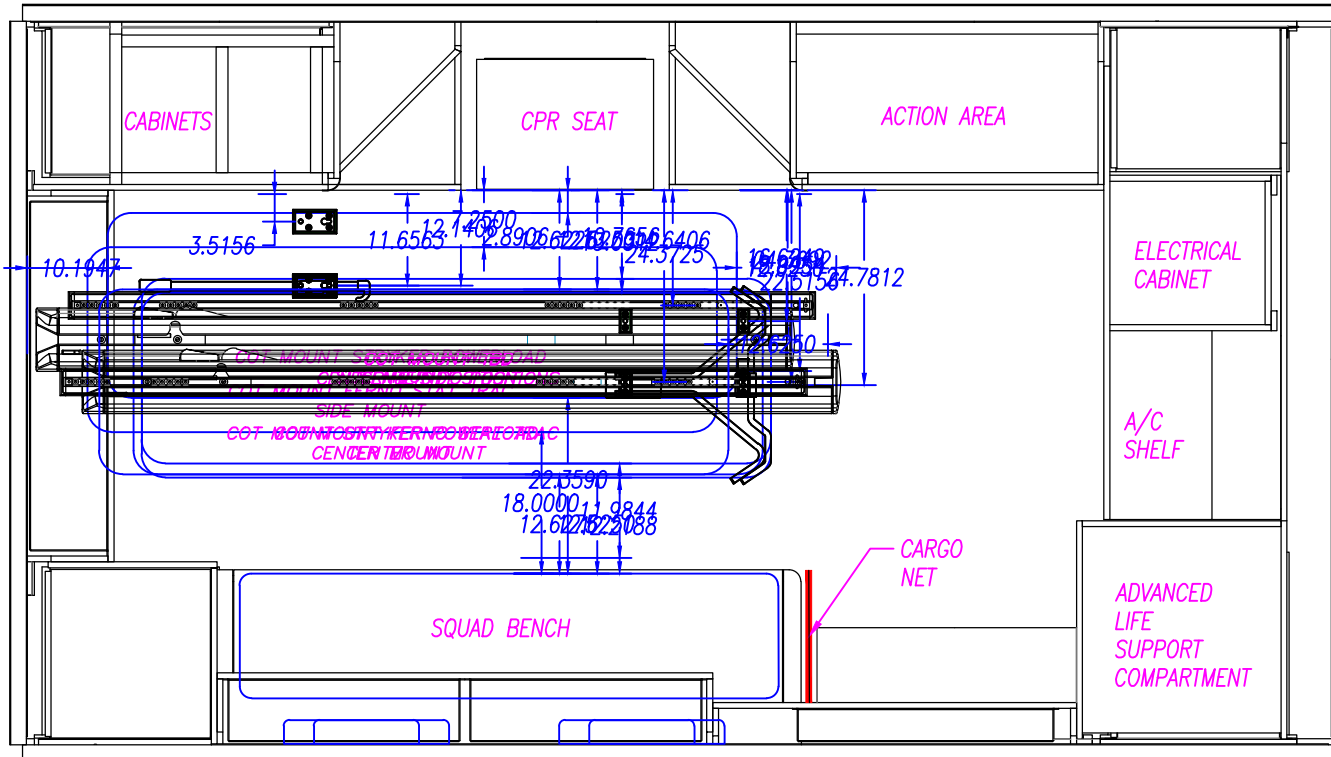

M2 170" TYPE III
CHEVY G-4500 159" WHEELBASE

DESCRIPTION: PATIENT AREA PLAN

DRAWN BY: D.EDWARDS	DATE CREATED: 8/28/15	SCALE: 1/2"=1'
REVISED BY: -	DATE REVISED: -	REVISION: -

Note: Drawings are for reference only, measurements may vary from actual product.



3008 MOBILE DRIVE
ELKHART, IN 46514
PH: 574-266-0911
FAX: 574-266-6669

"LET US SHOW YOU THE MEDIX DIFFERENCE"
WWW.MEDIXAMBULANCE.COM

Dealer: MEDIX

Approved By:

Date:

Customer:

STANDARD

17-

Sheet
E

CORIAN COUNTERTOPS IN 1ST & 2ND ACTION AREA.

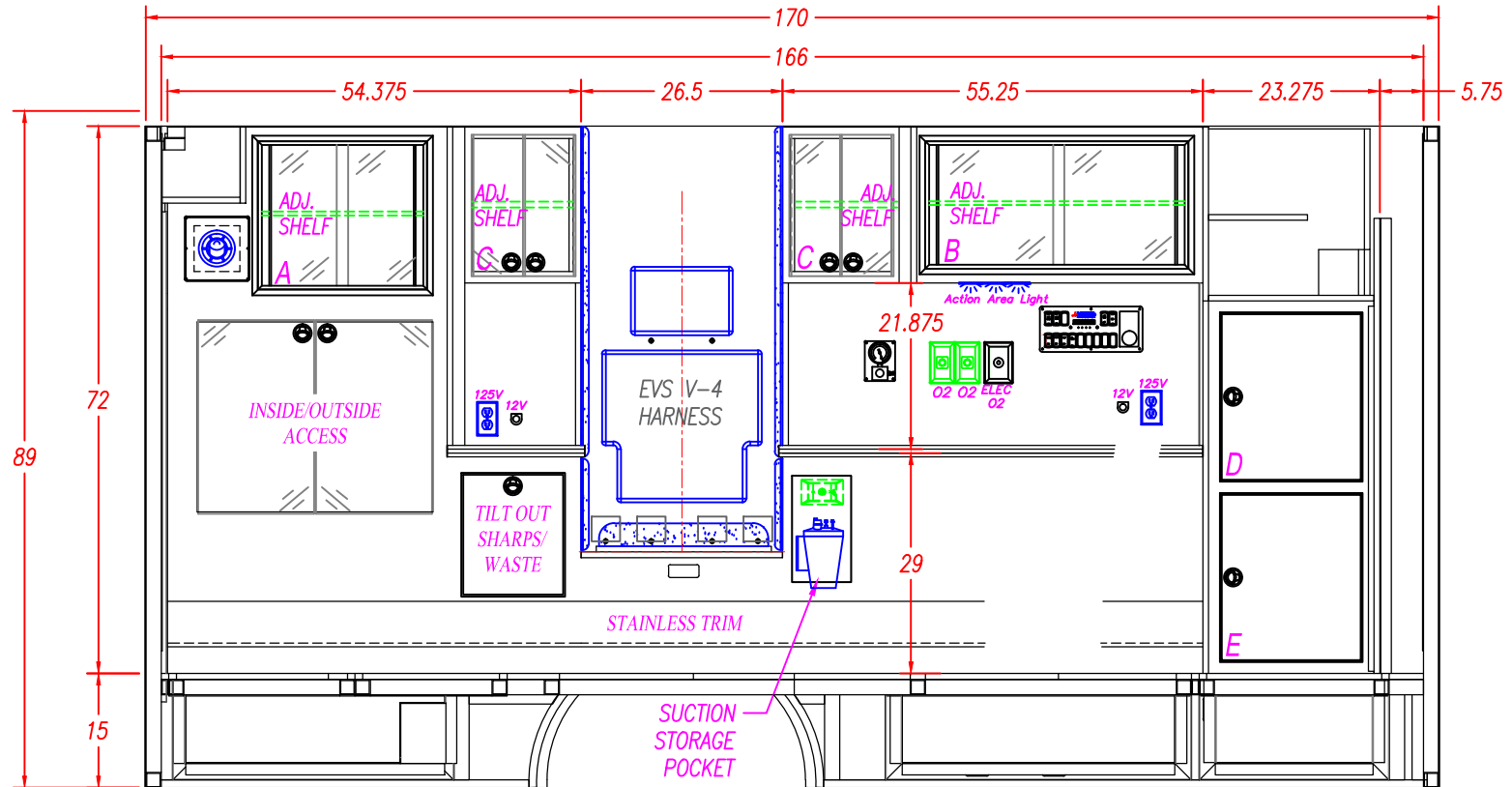

INTERIOR CABINET STORAGE

ITEM	HEIGHT	WIDTH	DEPTH	PART #'S
A	19 5/8"	24 3/4"	18"	43-A10697
B	16 1/2"	34 5/8"	18"	43-A10698
C	19"			-
D-1	11"	21 3/4"	17 1/4"	-
D-2	11"	21 3/4"	17 1/4"	-
E	23 1/2"	21 3/4"	17 1/4"	-

M2 170" TYPE III CHEVY G-4500 159" WHEELBASE		
DESCRIPTION: STREET SIDE INTERIOR		
DRAWN BY: D.EDWARDS	DATE CREATED: 8/28/15	SCALE: 1/2"=1'
REVISED BY: -	DATE REVISED: -	REVISION: -
Note: Drawings are for reference only, measurements may vary from actual product.		



3008 MOBILE DRIVE
ELKHART, IN 46514
PH: 574-266-0911
FAX: 574-266-6669

"LET US SHOW YOU THE MEDIX DIFFERENCE"
WWW.MEDIXAMBULANCE.COM

Dealer: MEDIX

Approved By:

Date:

Customer:

STANDARD

17-

Sheet
F

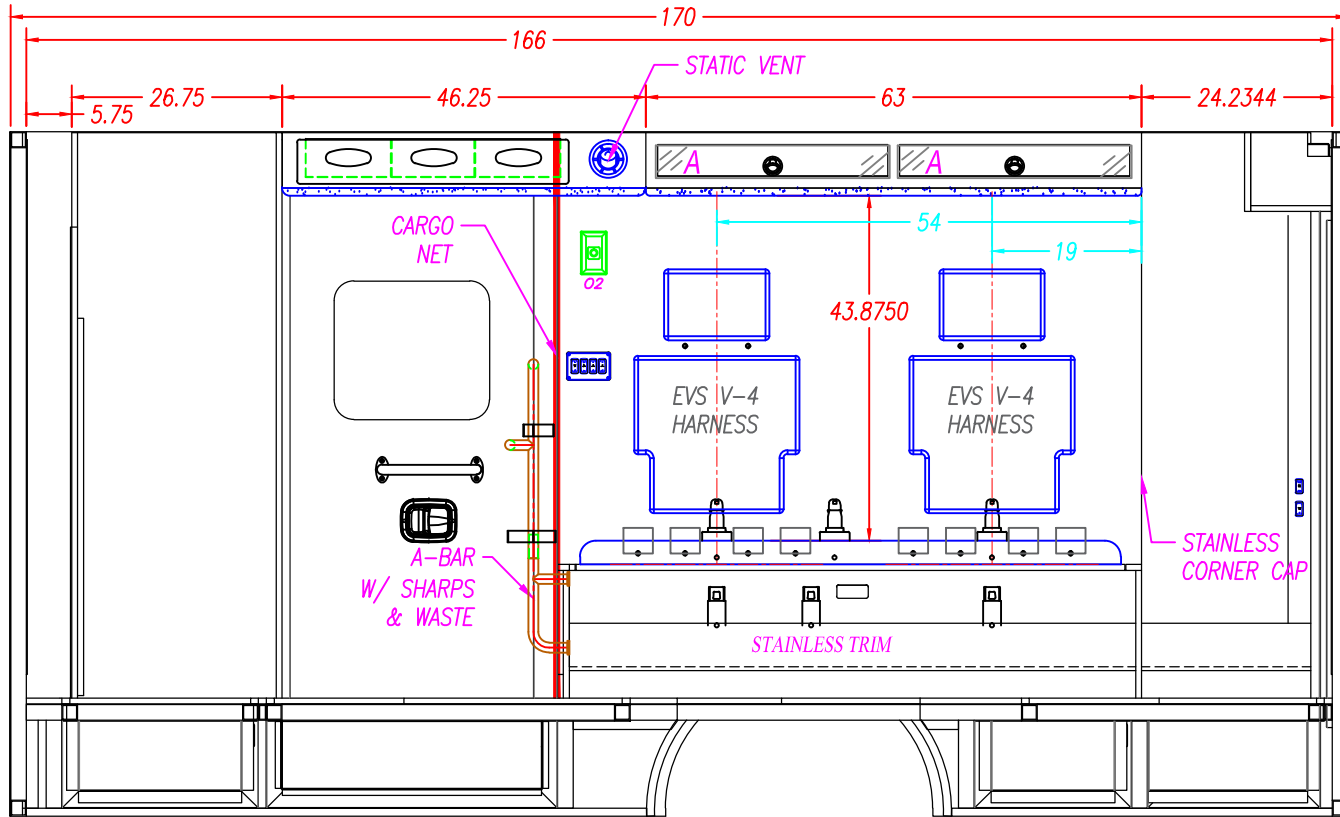

4" SEATBELT PLATE LOCATION

WELD SHOP	31	INCHES	NOTE: THIS DIMENSION IS FROM THE BOTTOM OF THE WALL TO THE BOTTOM OF THE 4" PLATE.				
	CABINET SHOP	NOTE: THE HOLES FOR THE TOP SEATBELT BOLTS ARE 1 1/2" FROM THE TOP OF THE SQUAD BENCH TO THE CENTER OF THE SEATBELT BOLT. NOTE: THE HOLES FOR THE BOTTOM SEATBELT BOLTS ON THE SQUAD BENCH ARE 9 3/8" FROM THE TOP OF THE FLOOR TO THE CENTER OF THE BOLT.					
		THE LOCATION OF THE BOTTOM SEATBELT HOLES ARE FROM THE REAR OF THE SQUAD BENCH TO THE CENTER OF THE 1/2" HOLE	BOTTOM			54"	42"
NOTE: READ THE DIMENSIONS FROM RIGHT TO LEFT AS VIEWED	THE LOCATION OF THE TOP SEATBELT HOLES ARE FROM THE REAR WALL TO THE CENTER OF THE 1/2" HOLE	TOP			54"	39"	19"

INTERIOR CABINET STORAGE

ITEM	HEIGHT	WIDTH	DEPTH	SPECIAL NOTE
A	4"	28 1/4"	7"	
B				
C				
D				
E				
F				

M2 170" TYPE III CHEVY G-4500 159" WHEELBASE		
DESCRIPTION: CURB SIDE INTERIOR		
DRAWN BY: D.EDWARDS	DATE CREATED: 8/28/15	SCALE: 1/2"=1'
REVISED BY: -	DATE REVISED: -	REVISION: -
Note: Drawings are for reference only, measurements may vary from actual product.		

3008 MOBILE DRIVE
ELKHART, IN 46514
PH: 574-266-0911
SPECIALTY VEHICLES, INC. FAX: 574-266-6669

"LET US SHOW YOU THE MEDIX DIFFERENCE"
WWW.MEDIXAMBULANCE.COM

Dealer: MEDIX

Approved By:

Date:

Customer: STANDARD

17-

Sheet
G

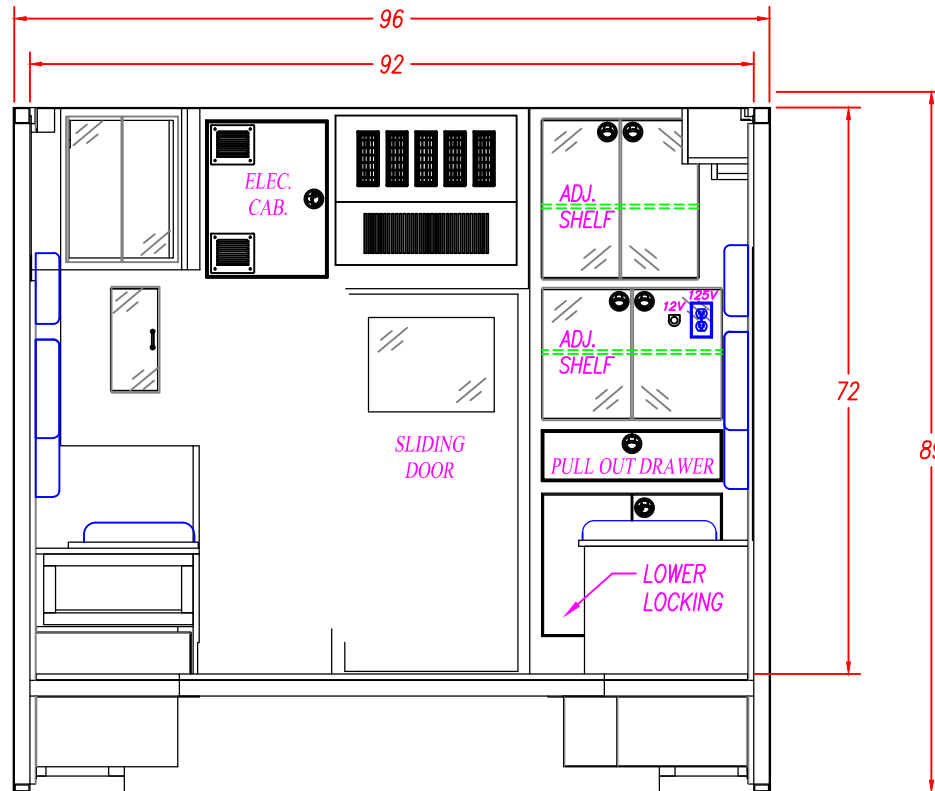

M2 170" TYPE III
 CHEVY G-4500 159" WHEELBASE

DESCRIPTION: FRONT ELEVATION

DRAWN BY: D.EDWARDS	DATE CREATED: 8/28/15	SCALE: 1/2"=1'
REVISED BY: -	DATE REVISED: -	REVISION: -

Note: Drawings are for reference only, measurements may vary from actual product.



3008 MOBILE DRIVE
 ELKHART, IN 46514
 PH: 574-266-0911
 FAX: 574-266-6669

"LET US SHOW YOU THE MEDIX DIFFERENCE"
 WWW.MEDIXAMBULANCE.COM

Dealer: MEDIX

Approved By:

Date:

Customer: STANDARD

17-

Sheet
H

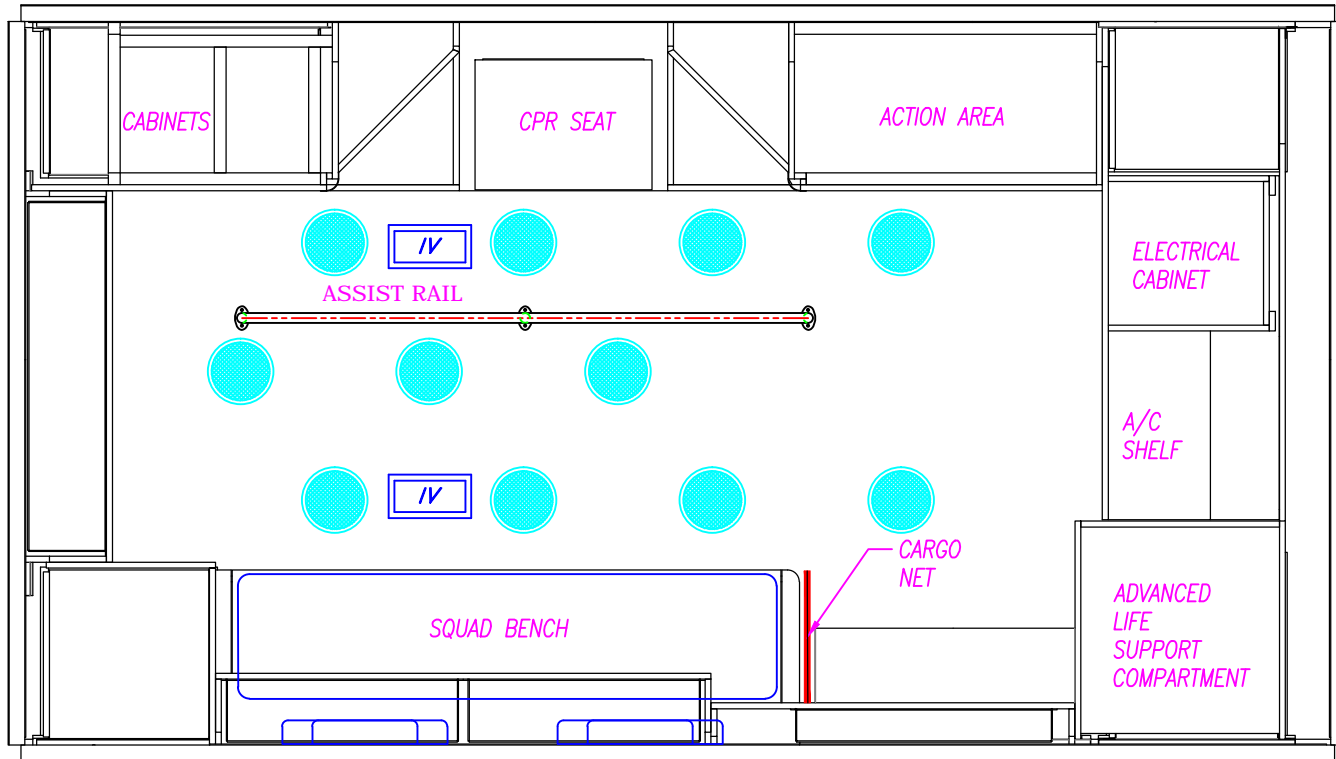

M2 170" TYPE III
CHEVY G-4500 159" WHEELBASE

DESCRIPTION: CEILING LAYOUT

DRAWN BY: D.EDWARDS	DATE CREATED: 8/28/15	SCALE: 1/2"=1'
REVISED BY: -	DATE REVISED: -	REVISION: -

Note: Drawings are for reference only, measurements may vary from actual product.



3008 MOBILE DRIVE
ELKHART, IN 46514
PH: 574-266-0911
FAX: 574-266-6669

"LET US SHOW YOU THE MEDIX DIFFERENCE"
WWW.MEDIXAMBULANCE.COM

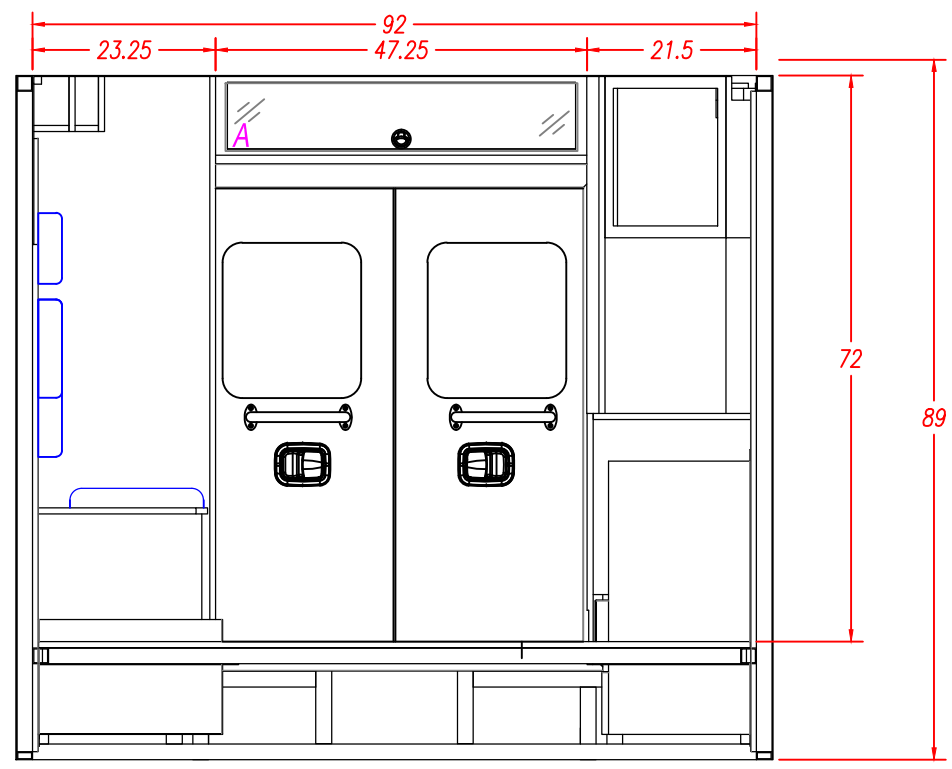

INTERIOR CABINET STORAGE				
ITEM	HEIGHT	WIDTH	DEPTH	SPECIAL NOTE
A	7"	44 1/4"	9"	
B				
C				
D				
E				
F				

M2 170" TYPE III CHEVY G-4500 159" WHEELBASE		
DESCRIPTION: REAR ELEVATION		
DRAWN BY: D.EDWARDS	DATE CREATED: 8/28/15	SCALE: 1/2"=1'
REVISED BY: -	DATE REVISED: -	REVISION: -
Note: Drawings are for reference only, measurements may vary from actual product.		

3008 MOBILE DRIVE
ELKHART, IN 46514
PH: 574-266-0911
FAX: 574-266-6669

"LET US SHOW YOU THE MEDIX DIFFERENCE"
 WWW.MEDIXAMBULANCE.COM