



SMART Mount Rotating Base Installation Instructions

Rotating base for use with the Philips SMART Mount and Tempus Pro

Contents

1. SMART Mount Rotating Base Assembly
2. Base Mounting Hardware
 - a. 4 - 5/16-18 x 2.5" Socket Cap Screw
 - b. 4 - 5/16-18 Locking Flange Nut
3. SMART Mount Attachment Hardware
 - a. 4 - M6 x 16mm Flat Head Screw
 - b. 4 - M6 Locking Nut
4. Philips SMART Mount
 - a. Customer Provided Device

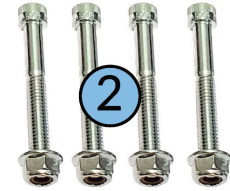
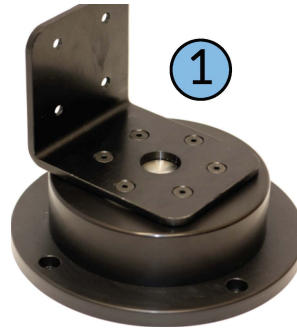

Tools Required

4mm Hex Allen Wrench

1/4" Hex Allen Wrench

Adjustable Wrench

5/16" Drill Bit

Instructions

1. Install Rotating Base Assembly to Flat Horizontal Surface
 - a. Place assembly in desired position and mark 4x hole locations
 - b. Set base assembly aside
 - c. Drill 4x holes at the marked locations using 5/16" or 21/64" drill bit.
 - d. Replace the base assembly and align with drilled holes
 - e. Install screw through all 4 base assembly and drilled mounting holes.
 - f. Install locking nut on each screw end and secure.
2. Install SMART Mount onto rotating base assembly
 - a. Locate SMART mount onto base assembly mounting flange
 - b. Install 4x screws from back of flange and secure using nuts
3. Install you Tempus Pro into SMART mount



MADE IN THE USA

United States Patent Numbers
11,001,206 and 11,007,951



www.penncare.net
sales@penncare.net
1-800-392-72