

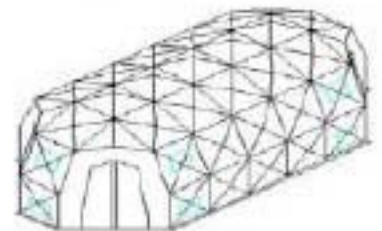

Medical Station System

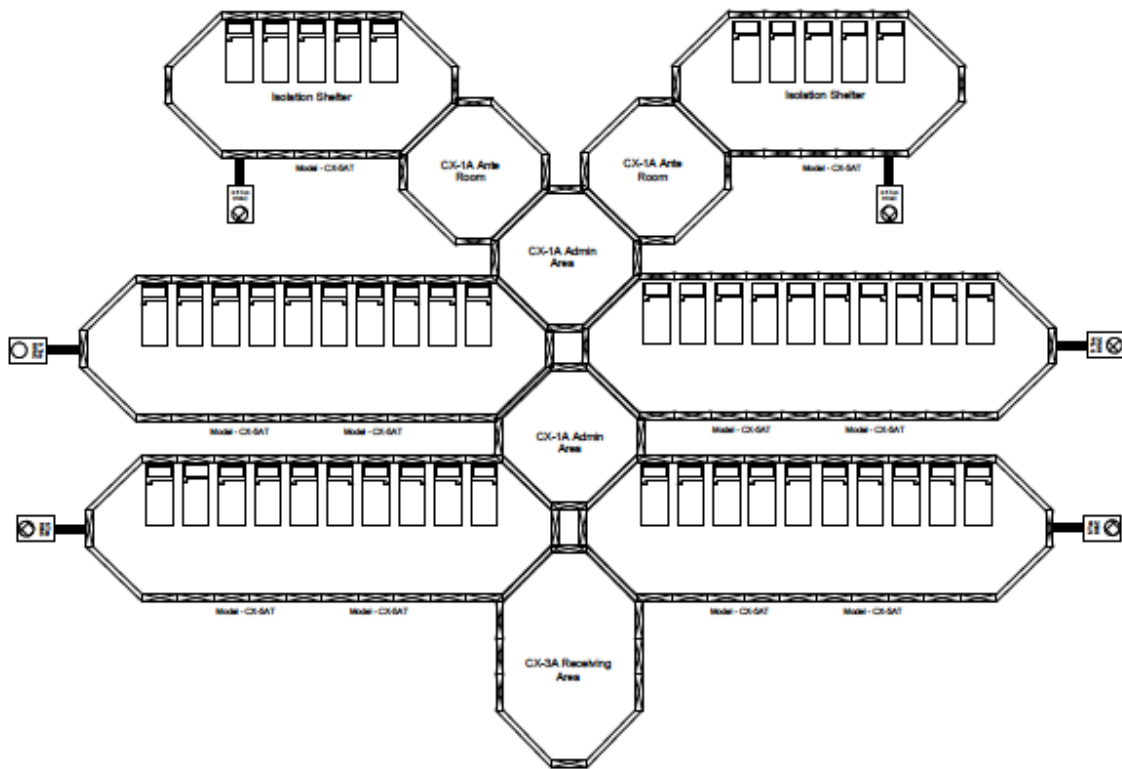



Penn Care offers a variety of products and services that aid in pre-hospital care and the treatment of life-threatening conditions. For more than twenty years, Penn Care has been delivering new and innovative solutions to customers who are faced with ever-changing demands. We provide an assortment of products and services that support the efforts of emergency medical professionals, public safety officials, disaster response agents and many others. We truly are a "one stop shop" for all of your pre-hospital and disaster response needs. To learn more about the depth of our company, we encourage you to explore our website (www.penncare.net) and find out why our motto has always been:

Many Needs... One Solution... Penn Care.

We understand that the number one priority in any **Mass Casualty Incident (MCI)** is the preservation of life. At Penn Care, we are constantly looking for new products and solutions to make your job easier. We undertake this mission with a clear customer focus and recognition that people are the most valuable asset.

During the past several years, the management of large-scale incidents has undergone dramatic changes resulting from events such as the September 11, 2001 tragedy, and the awareness of possible future terrorist activities. Few, if any hospitals in America today, could handle 100 patients suddenly demanding care. There is no metropolitan area; no geographically contiguous area that could handle 1000 people suddenly needing advanced medical care in this country right now.

A familiar concept to health care organizations, **surge capacity** is a health care system's ability to expand quickly beyond normal services to meet an increased demand for medical care. **Surge hospitals** have been defined as facilities designed to supplement existing hospitals in the case of an emergency and build their plans based on the needs of the community as well as the resources available to the organization. There may be a situation where federal support is disqualified or local personnel and resources need to be utilized until federal assistance arrives.

Penn Care has a rich history in **Disaster Response** and **Homeland Security**. Our staff regularly attends conferences, tradeshow and training seminars in order to keep up to date on industry trends and new technologies. We have taken this knowledge and used it to find some of the best products available to support your mission in **Homeland Security** and **Disaster Response**.

For the past 20 years, Penn Care has been making good progress as a company. We are passionate about our organization and work because we believe the best is yet to come and in building a growth culture. We seek out ways to help our customers grow and to help our partners grow. We succeed due to our leadership, technology expertise, partners, customers and resources. We extend our appreciation to our employees, customers, and vendors, whose loyal support contributes immeasurably to our ongoing success.

System Overview

Penn Care has experience in designing and putting together portable medical stations to be used in the event of a disaster response. We have built and designed 5 Bed, 10 Bed, 25 Bed, and 50 Bed Shelter Systems to accommodate medical and special needs patients. This system can be set up anywhere. It is designed for hospital overflow, to be an alternative care site, and handle negative and positive pressure isolation patients. It can be used as a medical dispensary site as well as a first aid station. The Medical Station System is designed service those patients that need Oxygen on a daily basis. If a hospital goes down in the event of a tornado, hurricane, or a disaster, this system can be used until a permanent facility can be built.

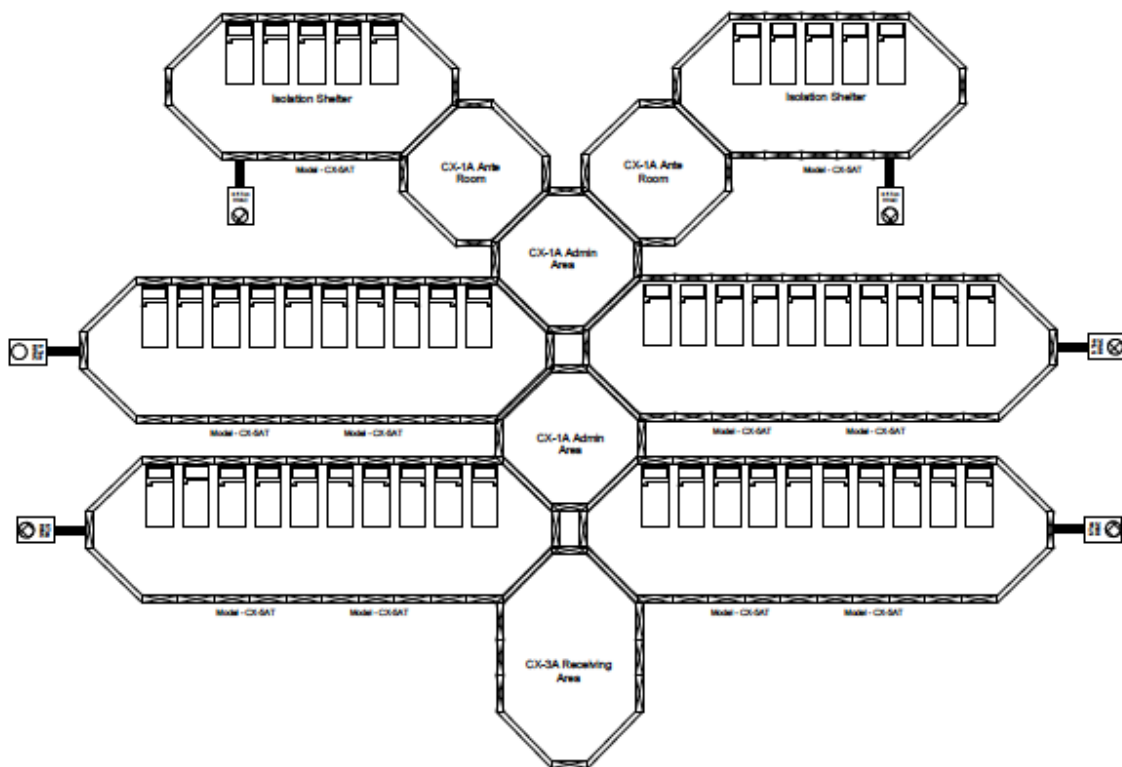

Trailer Overview

The Medical Station System is designed to be deployed in alternative locations. The primary transport mechanisms are customized trailers that are not only to be used as transport of the system, but also they can be used to transport supplies to the alternative care site. The trailers can also be used as a secured pharmacy and as additional facilities. The trailers can be customized and designed for specific functions.



Shelter Overview

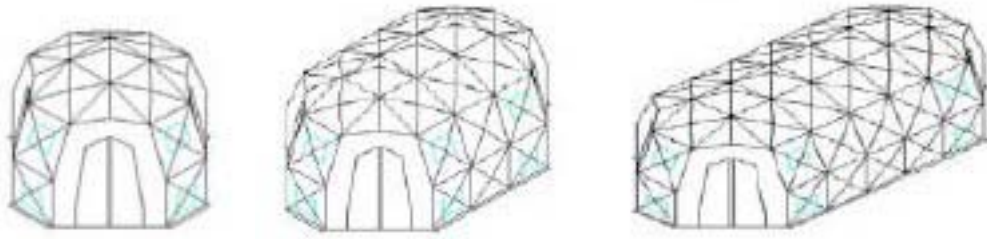

This system uses an expandable frame shelter system. The system is designed to be similar to the U.S. Military's shelter systems. Once the shelter is setup, it can provide months of stability out of the weather. The frame uses a hub technology that takes away the need for tools when replacing shelter frame struts. A hard floor can be added to it.

Unlike inflatable shelters, expandable rigid frame shelters do not rely on electricity and air to maintain its integrity. The frame is not compromised by punctures. The shelter does not have to be deflated so that it can be repaired.

The 50 Bed Shelter System is designed to be reconfigured to be added to or split up into two 25 Bed Shelter Systems. It can also be modified into four 10 Bed Shelter Systems and two 5 Bed Shelter Systems.

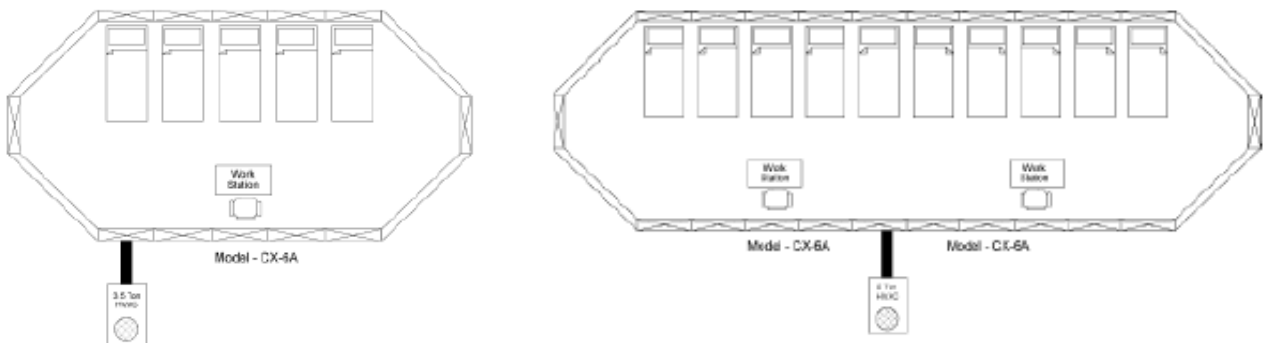

Electrical Overview

The electrical system is designed to deliver the proper voltage and wattage the system as a whole. We use a diesel system as diesel is readily available throughout the world, and it also preserves the proper functionality of computer and sensitive electronic equipment. In order to split this into two systems, Penn Care offers a dual diesel generator setup, which also offers a double power redundancy. A single generator setup is also available to provide power for this system. We made sure to provide the proper cabling to provide proper voltage to the HVAC System.

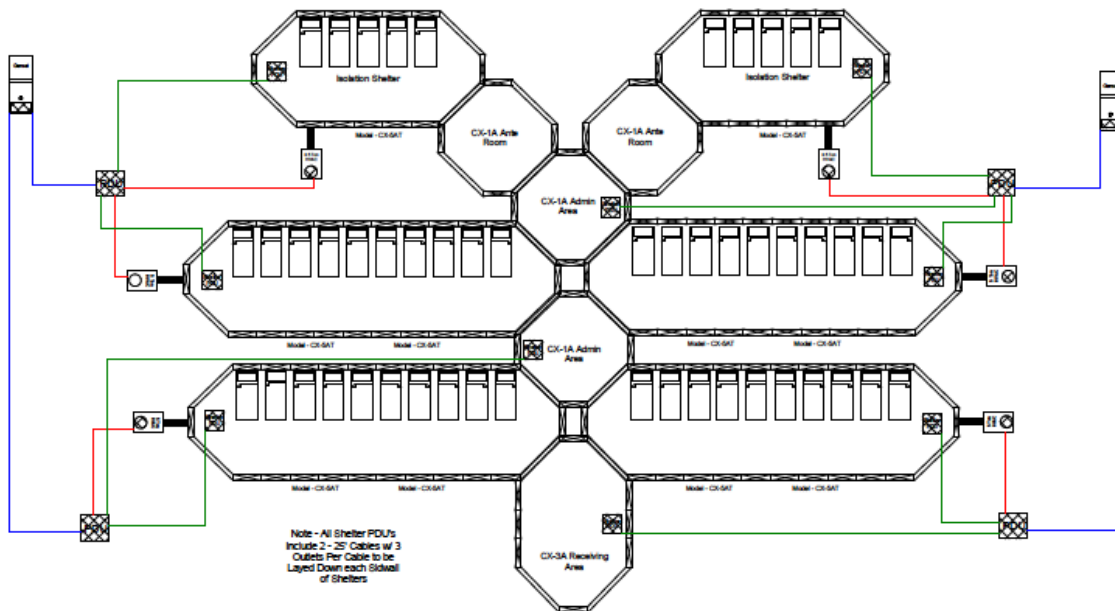

HVAC System

The HVAC System is designed to provide adequate heating and air conditioning throughout the 50 Bed Medical Station. It is designed to provide over 60,000 BTU to each 10 Bed Station and over 42,000 to each 5 Bed Station. The HVAC is system is designed to be weather hardened and used in multiple temperature environments.



Negative Pressure System

The two 5 Bed Shelters are also designed to have negative/positive pressure added to them. Penn Care uses the PASS - 1600 IU Unit, which to be used in weather conditions.

The **PASS - 1600 IU** Unit (Portable Air Safety Systems Isolation Unit) has been designed to meet or exceed the CDC guidelines for Medical Isolation in all Field Hospital and Surge applications. We reach unmatched levels of performance by employing the patented technology of HEPA filtration and UVC irradiation in a portable system. The PASS - 1600 ISO can create either positive pressure “Collective Protection” or negative pressure “Medical Isolation” utilizing the patented technology to capture, contain and neutralize biological contaminants in all weather conditions. Most importantly the PASS - 1600 ISO unit can be use in conjunction with any portable shelter or building to create unmatched capability for medical isolation protection. **PASS – 1600 IU** controller displays area and filter pressure simultaneously in real time to give Health care Workers and First Responders piece of mind.

PASS – 1600 IU is used for the following:

- Positive Pressure Protective Isolation
- Negative Pressure Medical Isolation
- Continuous Pressure Monitoring of Isolation Area
- Automatic Download Data Logging
- Variable Speed Blower 0 to 1600 cfm
- Digital Display of Room Pressure and HEPA Filter Pressure
- Oversized Rapid Change High Flow HEPA Filter with UVGI
- Performance Monitoring with Audio and Visual Alarms
- Ozone Generators for Post Event Decon
- All Weather Durable Construction
- 8000 Cubic Foot Capacity at 12 Air Changes Per Hour



Medical Supplies Overview

The 50 Bed Medical System is designed to provide medical care to 50 patients over the course of 7 days. The system is not designed for surgeries, but a system can be added to it to provide such a level of care. The system does provide oxygen so that patients can be intubated. The beds are at wheelchair height so patients can easily transfer onto the beds. We do offer a procedure height bed and a bariatric bed. The system also offers supplies for IVs, wound care, and births.



Mass Oxygen Distribution System (MODS) Overview □□

New to Penn Care's Disaster Response Division, the **Mass Oxygen Distribution System (MODS)** is revolutionizing the way organizations and communities prepare for a disaster. A **MODS** is a portable patient medical oxygen system and can provide over 64,000 gaseous liters of oxygen (stored as only 75 liters of LOX) to multiple patients. In fact, the oxygen capacity of just one **MODS** system is equivalent to 12 large high-pressure H cylinders. Furthermore, LOX costs less than gaseous oxygen and uses ALL of the oxygen volume, whereas gaseous oxygen cylinders only utilize 80% of their volume and are heavy and difficult to transport. In short, a **MODS** is the most cost-effective and space-conscious way to deliver oxygen to multiple patients in the event of a crisis or hospital evacuation.

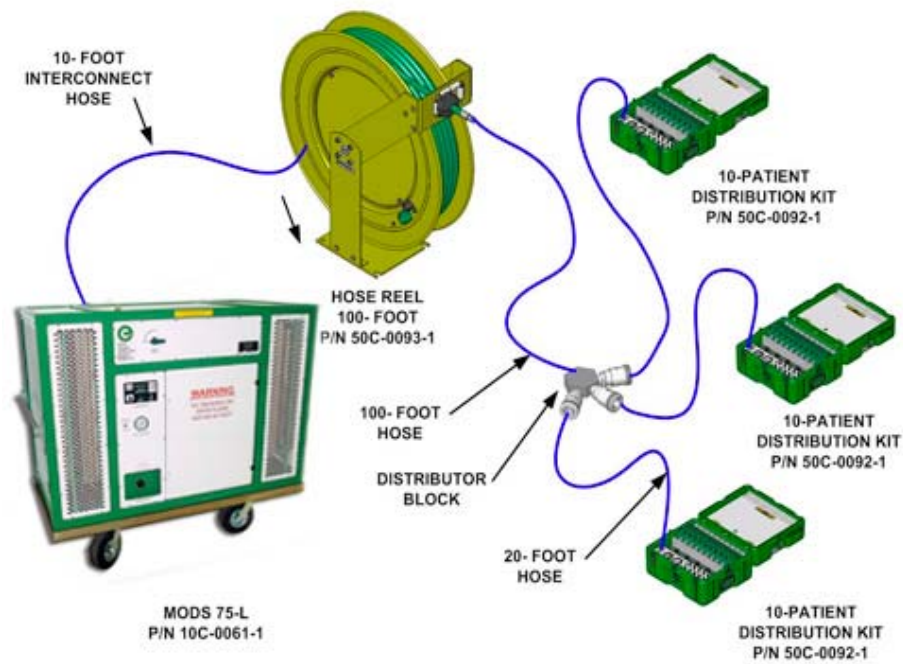

Nursing/Vaccination Stations

Our original pumped-up, portable emergency medical station allows you to dispense, vaccinate, assemble, strategize and command — whenever and wherever you're called to action.

Built for Emergency Responders *by* Emergency responders.

FEATURES:

Six drawer configuration

Unique removable 4' x 4' front panel flips to a workstation table in seconds

Three mounted, locked tilt bins provide easy access

Easy clean work surface, comfortable 42" from ground
Hand holds, pulls and places for tie-downs; POD BOX goes where you go

Four EZ Glide casters muscle-up even your weakest link, lockable front casters for stability, glide across most surfaces

Hasp locks for security and safety

OPTIONS:

Mounted dry erase board

Medical Grade (certified with thermometer and lock)

Aluminum Laminate or all Aluminum

Your brand by color or logo

Additional configurations

SPECS:

size: 48" w x 25" d x 48" h

weight: 330 lbs



Mortuary Overview

Penn Care Medical offers a mortuary option to turn our shelter systems into a morgue using the Mortuary Enhanced Remains Cooling (MERC) System.

MERC® Temporary Cooling Systems (TCS) use liquid cooling technology and specifically designed cooling bags to provide the total solution to mass fatality response. The MERC® System is the only system available that does not use chilled air to provide cooling for human remains. Systems are scalable to meet your needs and can provide cooling for 1-48 remains. All MERC® Systems are low-maintenance, portable and can be fully operational in less than 15 minutes. Penn Care also offers a diverse line of Morgue Accessories that work in conjunction with the MERC® System and allow you to set up a mobile morgue virtually anywhere.

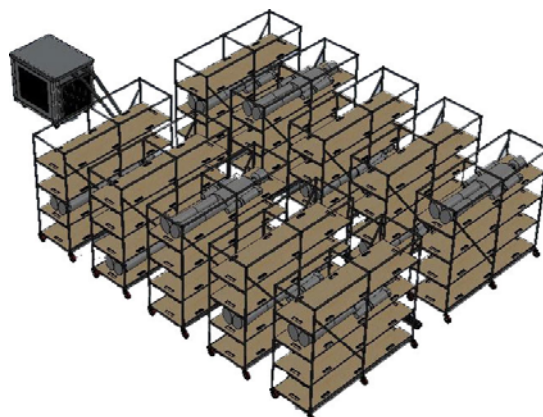

Please contact your local sales representative for specifications and pricing.