

DIMENSIONS ARE APPROXIMATE
 OVERALL HEIGHT = 112"
 OVERALL WIDTH WITH RUB
 RAILS & FENDERETTES = 98"

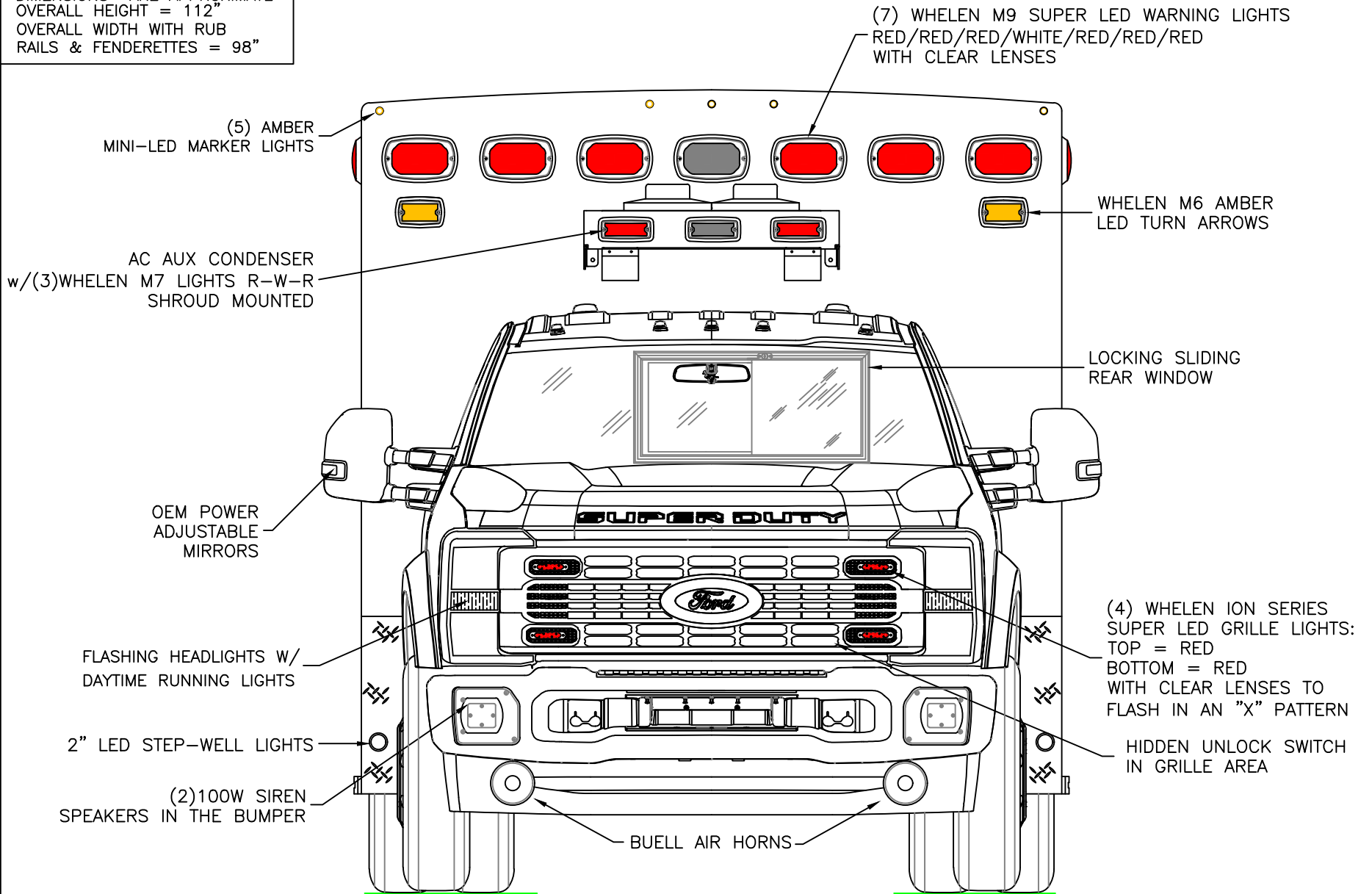

THIS DRAWING IS FOR REPRESENTATIONAL PURPOSES ONLY. DETAILS ARE CONCEPTUAL AND ARE SUBJECT TO CHANGE DURING DESIGN AND CONSTRUCTION
 DIMENSIONS ARE APPROXIMATE UNLESS NOTED OTHERWISE TO MEET A SPECIFIC CUSTOMER NEED.

PENN CARE STOCK



FRONT EXTERIOR VIEW
 CHIEF XL-1/F550 4x4 GAS CHASSIS

DATE:
 10-24-24
 DWG.
 BT
 DATE:

DRAWING NO.
 CPQ#11265
 REV.
 NR
 STOCK-1

APPROVAL SIGNATURE:

DIMENSIONS ARE APPROXIMATE
 OVERALL HEIGHT = 112"
 OVERALL WIDTH WITH RUB
 RAILS & FENDERETTES = 98"

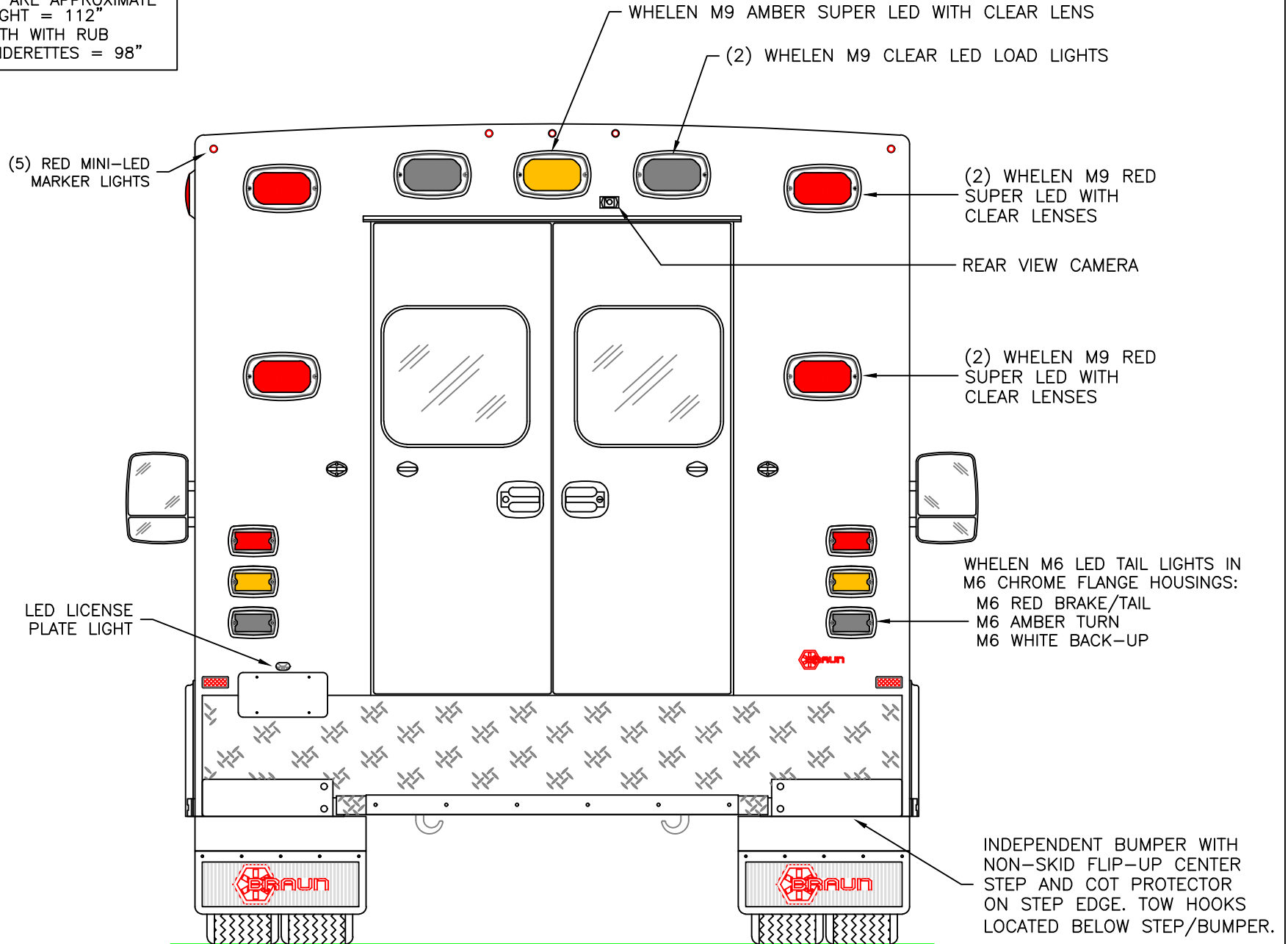

THIS DRAWING IS FOR REPRESENTATIONAL PURPOSES ONLY. DETAILS ARE CONCEPTUAL AND ARE SUBJECT TO CHANGE DURING DESIGN AND CONSTRUCTION
 DIMENSIONS ARE APPROXIMATE UNLESS NOTED OTHERWISE TO MEET A SPECIFIC CUSTOMER NEED.

PENN CARE STOCK



REAR EXTERIOR VIEW
 CHIEF XL-1/F550 4x4 GAS CHASSIS

1:16

DATE: 6-10-25	DRAWING NO. CPQ#11265
DWG. TKD	REV. A
STOCK-2	

DIMENSIONS ARE APPROXIMATE
 OVERALL HEIGHT = 112"
 OVERALL LENGTH = 307"
 MODULE LENGTH = 169"

NOTE: DEF FILL REMOVED IF
 GAS CHASSIS IS QUOTED.

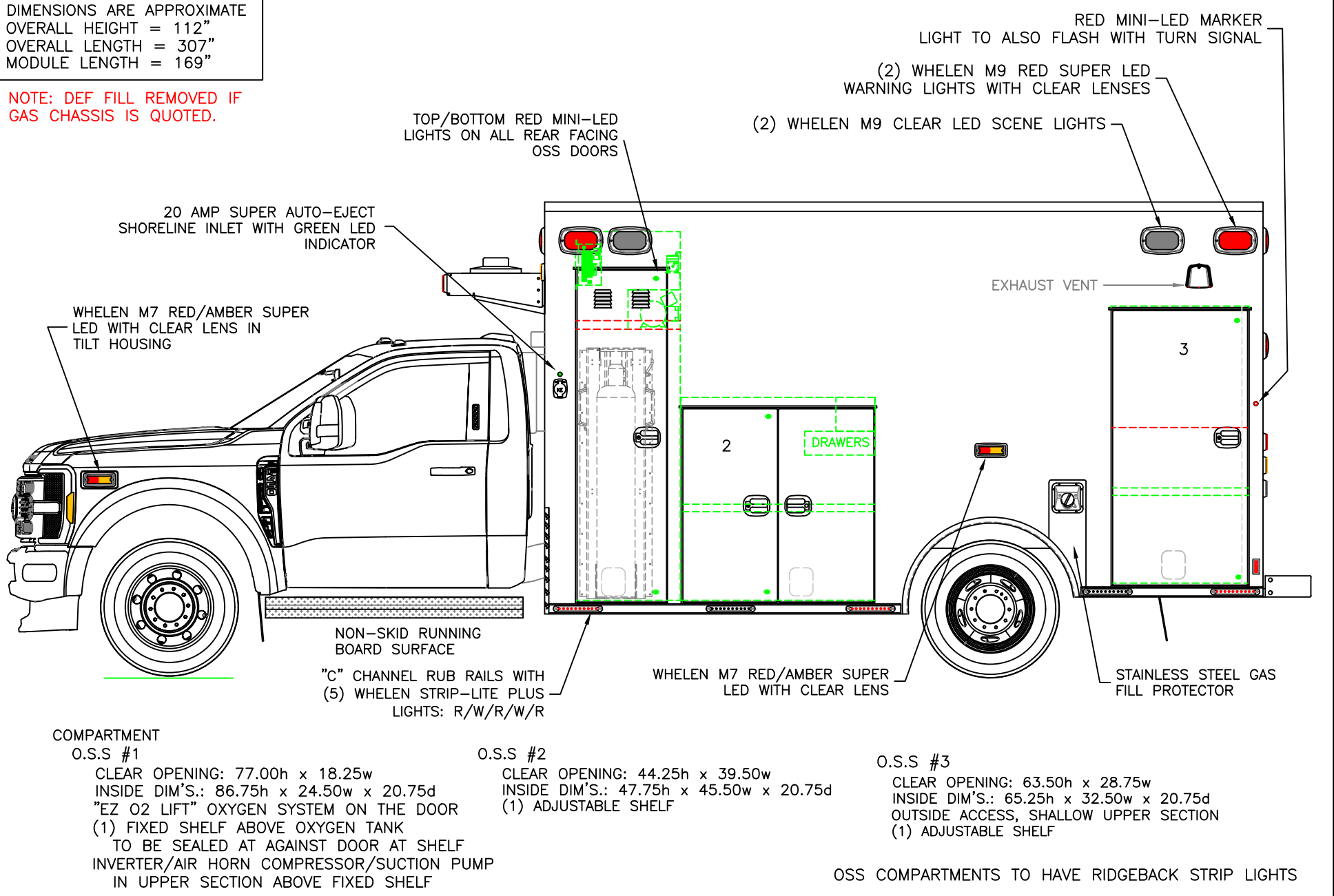

COMPARTMENT
 O.S.S #1

CLEAR OPENING: 77.00h x 18.25w
 INSIDE DIM'S.: 86.75h x 24.50w x 20.75d
 "EZ O2 LIFT" OXYGEN SYSTEM ON THE DOOR
 (1) FIXED SHELF ABOVE OXYGEN TANK
 TO BE SEALED AT AGAINST DOOR AT SHELF
 INVERTER/AIR HORN COMPRESSOR/SUCTION PUMP
 IN UPPER SECTION ABOVE FIXED SHELF

O.S.S #2

CLEAR OPENING: 44.25h x 39.50w
 INSIDE DIM'S.: 47.75h x 45.50w x 20.75d
 (1) ADJUSTABLE SHELF

O.S.S #3

CLEAR OPENING: 63.50h x 28.75w
 INSIDE DIM'S.: 65.25h x 32.50w x 20.75d
 OUTSIDE ACCESS, SHALLOW UPPER SECTION
 (1) ADJUSTABLE SHELF

OSS COMPARTMENTS TO HAVE RIDGEBACK STRIP LIGHTS

THIS DRAWING IS FOR REPRESENTATIONAL PURPOSES ONLY. DETAILS ARE CONCEPTUAL AND ARE SUBJECT TO CHANGE DURING DESIGN AND CONSTRUCTION
 DIMENSIONS ARE APPROXIMATE UNLESS NOTED OTHERWISE TO MEET A SPECIFIC CUSTOMER NEED.

PENN CARE STOCK



STREETSIDE EXTERIOR VIEW
 CHIEF XL-1/F550 4x4 GAS CHASSIS

1:30

DATE:	6-10-25
DWG.:	TKD
REV.:	A

DRAWING NO.
 CPQ#11265
 STOCK-3

DIMENSIONS ARE APPROXIMATE
 OVERALL HEIGHT = 112"
 OVERALL LENGTH = 307"
 MODULE LENGTH = 169"

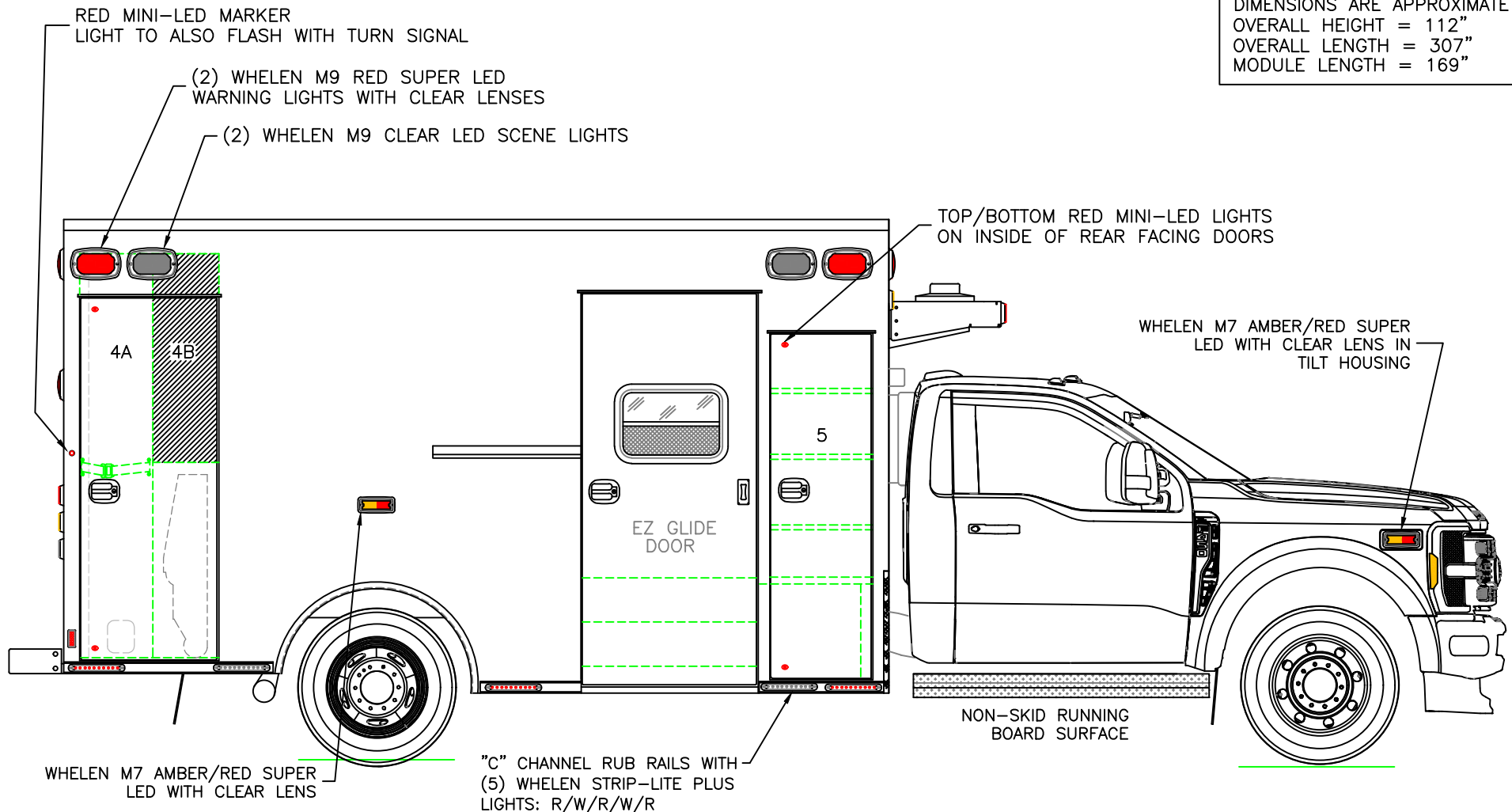

COMPARTMENT

O.S.S #4

CLEAR OPENING: 73.00h x 24.75w
 INSIDE DIM'S. 4A: 82.75h x 15.00w x 20.75d
 BACKBOARD/SCOOP STORAGE
 INSIDE DIM'S. 4B: 82.75h x 13.50w x 20.75d
 CLOSEOUT ABOVE 40" FOR INTERIOR CABINETS

O.S.S #5

CLEAR OPENING: 69.50h x 17.50w
 INSIDE DIM'S: SEE PARTITION INTERIOR VIEW
 INSIDE/OUTSIDE ACCESS WITH (3) ADJUSTABLE SHELVES

INSIDE DIM'S. 5B: 19.00h x 20.75w x 18.00d

OSS COMPARTMENTS TO HAVE RIDGEBACK STRIP LIGHTS

THIS DRAWING IS FOR REPRESENTATIONAL PURPOSES ONLY. DETAILS ARE CONCEPTUAL AND ARE SUBJECT TO CHANGE DURING DESIGN AND CONSTRUCTION
 DIMENSIONS ARE APPROXIMATE UNLESS NOTED OTHERWISE TO MEET A SPECIFIC CUSTOMER NEED.

PENN CARE STOCK



CURBSIDE EXTERIOR VIEW
 CHIEF XL-1/F550 4x4 GAS CHASSIS

1:30

DATE:	6-10-25
DWG.:	TKD
REV.:	A

DRAWING NO.	CPQ#11265
	STOCK-4

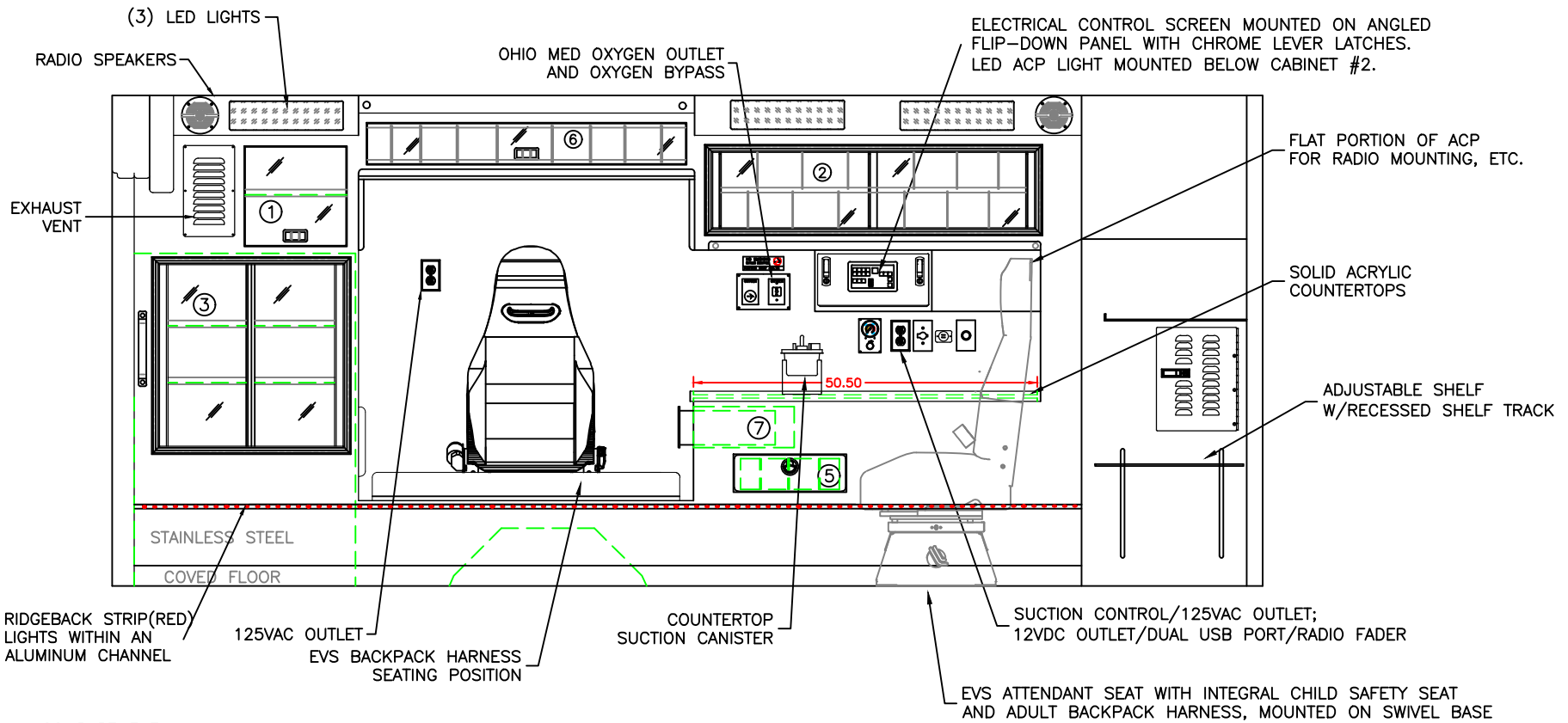

COMPARTMENT

#1 DOOR OPENING: 14.75h x 15.00w
 INSIDE DIMS: 14.75h x 15.00w x 17.25d
 (1) ADJUSTABLE SHELF
 HINGED POLYCARBONATE DOOR
 CENTER SQUEEZE LATCH
 TOTAL CABINET WEIGHT RATING = 10 lbs.

#2 DOOR OPENING: 11.00h x 47.25w
 INSIDE DIMS: 13.25h x 49.00w x 17.25d
 (1) ADJ SHELF EACH SIDE OF CENTER DIVIDER
 SLIDING POLYCARBONATE DOORS
 LIFT UP RESTOCKING FRAME
 (6) ADJUSTABLE DIVIDERS TOP/BOTTOM
 TOTAL CABINET WEIGHT RATING = 25 lbs.

#3 DOOR OPENING: 26.50h x 26.75w
 INSIDE DIMS: 28.00h x 28.25w x 9.00d
 SLIDING POLYCARBONATE DOORS
 (2) ADJUSTABLE SHELVES
 TOTAL CABINET WEIGHT RATING = 25 lbs.

#4 REMOVED FROM DISPLAY

#5 PULL-OUT DRAWER
 INSIDE DIMS: 4.50h x 15.00w x 12.00d
 LOCKING STAINLESS STEEL FLUSH PULL LATCH
 (3) FULL LENGTH ADJUSTABLE DIVIDERS
 TOTAL DRAWER WEIGHT RATING = 10 lbs.

#6 DOOR OPENING: 6.25h x 47.00w
 INSIDE DIMS: 6.25h x 47.00w x 17.25d
 TOP HINGED POLYCARBONATE DOOR
 CENTER SQUEEZE LATCH W/HOLD OPENS
 43" MINIMUM HEADROOM BELOW THE CABINET
 (8) ADJUSTABLE DIVIDERS
 TOTAL CABINET WEIGHT RATING = 10 lbs.
 #7 PULL-OUT DRAWER TOWARD CPR SEAT
 INSIDE DIMS: 4.00h x 7.00w x 12.00d
 LOCKING STAINLESS STEEL FLUSH PULL LATCH
 TOTAL DRAWER WEIGHT RATING = 10 lbs.

RED RIDGEBACK LED STRIP LIGHTING IN CABINETS
 CABINET #2 TO BE LIFT UP RESTOCKING FRAME
 INVENTORY CONTROL SYSTEM

THIS DRAWING IS FOR REPRESENTATIONAL PURPOSES ONLY. DETAILS ARE CONCEPTUAL AND ARE SUBJECT TO CHANGE DURING DESIGN AND CONSTRUCTION
 DIMENSIONS ARE APPROXIMATE UNLESS NOTED OTHERWISE TO MEET A SPECIFIC CUSTOMER NEED.

PENN CARE STOCK



STREETSIDE INTERIOR VIEW
 CHIEF XL-1

1:22

DATE:	6-10-25	
DWG.	TKD	REV.
		A

DRAWING NO.
 CPQ#11265
 STOCK-5

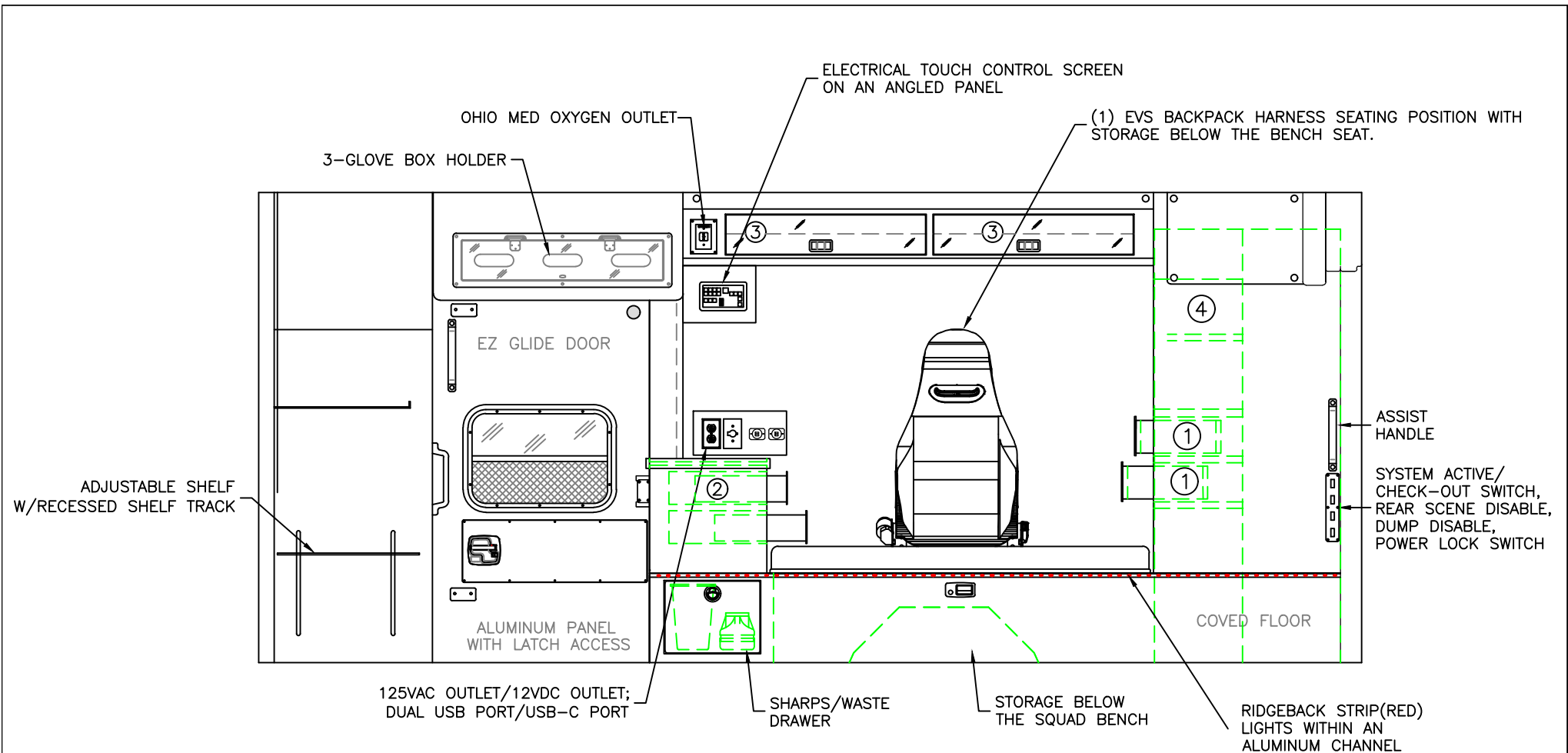

COMPARTMENT

#1 PULL-OUT DRAWERS TOWARD BENCH SEAT
 INSIDE DIMS: 4.50h x 13.00w x 12.00d
 LOCKING STAINLESS STEEL FLUSH PULL LATCH
 (3) FULL LENGTH ADJUSTABLE DIVIDERS
 TOTAL DRAWER WEIGHT RATING = 10 lbs.

#2 (2) PULL-OUT DRAWERS TOWARDS BENCH
 INSIDE DIMS: 4.00h x 10.00w x 14.00d
 LOCKING STAINLESS STEEL FLUSH PULL LATCHES
 TOTAL DRAWER WEIGHT RATING = 10 lbs. EACH

#3 DOOR OPENING: 6.25h x 30.25w
 INSIDE DIMS: 6.25h x 30.25w x 10.25d
 TOP HINGED POLYCARBONATE DOORS
 TOP HINGED POLYCARBONATE DOORS
 CENTER SQUEEZE LATCHES
 43" MINIMUM HEADROOM BELOW THE CABINET
 TOTAL CABINET WEIGHT RATING = 10 lbs. EACH

#4 DOOR OPENING: 19.50h x 14.00w
 INSIDE DIMS: 19.50h x 14.00w x 12.25d
 HINGED POLYCARBONATE DOORS WITH FULL LENGTH HANDLES
 WITH CENTER SQUEEZE LATCH
 (1) ADJUSTABLE SHELF
 CABINET DOES NOT COMPLY WITH CN10

INVENTORY CONTROL SYSTEM
 RED RIDGEBACK LED STRIP LIGHTING IN CABINET #4

THIS DRAWING IS FOR REPRESENTATIONAL PURPOSES ONLY. DETAILS ARE CONCEPTUAL AND ARE SUBJECT TO CHANGE DURING DESIGN AND CONSTRUCTION
 DIMENSIONS ARE APPROXIMATE UNLESS NOTED OTHERWISE TO MEET A SPECIFIC CUSTOMER NEED.

PENN CARE STOCK



CURBSIDE INTERIOR VIEW
 CHIEF XL-I

1:20

DATE:	6-10-25
DWG.:	TKD
REV.:	A

DRAWING NO.	CPQ #11265
	STOCK-6

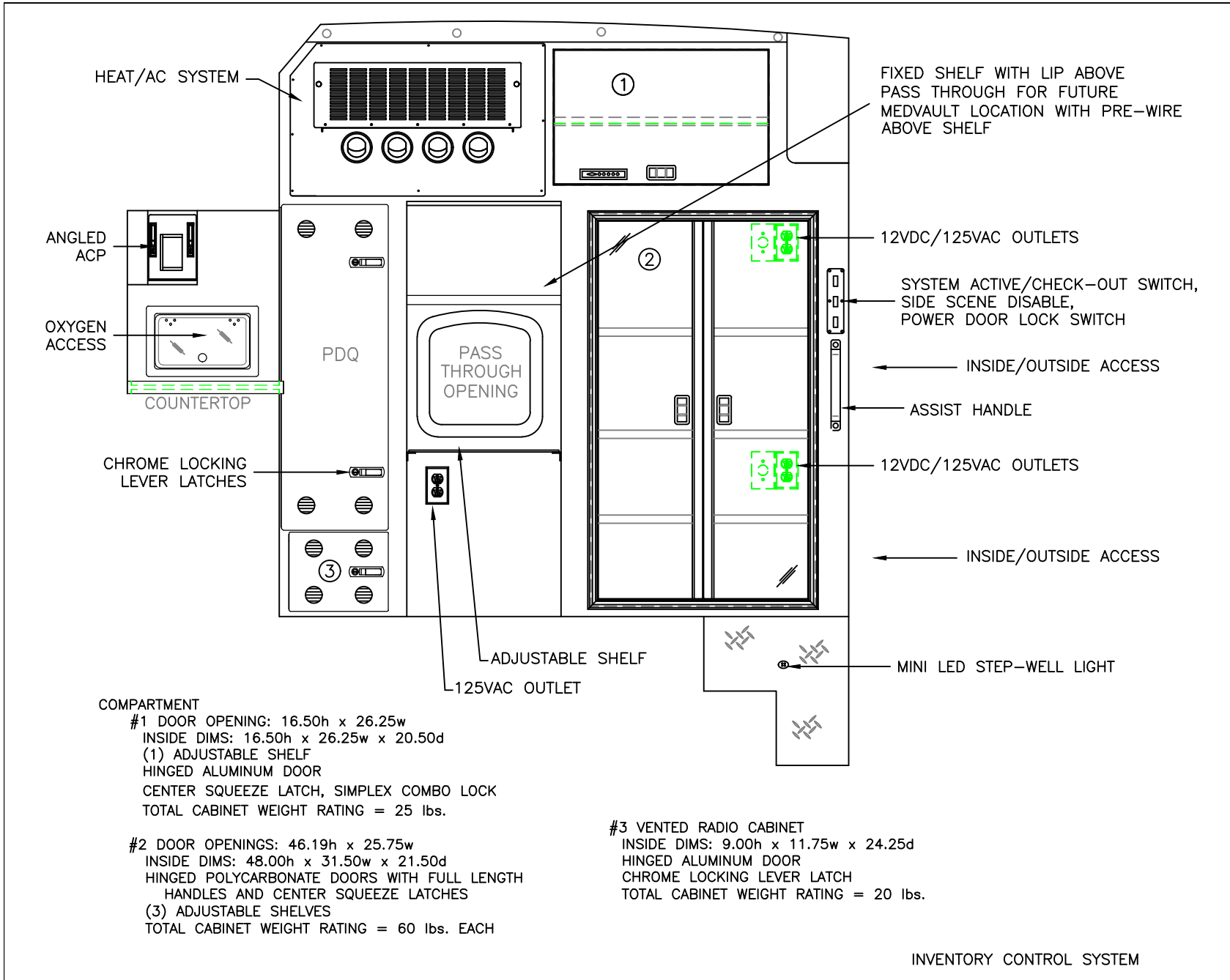

COMPARTMENT

#1 DOOR OPENING: 16.50h x 26.25w
 INSIDE DIMS: 16.50h x 26.25w x 20.50d
 (1) ADJUSTABLE SHELF
 HINGED ALUMINUM DOOR
 CENTER SQUEEZE LATCH, SIMPLEX COMBO LOCK
 TOTAL CABINET WEIGHT RATING = 25 lbs.

#2 DOOR OPENINGS: 46.19h x 25.75w
 INSIDE DIMS: 48.00h x 31.50w x 21.50d
 HINGED POLYCARBONATE DOORS WITH FULL LENGTH
 HANDLES AND CENTER SQUEEZE LATCHES
 (3) ADJUSTABLE SHELVES
 TOTAL CABINET WEIGHT RATING = 60 lbs. EACH

#3 VENTED RADIO CABINET
 INSIDE DIMS: 9.00h x 11.75w x 24.25d
 HINGED ALUMINUM DOOR
 CHROME LOCKING LEVER LATCH
 TOTAL CABINET WEIGHT RATING = 20 lbs.

INVENTORY CONTROL SYSTEM

THIS DRAWING IS FOR REPRESENTATIONAL PURPOSES ONLY. DETAILS ARE CONCEPTUAL AND ARE SUBJECT TO CHANGE DURING DESIGN AND CONSTRUCTION
 DIMENSIONS ARE APPROXIMATE UNLESS NOTED OTHERWISE TO MEET A SPECIFIC CUSTOMER NEED.

END VIEW OF BENCH AREA
PAST THE SEAT

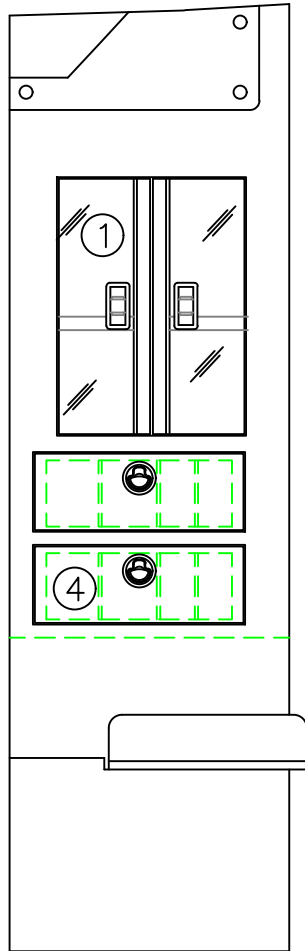

SEE DRAWING #6 FOR DRAWER
DIMENSIONS

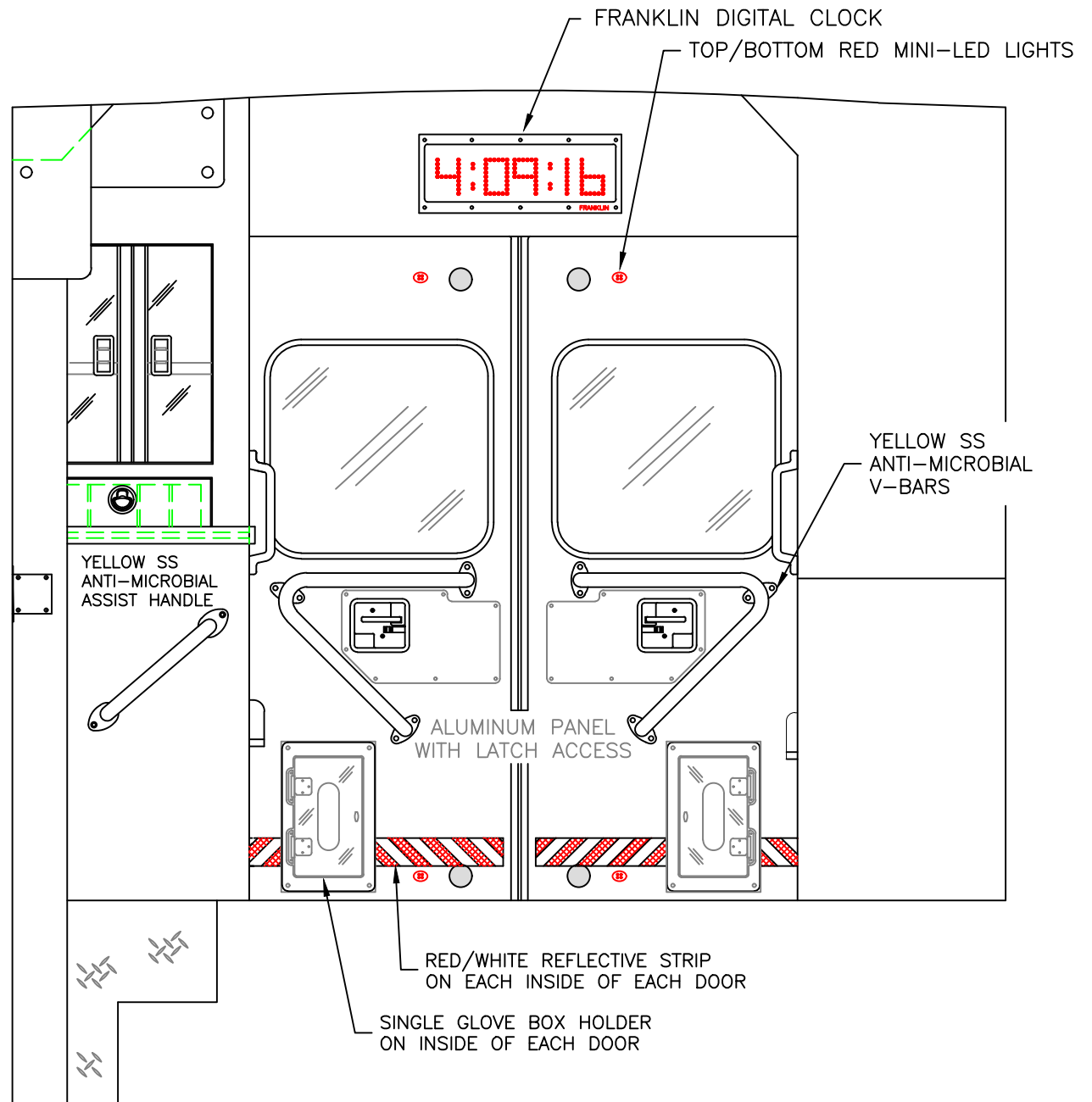

THIS DRAWING IS FOR REPRESENTATIONAL PURPOSES ONLY. DETAILS ARE CONCEPTUAL AND ARE SUBJECT TO CHANGE DURING DESIGN AND CONSTRUCTION
DIMENSIONS ARE APPROXIMATE UNLESS NOTED OTHERWISE TO MEET A SPECIFIC CUSTOMER NEED.

PENN CARE STOCK



REAR INTERIOR VIEW
CHIEF XL-1

DATE:
6-10-25
DWG. TKD
REV. A

DRAWING NO.
CPQ#11265
STOCK-8

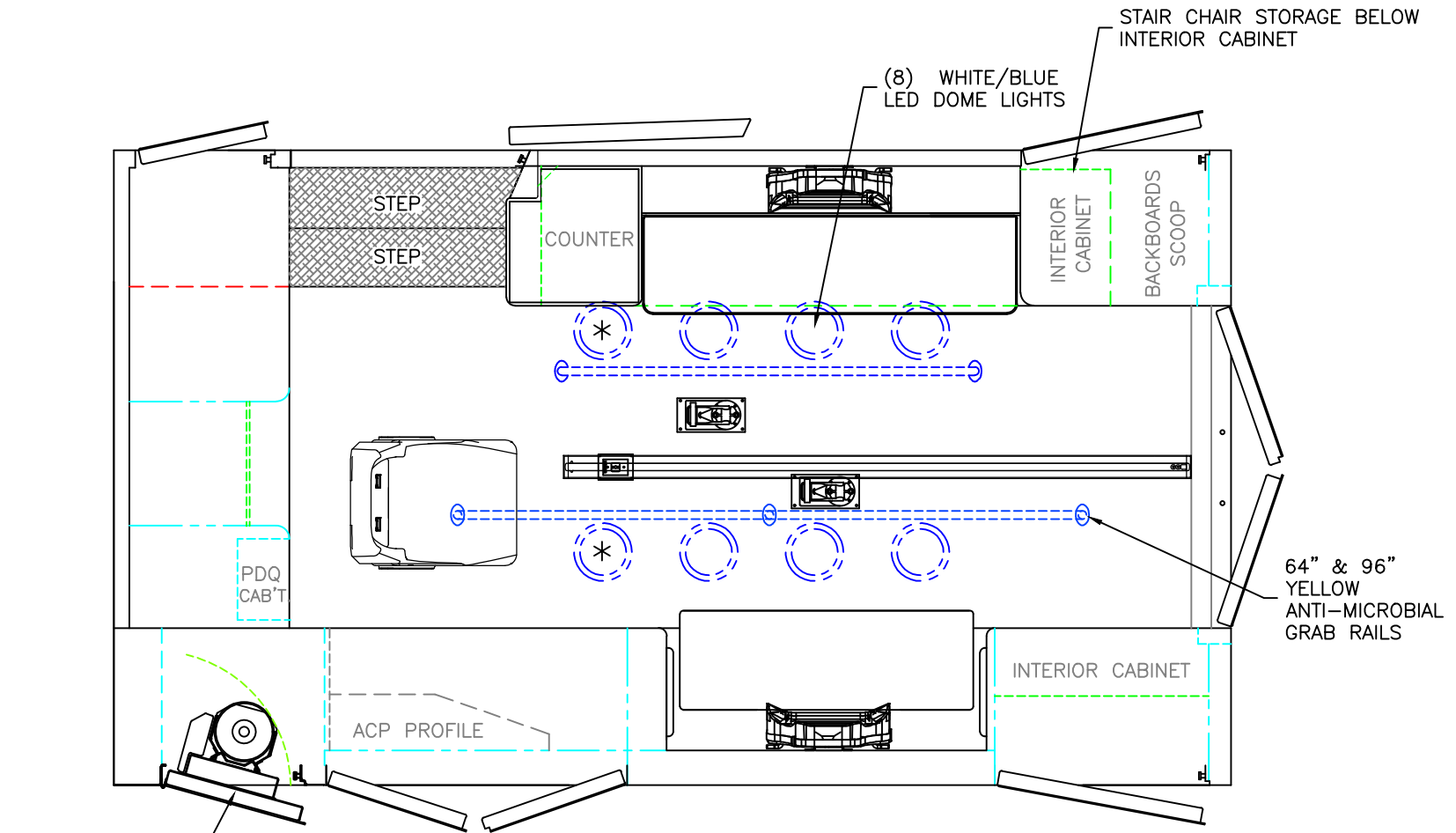

"EZ O2 LIFT"
OXYGEN SYSTEM

 = (2) RECESSED CEILING IV HANGER LOCATIONS

 = (1) CEILING OXYGEN OUTLET

* (2) ANTENNA BASES LOCATED OUTBOARD OF DOME LIGHTS WITH COAX SERVICE LOOP

STRYKER FLOOR PLATE AND PRE-WIRE CENTER MOUNT

MODULE WIDTH = 96"
MODULE LENGTH = 169"
MODULE HEAD ROOM = 72"

THIS DRAWING IS FOR REPRESENTATIONAL PURPOSES ONLY. DETAILS ARE CONCEPTUAL AND ARE SUBJECT TO CHANGE DURING DESIGN AND CONSTRUCTION DIMENSIONS ARE APPROXIMATE UNLESS NOTED OTHERWISE TO MEET A SPECIFIC CUSTOMER NEED.

PENN CARE STOCK



FLOOR INTERIOR VIEW
CHIEF XL-I

1:22

DATE:	6-10-25	DRAWING NO.	CPQ#11265
DWG.	TKD	REV.	A
			STOCK-9