

DIMENSIONS ARE APPROXIMATE  
 OVERALL HEIGHT = 112"  
 OVERALL WIDTH WITH RUB  
 RAILS & FENDERETTES = 98"

(7) WHELEN 900 SUPER LED WARNING LIGHTS  
 RED/RED/RED/WHITE/RED/RED/RED  
 WITH CLEAR LENSES

(5) AMBER  
 MINI-LED MARKER LIGHTS

OEM POWER  
 ADJUSTABLE  
 MIRRORS

FLASHING HEADLIGHTS W/  
 DAYTIME RUNNING LIGHTS

(2) 100W SIREN  
 SPEAKERS IN THE BUMPER

(2) WHELEN ION SERIES  
 RED SUPER LED GRILLE  
 LIGHTS WITH CLEAR LENSES

HIDDEN UNLOCK SWITCH  
 IN GRILLE AREA

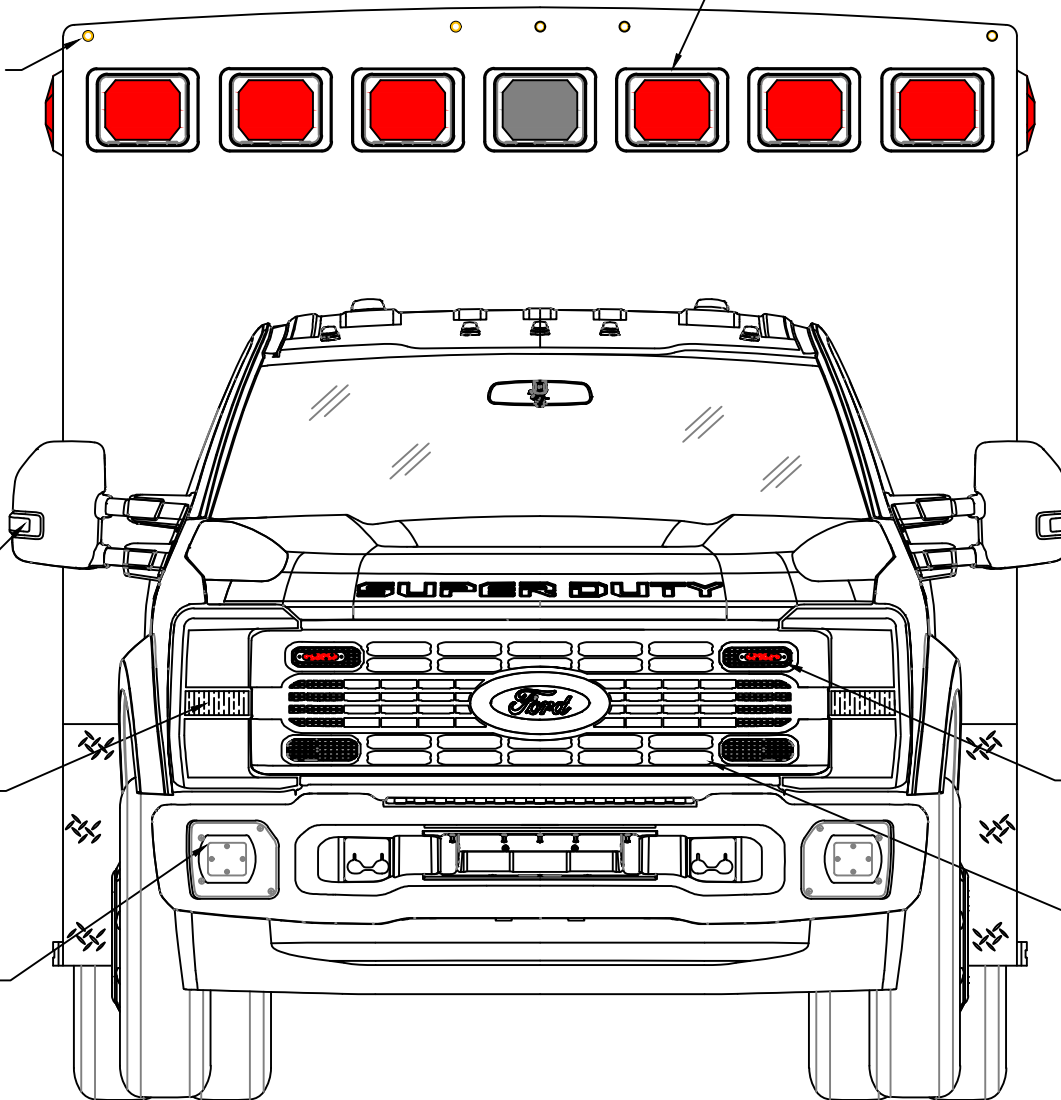

THIS DRAWING IS FOR REPRESENTATIONAL PURPOSES ONLY. DETAILS ARE CONCEPTUAL AND ARE SUBJECT TO CHANGE DURING DESIGN AND CONSTRUCTION  
 DIMENSIONS ARE APPROXIMATE UNLESS NOTED OTHERWISE TO MEET A SPECIFIC CUSTOMER NEED.

MODEL YEAR 2025



FRONT EXTERIOR VIEW  
 CHIEF XL-I/F450-F550 CHASSIS

DATE: 2-22-24  
 DWG. TKD REV.  
 DATE:

DRAWING NO.  
 CHIEFXL-1

APPROVAL SIGNATURE:

DIMENSIONS ARE APPROXIMATE  
OVERALL HEIGHT = 112"  
OVERALL WIDTH WITH RUB  
RAILS & FENDERETTES = 98"

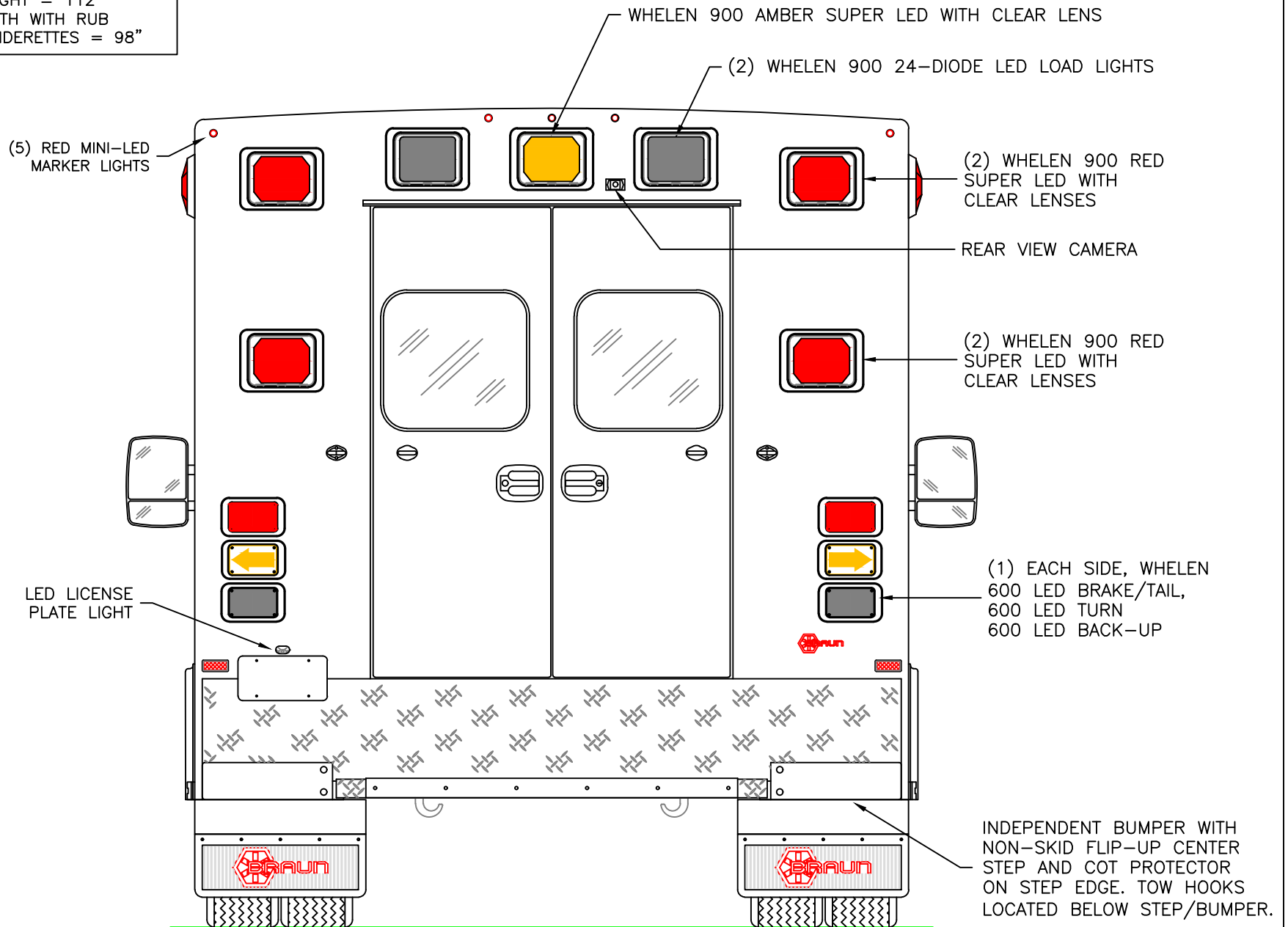

THIS DRAWING IS FOR REPRESENTATIONAL PURPOSES ONLY. DETAILS ARE CONCEPTUAL AND ARE SUBJECT TO CHANGE DURING DESIGN AND CONSTRUCTION  
DIMENSIONS ARE APPROXIMATE UNLESS NOTED OTHERWISE TO MEET A SPECIFIC CUSTOMER NEED.

MODEL YEAR 2025



REAR EXTERIOR VIEW  
CHIEF XL-1/F450-F550 CHASSIS

1:16

DATE: 2-22-24  
DWG. TKD  
REV. NR

DRAWING NO. CHIEFXL-2

DIMENSIONS ARE APPROXIMATE  
 OVERALL HEIGHT = 112"  
 OVERALL LENGTH = 307"  
 MODULE LENGTH = 169"

NOTE: DEF FILL REMOVED IF  
 GAS CHASSIS IS QUOTED.

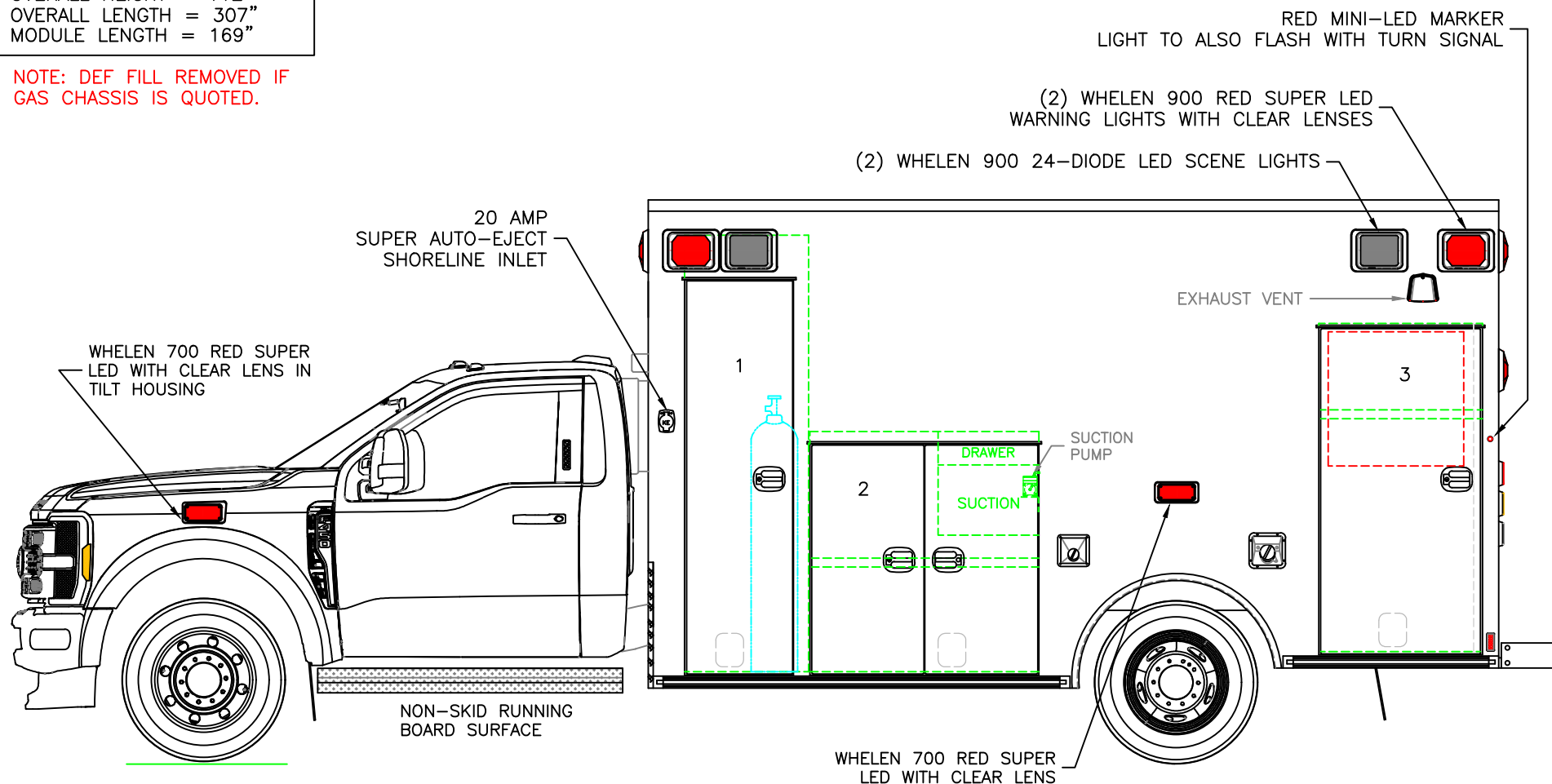

#### COMPARTMENT

##### O.S.S #1

CLEAR OPENING: 77.00h x 18.25w  
 INSIDE DIM'S.: 86.75h x 24.50w x 20.75d  
 MAIN OXYGEN STORAGE

##### O.S.S #2

CLEAR OPENING: 44.25h x 39.50w  
 INSIDE DIM'S.: 47.75h x 45.50w x 20.75d  
 (1) ADJUSTABLE SHELF

##### O.S.S #3

CLEAR OPENING: 63.50h x 28.75w  
 INSIDE DIM'S.: 65.25h x 32.50w x 20.75d  
 INSIDE/OUTSIDE ACCESS  
 (1) ADJUSTABLE SHELF

THIS DRAWING IS FOR REPRESENTATIONAL PURPOSES ONLY. DETAILS ARE CONCEPTUAL AND ARE SUBJECT TO CHANGE DURING DESIGN AND CONSTRUCTION  
 DIMENSIONS ARE APPROXIMATE UNLESS NOTED OTHERWISE TO MEET A SPECIFIC CUSTOMER NEED.

MODEL YEAR 2025



STREETSIDE EXTERIOR VIEW  
 CHIEF XL-I/F450-F550 CHASSIS

1:30

DATE:  
 2-22-24  
 DWG. TKD  
 REV. NR

DRAWING NO.  
 CHIEFXL-3

DIMENSIONS ARE APPROXIMATE  
 OVERALL HEIGHT = 112"  
 OVERALL LENGTH = 307"  
 MODULE LENGTH = 169"

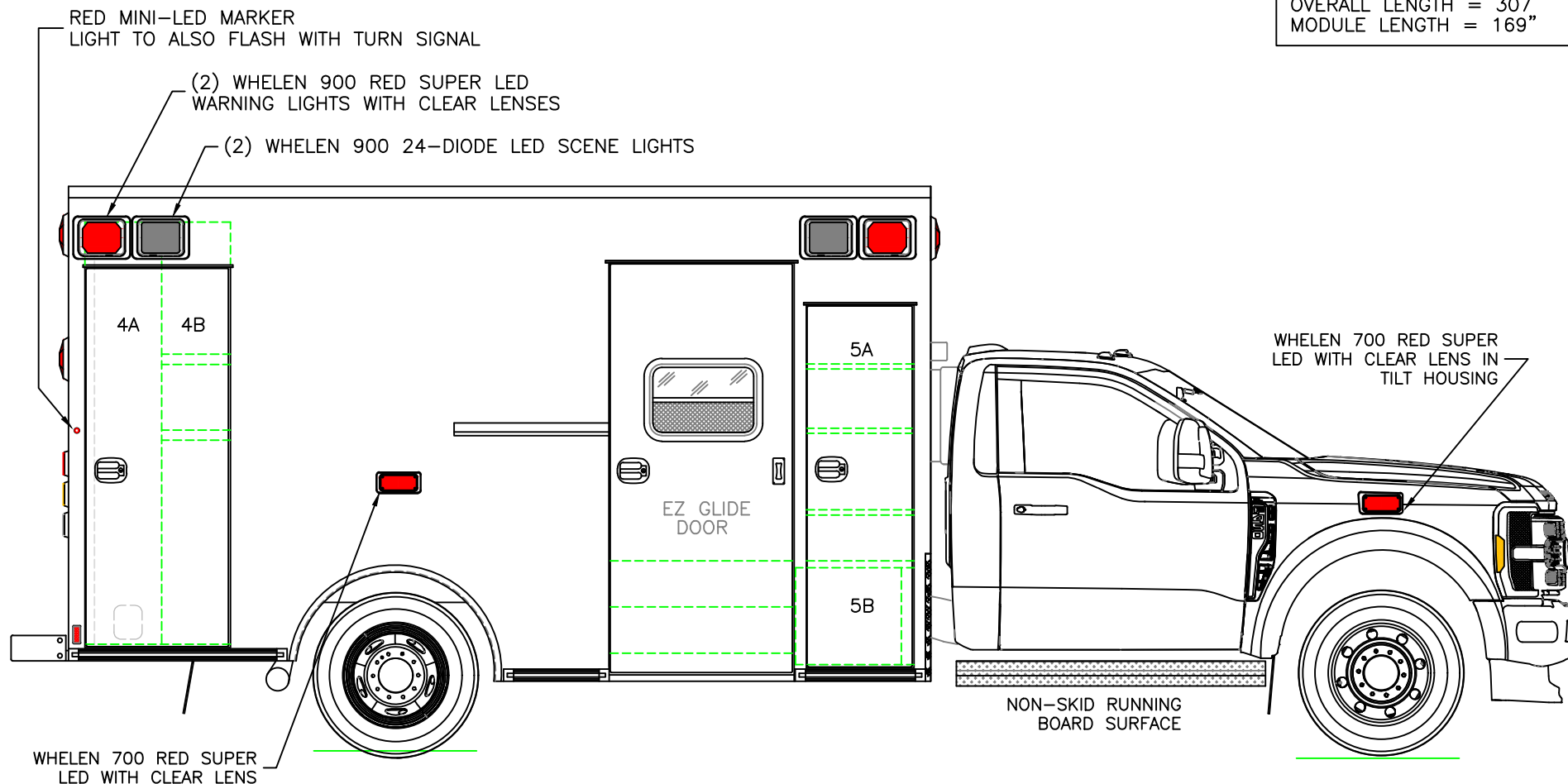

COMPARTMENT  
 O.S.S #4

CLEAR OPENING: 73.00h x 24.75w  
 INSIDE DIM'S. 4A: 82.75h x 15.00w x 20.75d  
 BACKBOARD/SCOOP STORAGE  
 INSIDE DIM'S. 4B: 82.75h x 13.50w x 20.75d  
 (2) ADJUSTABLE SHELVES WITH INSIDE/OUTSIDE ACCESS

O.S.S #5

CLEAR OPENING: 69.50h x 17.50w  
 INSIDE DIM'S. 5A: SEE PARTITION INTERIOR VIEW  
 INSIDE/OUTSIDE STORAGE WITH (3) ADJUSTABLE SHELVES  
 INSIDE DIM'S. 5B: 19.00h x 20.75w x 18.00d

THIS DRAWING IS FOR REPRESENTATIONAL PURPOSES ONLY. DETAILS ARE CONCEPTUAL AND ARE SUBJECT TO CHANGE DURING DESIGN AND CONSTRUCTION  
 DIMENSIONS ARE APPROXIMATE UNLESS NOTED OTHERWISE TO MEET A SPECIFIC CUSTOMER NEED.

MODEL YEAR 2025



CURBSIDE EXTERIOR VIEW  
 CHIEF XL-I/F450-F550 CHASSIS

1:30

DATE:  
 2-22-24  
 DWG. TKD  
 REV. NR

DRAWING NO.  
 CHIEFXL-4

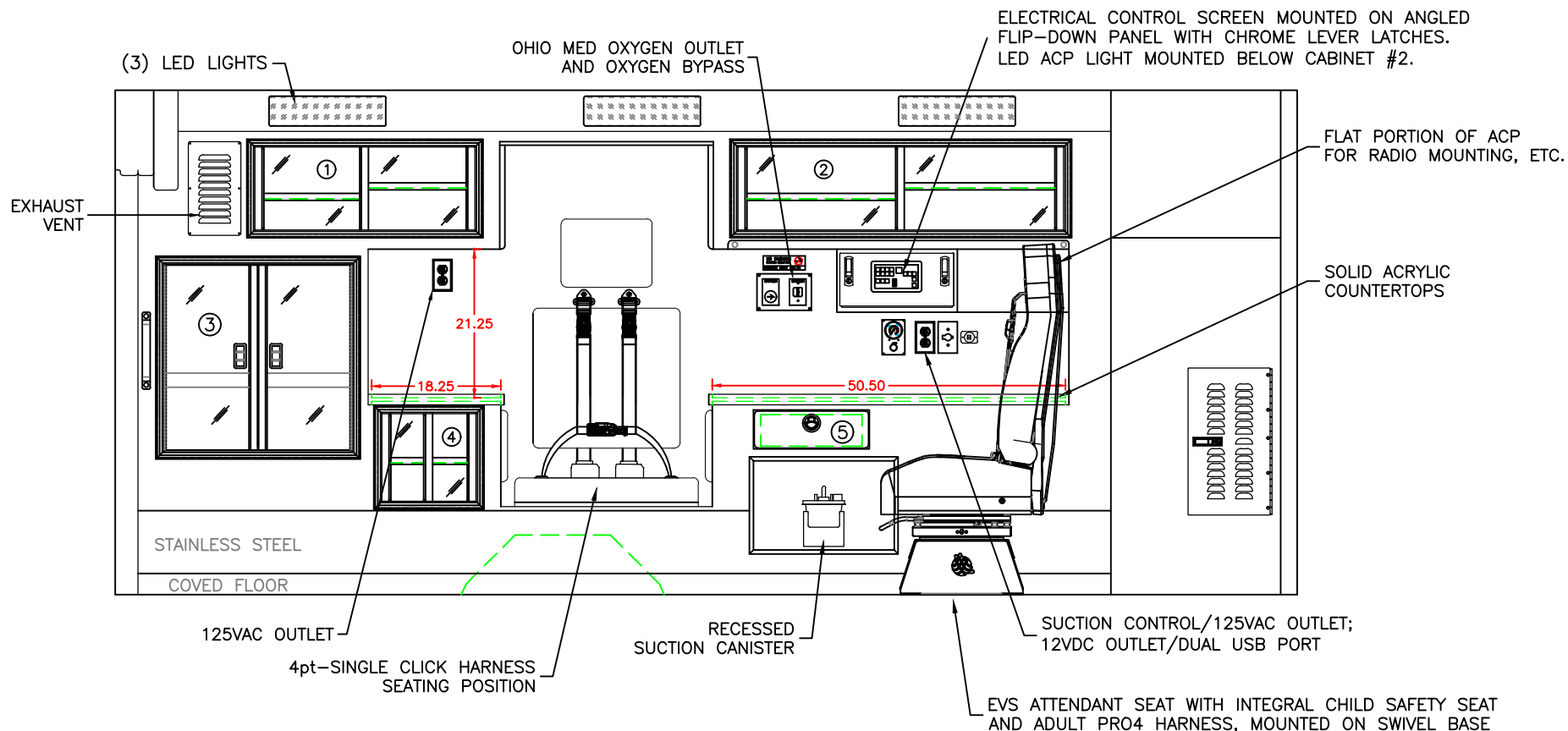

#### COMPARTMENT

#1 DOOR OPENING: 11.75h x 31.50w

INSIDE DIMS: 13.25h x 33.00w x 17.25d

(1) ADJ SHELF EACH SIDE OF CENTER DIVIDER

SLIDING POLYCARBONATE DOORS

TOTAL CABINET WEIGHT RATING = 25 lbs.

#2 DOOR OPENING: 11.75h x 46.50w

INSIDE DIMS: 13.25h x 48.00w x 17.25d

(1) ADJ SHELF EACH SIDE OF CENTER DIVIDER

SLIDING POLYCARBONATE DOORS

TOTAL CABINET WEIGHT RATING = 25 lbs.

#3 DOOR OPENING: 26.50h x 26.75w

INSIDE DIMS: O.S.S. #3

HINGED POLYCARBONATE DOORS WITH FULL LENGTH

HANDLES AND CENTER SQUEEZE LATCHES

TOTAL CABINET WEIGHT RATING = 40 lbs.

#4 DOOR OPENING: 12.50h x 13.50w

INSIDE DIMS: 14.00h x 15.00w x 17.25d

(1) ADJUSTABLE SHELF

SLIDING POLYCARBONATE DOORS

TOTAL CABINET WEIGHT RATING = 15 lbs.

#5 PULL-OUT DRAWER WITH HINGED ACRYLIC WRITING SURFACE

INSIDE DIMS: 4.50h x 14.50w x 13.25d

LOCKING STAINLESS STEEL FLUSH PULL LATCH

TOTAL DRAWER WEIGHT RATING = 10 lbs.

THIS DRAWING IS FOR REPRESENTATIONAL PURPOSES ONLY. DETAILS ARE CONCEPTUAL AND ARE SUBJECT TO CHANGE DURING DESIGN AND CONSTRUCTION  
DIMENSIONS ARE APPROXIMATE UNLESS NOTED OTHERWISE TO MEET A SPECIFIC CUSTOMER NEED.

MODEL YEAR 2025



STREETSIDE INTERIOR VIEW

CHIEF XL-I

1:22

DATE:  
3-11-24  
DWG. TKD  
REV. NR

DRAWING NO.

CHIEFXL-5

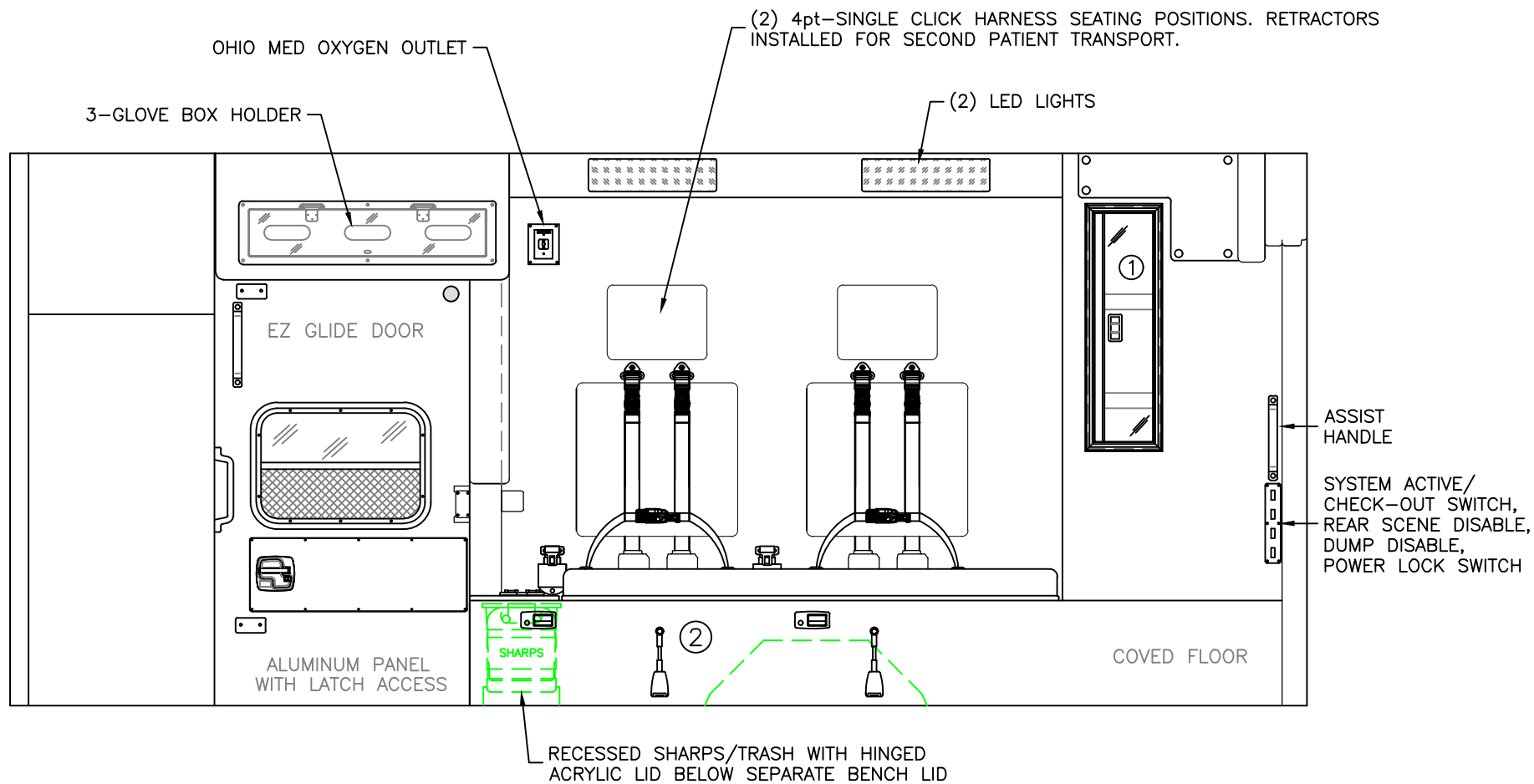

#### COMPARTMENT

#1 DOOR OPENING: 30.00h x 7.25w  
 INSIDE/OUTSIDE ACCESS TO OSS #4B  
 HINGED POLYCARBONATE DOOR WITH FULL LENGTH  
 HANDLE AND CENTER SQUEEZE LATCH  
 TOTAL CABINET WEIGHT RATING = 25 lbs.

#2 INSIDE DIM'S: 14.25h x 77.00w x 21.00d

THIS DRAWING IS FOR REPRESENTATIONAL PURPOSES ONLY. DETAILS ARE CONCEPTUAL AND ARE SUBJECT TO CHANGE DURING DESIGN AND CONSTRUCTION  
 DIMENSIONS ARE APPROXIMATE UNLESS NOTED OTHERWISE TO MEET A SPECIFIC CUSTOMER NEED.

MODEL YEAR 2025



CURBSIDE INTERIOR VIEW  
 CHIEF XL-I

1:20

DATE:	3-11-24
DWG.	TKD
REV.	NR

DRAWING NO.
CHIEFXL-6

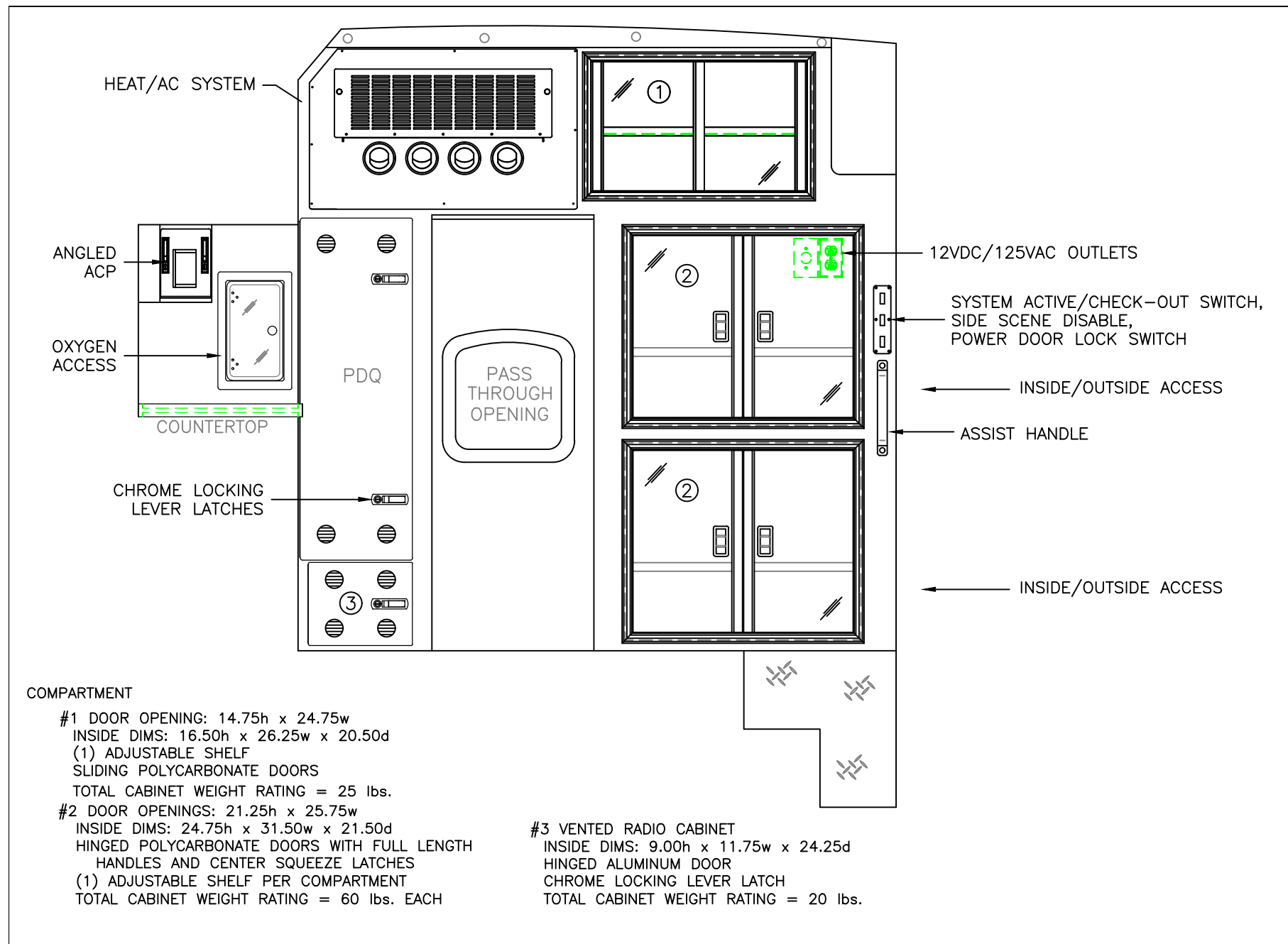

THIS DRAWING IS FOR REPRESENTATIONAL PURPOSES ONLY. DETAILS ARE CONCEPTUAL AND ARE SUBJECT TO CHANGE DURING DESIGN AND CONSTRUCTION  
 DIMENSIONS ARE APPROXIMATE UNLESS NOTED OTHERWISE TO MEET A SPECIFIC CUSTOMER NEED.

MODEL YEAR 2025



PARTITION INTERIOR VIEW  
 CHIEF XL-1

DATE:  
 2-22-24  
 DWG. TKD  
 REV. NR

DRAWING NO.  
 CHIEFXL-7

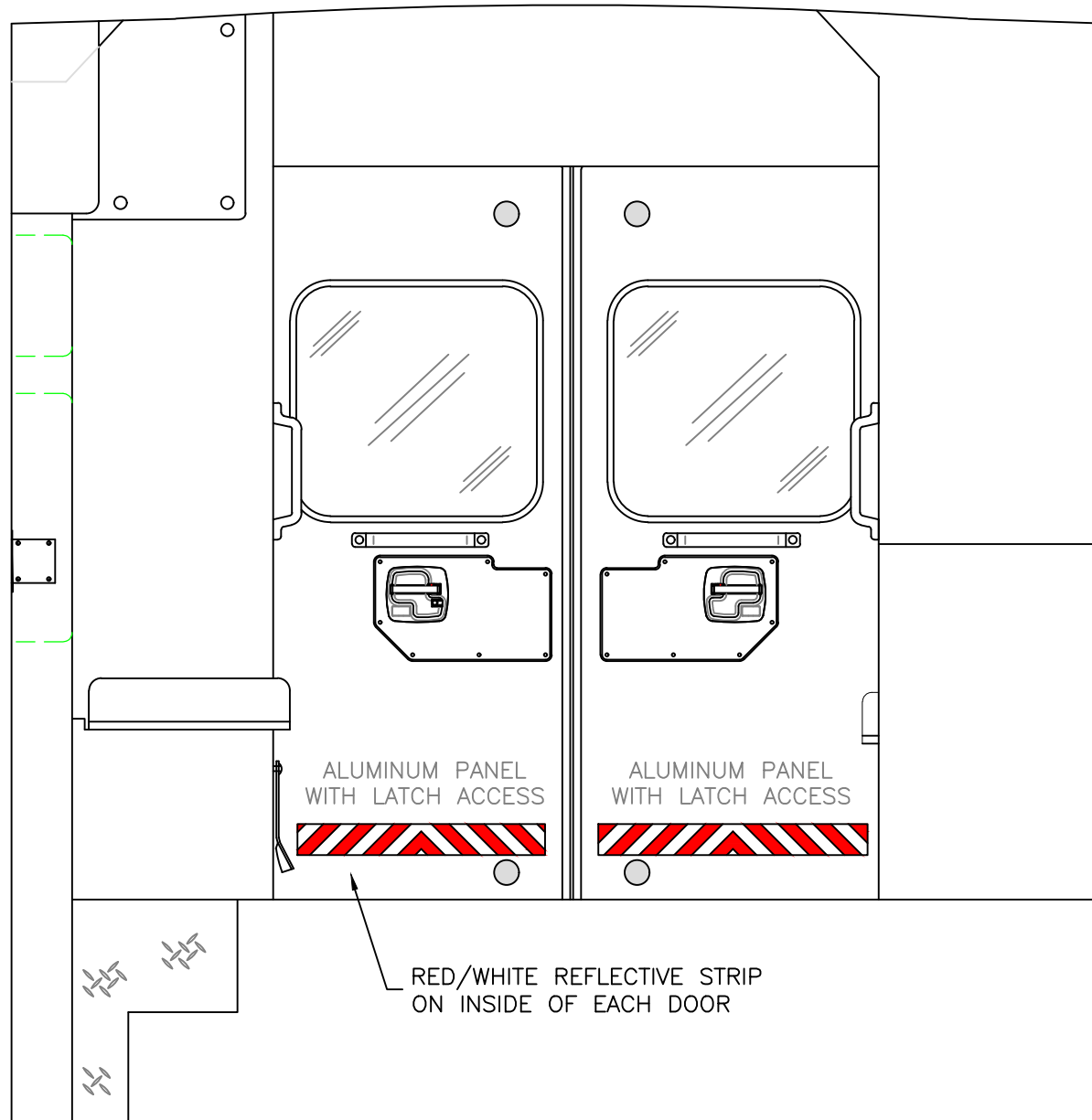

THIS DRAWING IS FOR REPRESENTATIONAL PURPOSES ONLY. DETAILS ARE CONCEPTUAL AND ARE SUBJECT TO CHANGE DURING DESIGN AND CONSTRUCTION  
 DIMENSIONS ARE APPROXIMATE UNLESS NOTED OTHERWISE TO MEET A SPECIFIC CUSTOMER NEED.

MODEL YEAR 2025



REAR INTERIOR VIEW  
 CHIEF XL-1

1:12

DATE:	3-11-24
DWG.	REV.
TKD	NR

DRAWING NO.
CHIEFXL-8



RECESSED SHARPS/TRASH WITH HINGED  
ACRYLIC LID BELOW SEPARATE BENCH LID

(8) LED  
DOME LIGHTS

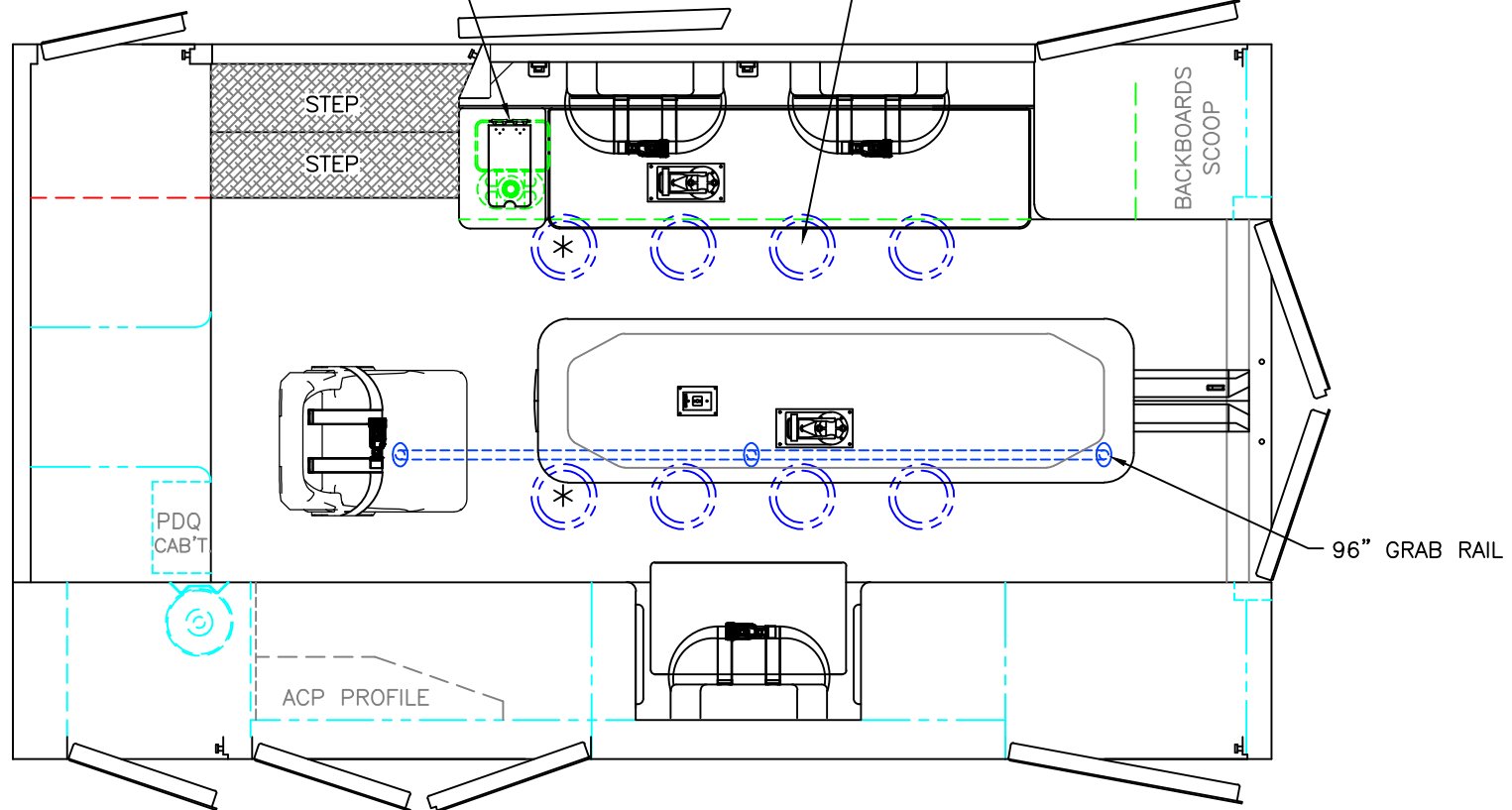

= (2) RECESSED CEILING IV HANGER LOCATIONS

= (1) CEILING OXYGEN OUTLET

\* (2) ANTENNA BASES LOCATED OUTBOARD OF  
DOME LIGHTS WITH COAX SERVICE LOOP

96" FERNO STAT-TRAC CENTER MOUNT COT HARDWARE

MODULE WIDTH = 96"  
MODULE LENGTH = 169"  
MODULE HEAD ROOM = 72"

THIS DRAWING IS FOR REPRESENTATIONAL PURPOSES ONLY. DETAILS ARE CONCEPTUAL AND ARE SUBJECT TO CHANGE DURING DESIGN AND CONSTRUCTION  
DIMENSIONS ARE APPROXIMATE UNLESS NOTED OTHERWISE TO MEET A SPECIFIC CUSTOMER NEED.

MODEL YEAR 2025



FLOOR INTERIOR VIEW  
CHIEF XL-I

1:22

DATE:  
3-11-24  
DWG. TKD  
REV. NR

DRAWING NO.

CHIEFXL-9