

OVERALL HEIGHT = 112"
 OVERALL WIDTH WITH RUB
 RAILS & FENDERETTES = 98"

WHELEN 700 WHITE LED
 WITH CLEAR LENS

CODE 3 758A2 LIGHT BAR,
 RED UPPER LENS/CLEAR LOWER LENS
 MOUNTED ON FORWARD ROOF AREA

(2) WHELEN 900
 RED LED
 WITH CLEAR LENS

CODE 3 (758a2)
 (4) RED ROTATORS
 (2) CLEAR SWEEPS
 (4) RED LEDS ON LOWER

(2) WHELEN 600 AMBER
 LED TURN ARROWS

OEM POWER/ HEATED
 MIRRORS

GROVER
 AIR HORNS

OEM LIGHTED
 BUMPER POLES

CPI COMBINATION LIGHT
 HOUSINGS LH37732/37733
 GRILLE LIGHTS TO BE WHELEN
 700 RED/WHITE SUPER LED
 WITH CLEAR LENS

FLASHING HEADLIGHTS W/
 DAYTIME RUNNING LIGHTS

(2) CAST PRODUCTS
 SIREN SPEAKERS
 RECESSED INTO BUMPER

OVAL NEON FOG LIGHTS

RECESSED TOW HOOKS

DIMENSIONS ARE NOMINAL



NORTHWEST
 AMBULANCE DISTRICT

2010 FRONT EXTERIOR VIEW
 SUPER CHIEF-1/4300LP CHASSIS

1:18

DATE:	11 AUG 10	
DWG.	MJF	REV. A

DRAWING NO.	NWA-1
-------------	-------

OVERALL HEIGHT = 112"
 OVERALL WIDTH WITH RUB
 RAILS & FENDERETTES = 98"
 LOAD HEIGHT = 31.5"
 DIMENSIONS ARE NOMINAL

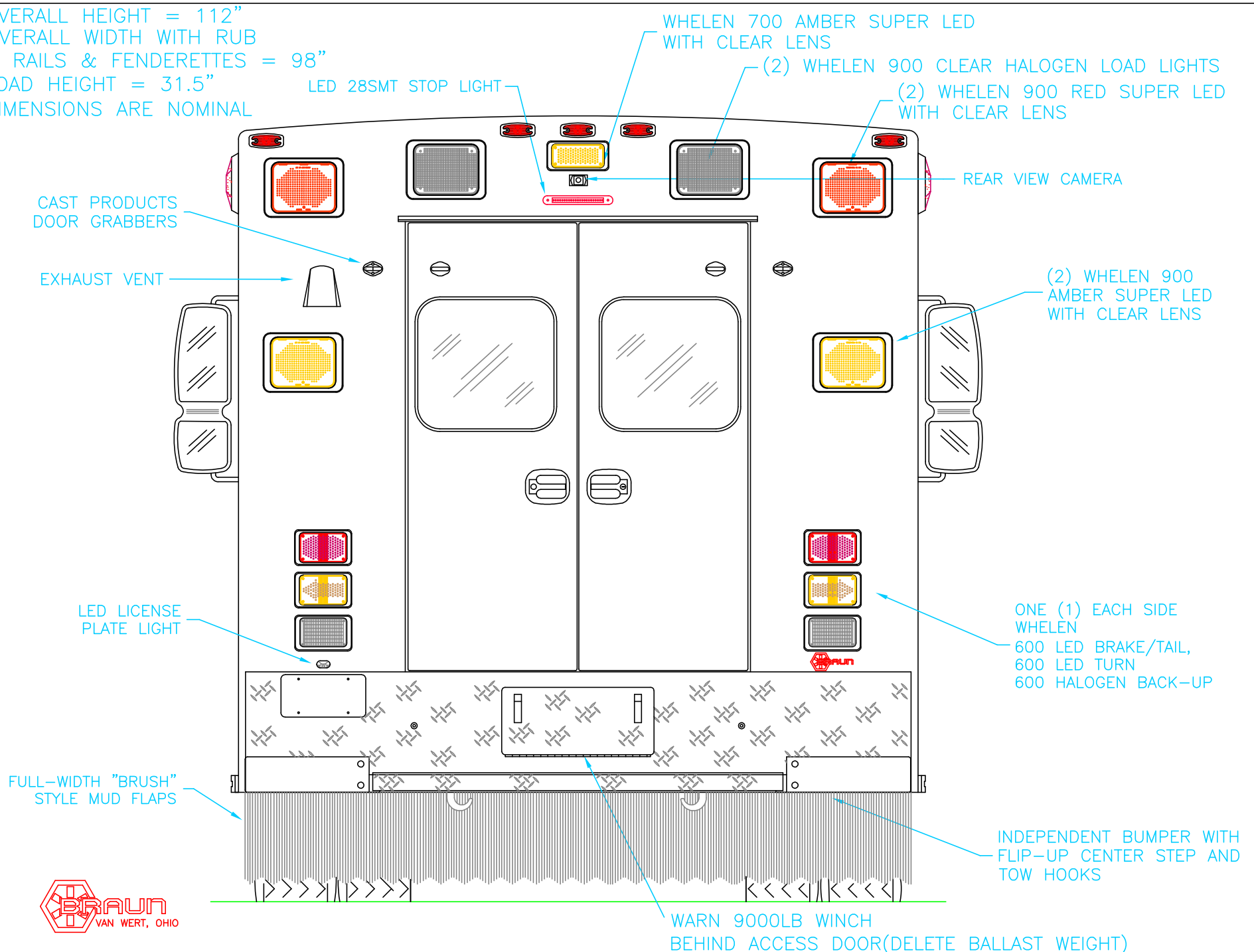

NORTHWEST
 AMBULANCE DISTRICT

2010 REAR EXTERIOR VIEW
 SUPER CHIEF-I/4300LP CHASSIS

1:18

DATE:	22 JULY 10	
DWG.	MJF	REV. NR

DRAWING NO.	NWA-2
-------------	-------

OVERALL HEIGHT = 112" (EXCLUDING EXHAUST)
 OVERALL LENGTH = 317.5"
 MODULE LENGTH = 170"

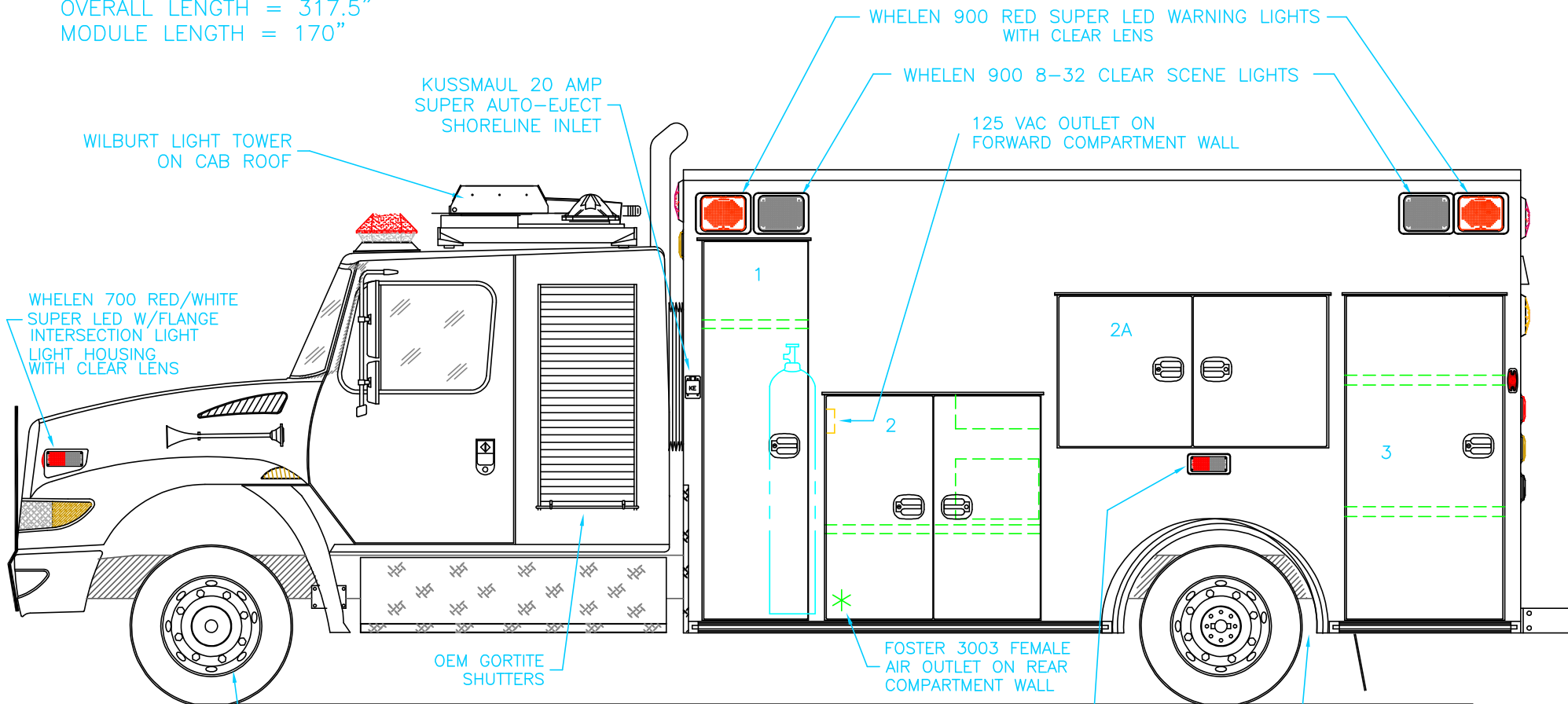

ALUMINUM WHEELS WITH HUB AND NUT COVERS

COMPARTMENT
 O.S.S #1
 CLEAR OPENING: 75.50h x 17.75w
 INSIDE DIM'S.: 76.50h x 21.75w x 21.75d
 OXYGEN STORAGE
 ONE (1) ADJUSTABLE SHELF ABOVE OXYGEN
 O.S.S #2
 CLEAR OPENING: 44.25h x 38.25w
 INSIDE DIM'S.: 47.50h x 43.75w x 21.75d
 ONE (1) ADJUSTABLE SHELF

O.S.S #2A
 CLEAR OPENING: 29.00h x 50.00w
 INSIDE DIM'S.: 31.75h x 55.00w x 21.75d
 O.S.S #3
 CLEAR OPENING: 63.50h x 29.50w
 INSIDE DIM'S.: 65.25h x 32.75w x 21.75d
 INSIDE/OUTSIDE ACCESS
 TWO (2) ADJUSTABLE SHELVES

DIMENSIONS ARE NOMINAL



NORTHWEST
 AMBULANCE DISTRICT

2010 STREETSIDE EXTERIOR VIEW
 SUPER CHIEF-I/4300LP EXTENDED CAB

1:30

DATE:	11 AUG 10	
DWG.:	MJF	REV
		A

DRAWING NO.
 NWA-3

OVERALL HEIGHT = 112"
 OVERALL LENGTH = 317.5"
 MODULE LENGTH = 170"

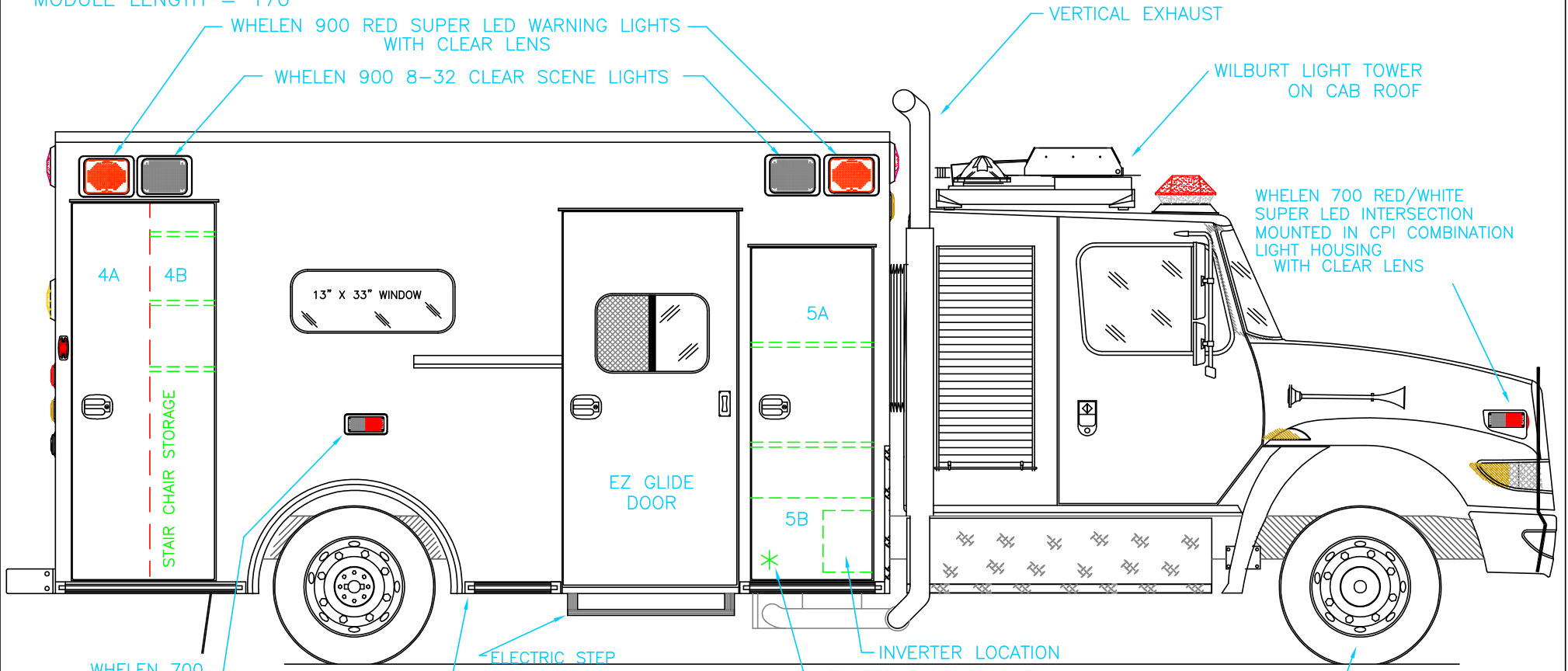

COMPARTMENT
 O.S.S #4
 CLEAR OPENING: 75.50h x 25.25w
 INSIDE DIM'S. 4A: 76.50h x 16.00w x 21.75d
 BACKBOARD/SCOOP STORAGE

INSIDE DIM'S. 4B: 76.50h x 15.50w x 21.75d
 (3) ADJUSTABLE SHELVES:
 -(2) UPPER SHELVES WITH LIPS TURNED DOWN
 -(1) LOWER SHELF WITH LIPS TURNED UP
 42" CLEARANCE BELOW LOWER SHELF FOR STAIR CHAIR

O.S.S #5
 CLEAR OPENING: 66.50h x 21.25w
 INSIDE DIM'S. 5A: 49.50h x 25.50w x 28.50d
 INSIDE/OUTSIDE STORAGE WITH TWO (2) ADJUSTABLE SHELVES

INSIDE DIM'S. 5B: 16.25h x 29.00w x 16.50d

DIMENSIONS ARE NOMINAL



NORTHWEST
 AMBULANCE DISTRICT

2010 CURBSIDE EXTERIOR VIEW
 SUPER CHIEF-I/4300LP EXTENDED CAB

DATE: 11 AUG 10		DRAWING NO. NWA-4
DWG. MJF	REV. A	

1:30

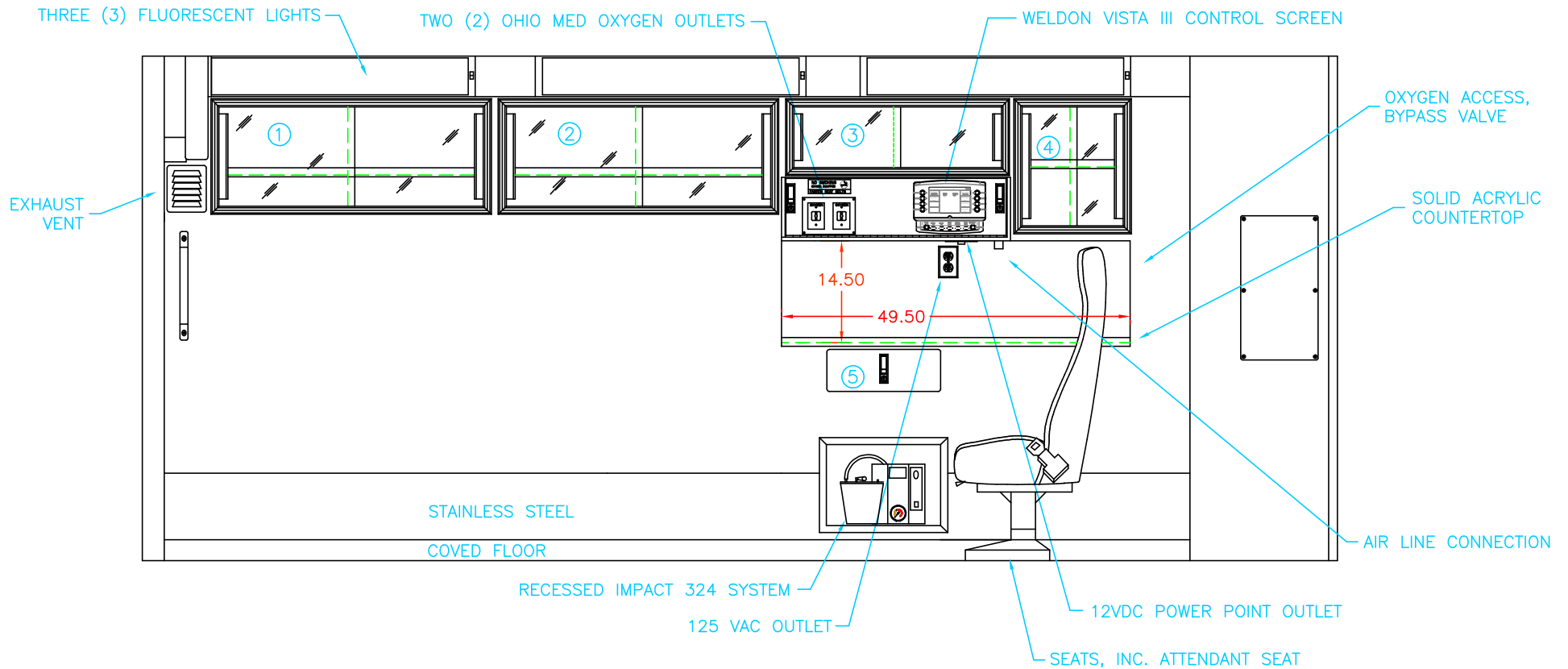

COMPARTMENT

#1,#2 DOOR OPENINGS: 14.25h x 37.50w
 INSIDE DIMS: 16.00h x 39.25w x 19.50d
 ONE (1) ADJUSTABLE SHELF IN EACH COMPARTMENT

#3 DOOR OPENING: 8.50h x 29.75w
 INSIDE DIMS: 10.25h x 31.50w x 19.50d

#4 DOOR OPENING: 17.25h x 14.50w
 INSIDE DIMS: 19.00h x 16.25w x 19.50d
 ONE (1) ADJUSTABLE SHELF

#5 PULL-OUT DRAWER WITH LOCKING LEVER LATCH
 INSIDE DIMS: 5.00h x 14.50w x 13.25d
 HINGED ACRYLIC WRITING SURFACE WITH HOLE IN LID
 AND DRAWER DIVIDER FOR INVENTORY CONTROL



DIMENSIONS ARE NOMINAL

NORTHWEST
 AMBULANCE DISTRICT

2010 STREETSIDE INTERIOR VIEW
 SUPER CHIEF-I

1:22

DATE:	22 JULY 10
DWG.	MJF
REV.	NR

DRAWING NO.	NWA-5
-------------	-------

RECESSED STORAGE FOR
(3) GLOVE BOXES

ONE (1) OHIO MED
OXYGEN OUTLET

EZ GLIDE DOOR

STAINLESS STEEL

1

2

3

ASSIST
HANDLE

SYSTEM ACTIVE/
CHECK-OUT
SWITCH

REAR SCENE
DISABLE

AIR RIDE
DISABLE

COVERED FLOOR UP TO
TOP OF SQUAD BENCH

COMPARTMENT

#1-#2 CABINET (DELETES FLUORESCENT LIGHTS)
DOOR OPENING: 7.00h x 57.00w
INSIDE DIMS: 8.75h x 58.75w x 10.25d
FIXED CENTER DIVIDER

#3 INSIDE DIM'S: 14.25h x 71.75w x 21.00d

DIMENSIONS ARE NOMINAL



NORTHWEST
AMBULANCE DISTRICT

2010 CURBSIDE INTERIOR VIEW
SUPER CHIEF-I

DATE: 22 JULY 10	DRAWING NO. NWA-6	
DWG. MJF	REV. NR	

1:20

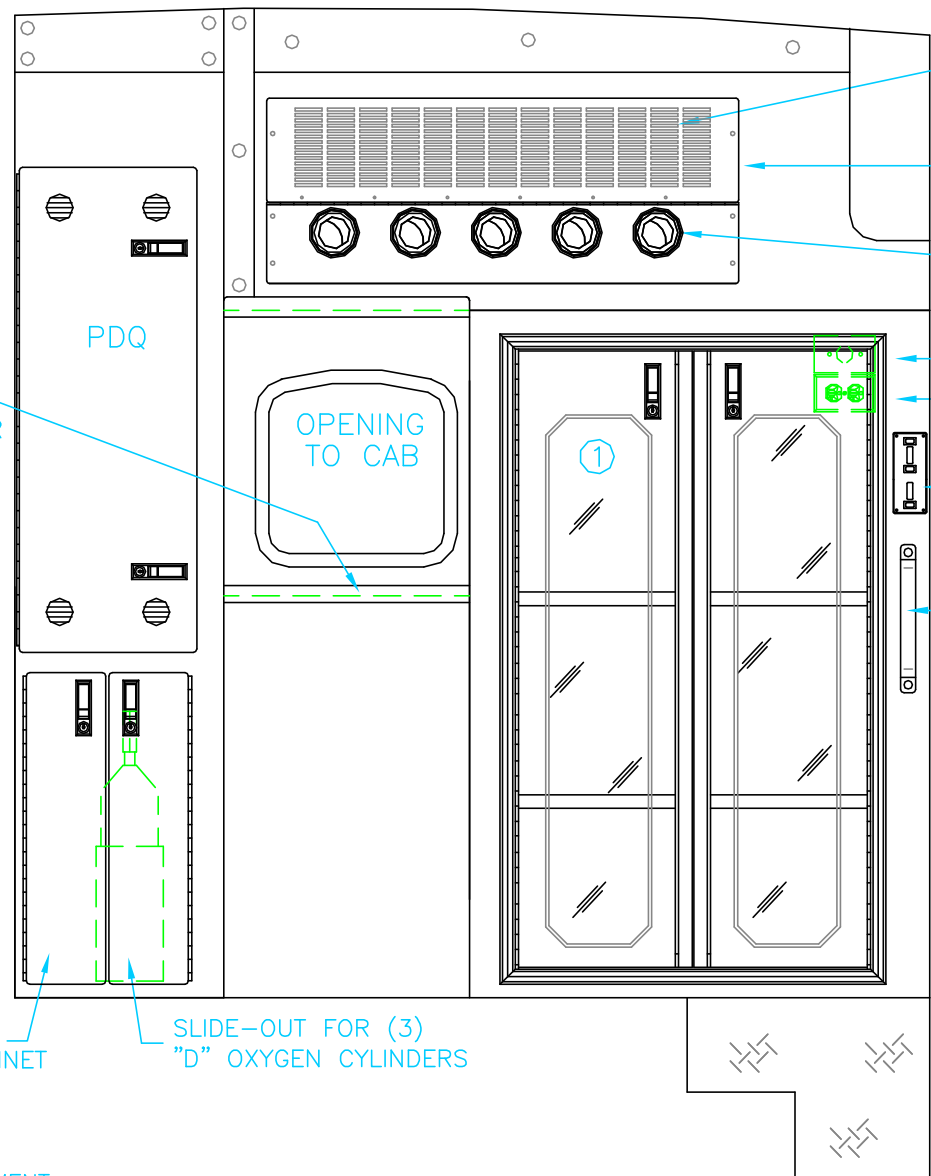

AIR INTAKE WITH SERVICE ACCESS

HOELINE FT-454
HIGH-OUTPUT HEAT/AC UNIT

OUTPUT VENTS

12VDC POWER POINT OUTLET

125 VAC OUTLET

SYSTEM ACTIVE/CHECK-OUT SWITCH,
SIDE SCENE DISABLE

ASSIST HANDLE

INSIDE/OUTSIDE
ACCESS

LAMINATED WRITING SHELF,
16" DEPTH; MOUNTED WITH
29" CLEARANCE FROM FLOOR

PDQ

OPENING
TO CAB

COMPARTMENT OPENING
MOVED TO FACE OF CABINET

SLIDE-OUT FOR (3)
"D" OXYGEN CYLINDERS

COMPARTMENT

#1 DOOR OPENING: 46.00h x 26.25w
INSIDE DIMS: 50.00h x 30.25w x 28.00d
RECESSED .375" ACRYLIC DOORS WITH FULL LENGTH HANDLES
TWO (2) LOCKING LEVER LATCHES
TWO (2) ADJUSTABLE SHELVES



DIMENSIONS ARE NOMINAL

NORTHWEST
AMBULANCE DISTRICT

2010 PARTITION INTERIOR VIEW
SUPER CHIEF-I

1:14

DATE:	22 JULY 10
DWG.	MJF
REV.	NR

DRAWING NO.
NWA-7

BATTERY POWERED CLOCK

RADIO SPEAKERS

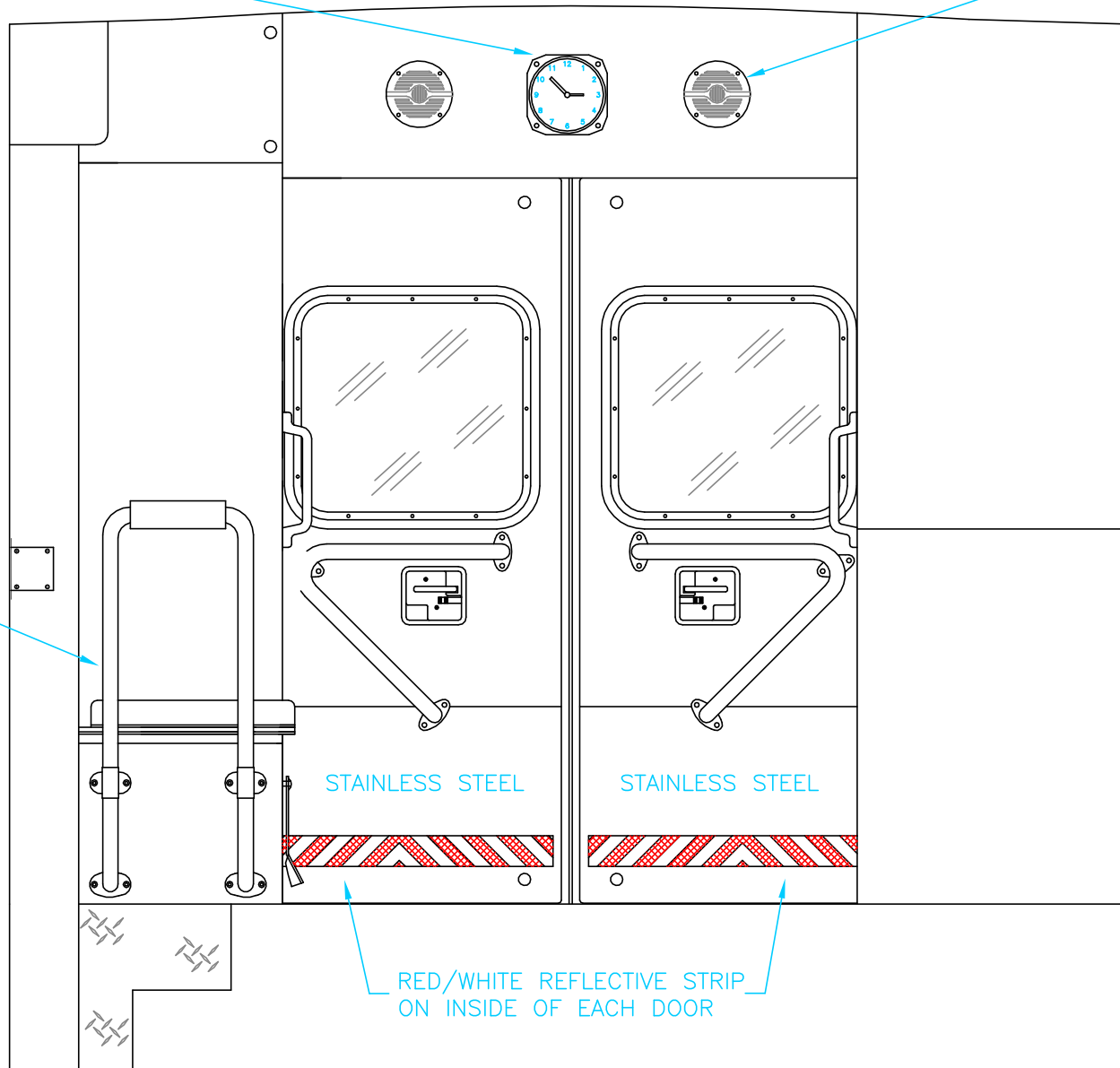

STAINLESS
STEEL A-BAR

STAINLESS STEEL

STAINLESS STEEL

RED/WHITE REFLECTIVE STRIP
ON INSIDE OF EACH DOOR



NORTHWEST
AMBULANCE DISTRICT

2010 REAR INTERIOR VIEW
SUPER CHIEF-1

1:14

DATE:	22 JULY 10
DWG.	MJF
REV.	NR

DRAWING NO.

NWA-8

ATTACHMENT POINTS
FOR FLOOR MOUNTED
BARIATRIC WINCH
CUSTOMER SUPPLIED WINCH
TO BE 21.50 INCHES CENTER TO CENTER

(3) ADJUSTABLE SHELVES
ABOVE STAIR CHAIR STORAGE

BACKBOARD/
SCOOP STORAGE

(10) HALOGEN
DOME LIGHTS

A-BAR

STEP

PDQ
CAB'T.

OXYGEN
STORAGE

* FOUR (4) ANTENNA BASES LOCATED OUTBOARD OF
DOME LIGHTS WITH COAX SERVICE LOOP

 TWO (2) RECESSED CEILING IV HANGER LOCATIONS
STRYKER SIDE/CENTER COT FASTENER

MODULE WIDTH = 96"

MODULE LENGTH = 170"

MODULE HEAD ROOM = 73.5"

DIMENSIONS ARE NOMINAL



NORTHWEST
AMBULANCE DISTRICT

2010 FLOOR INTERIOR VIEW
SUPER CHIEF-I

DATE:	22 JULY 10	
DWG.	MJF	REV.
		NR

DRAWING NO.

NWA-9

1:23